

DO NOT SCALE
 CONTRACTORS ARE RESPONSIBLE FOR SATISFYING THEMSELVES THAT THE DIMENSIONS AND DETAILS SHOWN ON THE DRAWINGS ARE CORRECT AND COMPLIANT WITH THE SPECIFICATION PRIOR TO MANUFACTURE. REPORT OMISSIONS AND ERRORS TO WINTTECH.

CONTRACTORS ARE TO ENSURE THAT ALL COMPONENTS FORMING PART OF THEIR WORKS ARE FABRICATED AND INSTALLED IN ACCORDANCE WITH THE MANUFACTURERS RECOMMENDATIONS.

ALL ELEVATIONS VIEWED FROM THE OUTSIDE UNLESS OTHERWISE STATED

DETAIL NUMBER	VENT / DOOR LEAF	HINGE
DETAIL DRAWING		

KEY PLAN

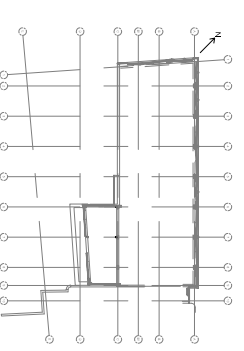

DRAWING BASED ON LATEST INFORMATION AVAILABLE. CONTRACTOR TO ALLOW FOR UPDATES TO DRAWINGS AND RE-SUBMISSION FOR CONSTRUCTION TO TAKE INTO ACCOUNT OF SURVEY BUILDING INFORMATION AND FINAL DESIGN/ENGINEERING

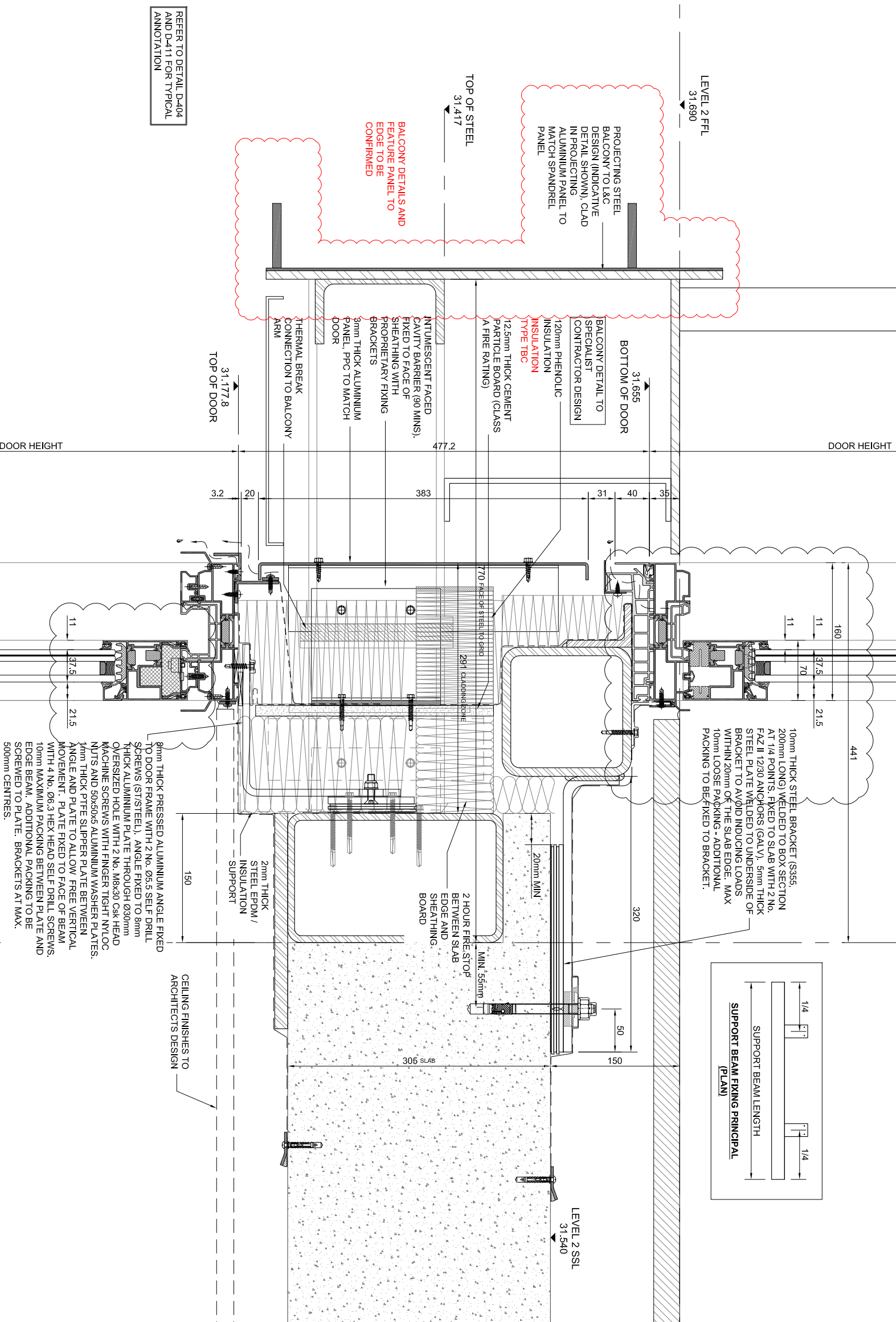

REFER TO DETAIL D-04 AND D-411 FOR TYPICAL ANNOTATION

DOOR HEIGHT

DOOR HEIGHT

D-1

03 GLAZING CHANGED	18.08.17	HB	MAV
02 CONSTRUCTION ISSUE	14.07.17	MAV	CA
01 ISSUED FOR INFORMATION	28.04.17	CTO	MAV
No Revision		Initial	Chkd

WINTTECH
 FACADE ENGINEERING CONSULTANCY
 Quarry House, Ponderford Business Park,
 Woodston Road, Wotton Bassett, WY19 5HA
 Tel: +44(0)1902 307430 Email: enquiries@winttechgroup.co.uk
 Project Name: 182 - 184 HIGH HOLBORN,
 LONDON

Drawing Title: EWS 04: VERTICAL SECTION THROUGH LEVEL 02 BALCONY
 Status: CONSTRUCTION Scale: 1:5 @ A3 Date: 17.05.17
 Project No.: 02164 Drawing No.: D-416 Rev.: 03