

Plaster moulding taken from squeeze, either formed off site and cut to fit, or drawn in situ, subject to specialist input



01 Existing damaged plaster cornice on second floor to be replaced  
X\_501

01 Existing Cornice profile for repair/replacement  
Condition 2 - Rear Room  
X\_501

Scale 1:5  
0 0.1 0.2 Metres

|   |            |
|---|------------|
| Revisions   |            |
|   |            |
| 01 Issued to LBC 15.09.17   |            |
| Client<br>Consolidated Ltd.   |            |
| Project<br>St. Giles Circus - Zone 3  |            |
| Drawing Title<br>9 Denmark Street<br>Proposed Cornice Repair Details  |            |
| Drawing Number<br>1401_9D(X)504   |            |
| Scale   | VARIOUS@A1 |
| Status  | APPROVAL   |
| Drawn by  | EW         |
| Date  | 07.09.2017 |
| Do not scale. All dimensions to be confirmed on site. Information contained in this drawing is the sole copyright of Ian Chalk Architects and is not to be reproduced without permission. |            |
| All internal layouts are for illustrative purposes only   |            |

**ica**  
70 Cowcross Street  
London  
EC1M 6EJ  
02037807355  
07785 973723  
ianchalkarchitects.com



01 Existing Internal Elevation  
X\_505 First Floor - Spine wall, back room

New plaster cornice - profile to match existing

New riser with panelling and dado detail to match existing. To be scribed into existing to allow for later removal

Existing corner-cupboard (recently revealed). To be retained in-situ and repaired

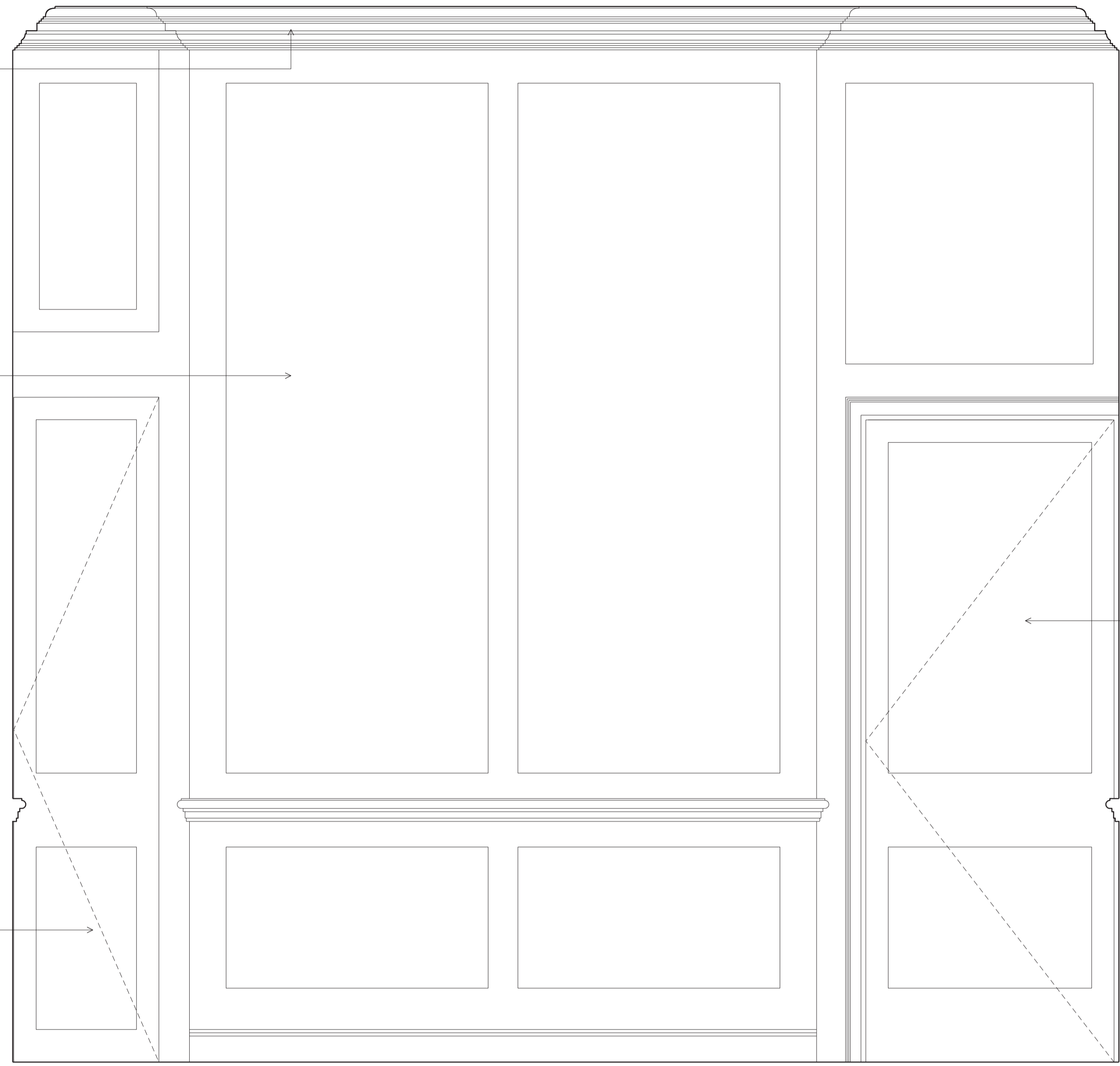

Extent of new riser. To be inset from existing frame to allow for legibility of existing panels

New two-panelled door and reinstated architrave to match existing

02 Proposed Internal Elevation  
X\_505 First Floor - Spine wall, back room - showing typical riser installation

1:10

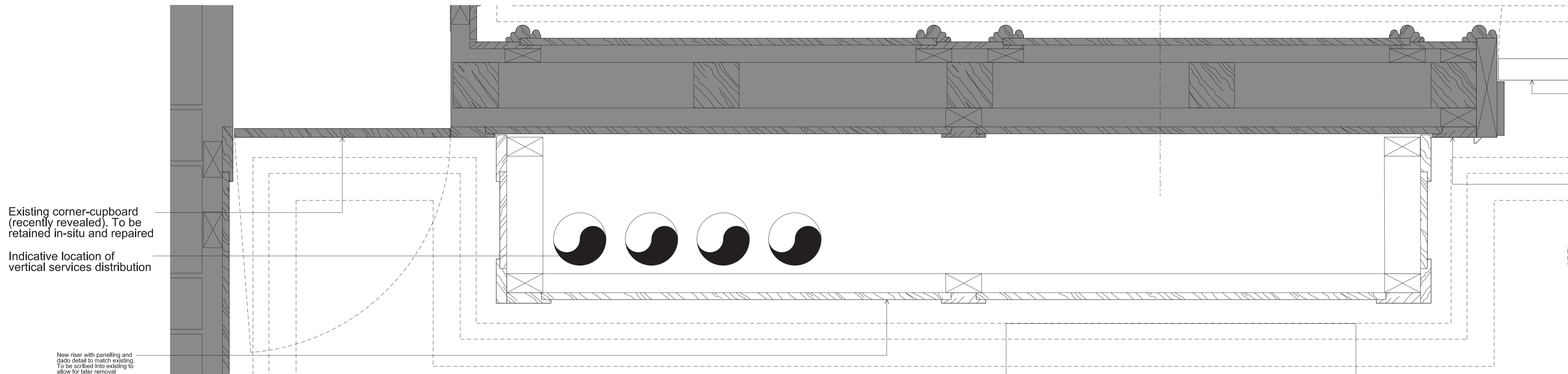
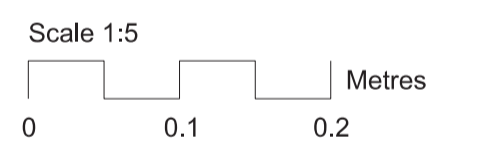

Existing corner-cupboard (recently revealed). To be retained in-situ and repaired

Indicative location of vertical services distribution

New riser with panelling and dado detail to match existing. To be scribed into existing to allow for later removal

New two-panelled door and reinstated architrave to match existing

Existing frame to be left exposed to allow for legibility of existing panels. New riser panelling to be inset and scribed into existing

03 Proposed Typical Riser to Spine Wall  
X\_505 Plan Detail

1:5

|   |   |
|---|---|
| Revisions   |   |
| 01 Issued to LBC 15.09.17   |   |
| Client  | Consolidated Ltd.   |
| Project   | St. Giles Circus - Zone 3   |
| Drawing Title   | 9 Denmark Street<br>Proposed Detail<br>New Riser to Spine Wall                                    |
| Drawing Number  | 1401_9D(X)505   |
| Scale   | VARIOUS@A1  |
| Status  | APPROVAL  |
| Drawn by  | EW  |
| Date  | 08.09.2017  |
| Do not scale. All dimensions to be confirmed on site. Information contained in this drawing is the sole copyright of Ian Chalk Architects and is not to be reproduced without permission. |   |
| All internal layouts are for illustrative purposes only   |   |
| ica   | 70 Cowcross Street<br>London<br>EC1M 6EJ<br>02037807355<br>07785 973723<br>ianchalkarchitects.com |