

Notes
This drawing is © Architype Ltd.
Check this drawing is the latest revision.
Do not scale from this drawing.
Do not use the information on this drawing without checking all dimensions on site.
Do not use any areas indicated for either valuation, purchase, sale or any other form of legally binding contract.
Do not reproduce any part of this drawing without prior written consent.
Report any discrepancies on this document to Architype.
Read this drawing in conjunction with the associated models, specifications and related consultant's documents.
Equivalent products / materials may be Approved where the Employer's Requirements, Thermal Performance, Airtightness and any other specified performance requirements are met. Subject to Architype "Acceptance".
All materials to be certified to comply with BS 14001 or BES6001 or be able to provide a Chain of Custody certificate in order to comply Code for Sustainable Homes. All timber species and sources used in this development are not to be listed on the CITES appendices for endangered or threatened species (appendix I, II or III).

Designer's Hazard Identification
It is assumed that all works will be undertaken by a competent contractor working, where appropriate, to an approved method statement. In addition to the hazards typically associated with the types of construction detailed on this drawing, any known abnormal hazards specific to this drawing have been identified.

Preliminary Issue
Any drawing issued for preliminary issue are for information only. On no account are these drawings to be used for construction. Architype accept no liability for proceeding on this basis and additional costs may arise to the contractor.

- KEY**
- Completed new build buildings by HPL
 - Existing building constraints
 - Future buildings
 - Planning phase 1 boundary= Contract phase 1A boundary.
 - Planning Boundary.
 - Planning phase 2 boundary= Contract phase 1B boundary.
 - Existing trees to be retained, refer to Landscape architects drawings

DRAFT 18.09.17

1	18.09.17	Preliminary issue		KSH	AMF
Rev	Date	Description		Drawn	Checked
Revision Schedule					

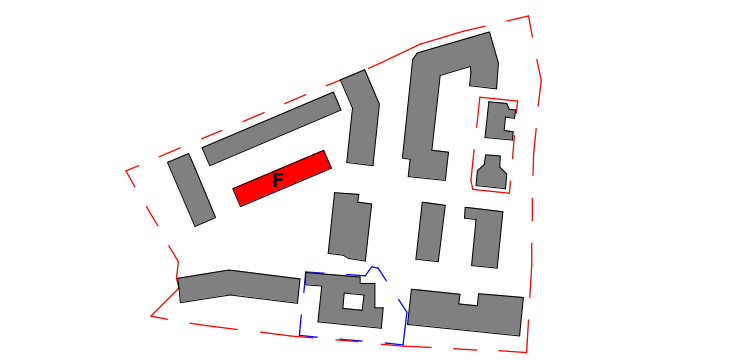

Client:	Hill Partnership Ltd for Camden Council				
Project:	Agar Grove Block Phase 1A+B Site				
Drawing Title:	Planning and Contract Boundries				
Project	Originator	Type	Role	Phase Block Unit	Unique ID
T14011	- ART	-	- A	- 1a A	- SK-009
Status:	Code	Suitability Description			
	S3	Issued for internal Review			
Revision:	Code	Revision Description			
	P 1	Preliminary Review			
Scale:	As indicated @ A1		Date:	09/18/17	
Drawn by:	KSH		Checked by:	AMF	
Internal Project Ref:	8090 & 8575		Model Ref:	AG-RAC2015-A-SITE	