

- KEY**
- AREA COVERED BY EMERGENCY LIGHTING  
3 HR NON MAINTAINED
  - HALF HOUR FIRE RATED DOOR WITH SELF CLOSER
  - VISION PANEL (FIRE RESISTING GLASS)
  - DOOR WITH PANIC BOLT
  - DOOR WITH SIMPLE FASTENING
  - FIRE ALARM CALL POINT
  - FIRE ALARM SOUNDER
  - FIRE BLANKET IN CONTAINER
  - CARBON DIOXIDE FIRE EXTINGUISHER
  - WATER FIRE EXTINGUISHER
  - AREA COVERED BY AUTOMATIC SMOKE DETECTOR
  - AREA COVERED BY AUTOMATIC HEAT DETECTOR
  - FIRE EXIT SIGN - 3HR NON MAINTAINED REF;  
MANVIER EXN WITH PICTOGRAM PEAD
  - FIRE ALARM PANEL
  - DENOTES THE SALE AND CONSUMPTION OF ALCOHOL  
AND THE PROVISION OF LATE NIGHT REFRESHMENT

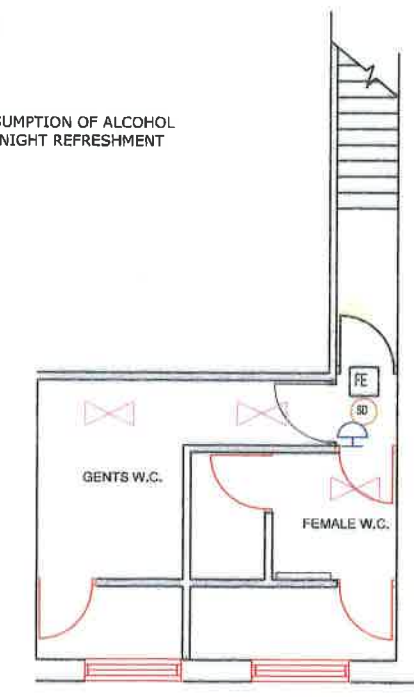

RAISED

REV	DATE	DETAILS	DRAWN
A	22.12.14	External Licensing Area updated	JB
-	15/7/14	1st Issue	JB

ON BEHALF OF

**PROJECT TITLE**  
252-254 West End Lane,  
London,  
NW6 1LU

<b>DRAWING TITLE</b> Premises License Plan	<b>SCALE</b> 1:100 @ A3
<b>DRAWN</b> JB	<b>CHECKED</b>
<b>DATE</b> FEB 2014	<b>DWG NO.</b> bp309-02
<b>REV</b> A	