

DO NOT SCALE

CONTRACTORS ARE RESPONSIBLE FOR SATISFYING THEMSELVES THAT THE DIMENSIONS AND DETAILS SHOWN ON THE DRAWINGS ARE CORRECT AND COMPLIANT WITH THE SPECIFICATION PRIOR TO MANUFACTURE. REPORT OMISSIONS AND ERRORS TO WINTTECH.

CONTRACTORS ARE TO ENSURE THAT ALL COMPONENTS FORMING PART OF THEIR WORKS ARE FABRICATED AND INSTALLED IN ACCORDANCE WITH THE MANUFACTURERS RECOMMENDATIONS.

ALL ELEVATIONS VIEWED FROM THE OUTSIDE UNLESS OTHERWISE STATED

DETAIL NUMBER	VENT / DOOR LEAF
1	HINGE
2	HINGE

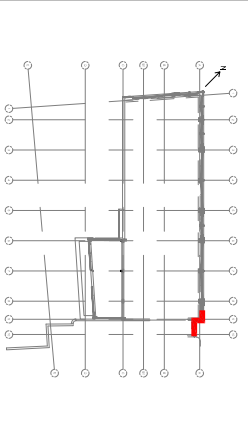

DRAWING BASED ON LATEST INFORMATION AVAILABLE CONTRACTOR TO ALLOW FOR UPDATES TO DRAWINGS AND RE-SUBMISSION FOR CONSTRUCTION TO TAKE INTO ACCOUNT OF SURVEY BUILDING INFORMATION AND FINAL DESIGN/ENGINEERING

WINTTECH
 FACADE ENGINEERING CONSULTANCY
 Quarry House, Ponderford Business Park,
 Wobaston Road, Wothamington, W1V9 5HA
 Tel: +44(0)1902 307430 Email: enquiries@winttechgroup.co.uk
 Project Name: 182 - 184 HIGH HOLBORN,
 LONDON

Drawing Title: EWS-01 - HORIZONTAL SECTION THROUGH RECESS TO EXISTING BUILDING

Scale: 1:5 @ A3 Date: 23.05.17

Project No.: 02164 Drawing No.: D-121 Rev.: 03

No	Revision	Date	Initial	Chkd
03	SHOP FRONT SYSTEM ADDED	06.09.17	MAV	CA
02	CONSTRUCTION ISSUE	05.07.17	MAV	CA
01	ISSUED FOR INFORMATION	23.05.17	MAV	CA