

DO NOT SCALE

CONTRACTORS ARE RESPONSIBLE FOR SATISFYING THEMSELVES THAT THE DIMENSIONS AND DETAILS SHOWN ON THE DRAWINGS ARE CORRECT AND COMPLIANT WITH THE SPECIFICATION PRIOR TO MANUFACTURE. REPORT OMISSIONS AND ERRORS TO WINTTECH.

CONTRACTORS ARE TO ENSURE THAT ALL COMPONENTS FORMING PART OF THEIR WORKS ARE FABRICATED AND INSTALLED IN ACCORDANCE WITH THE MANUFACTURERS RECOMMENDATIONS.

ALL ELEVATIONS VIEWED FROM THE OUTSIDE UNLESS OTHERWISE STATED

| | |
|----------------|------------------|
| DETAIL NUMBER | VENT / DOOR LEAF |
| DETAIL DRAWING | HINGE |
| | HINGE |

KEY PLAN

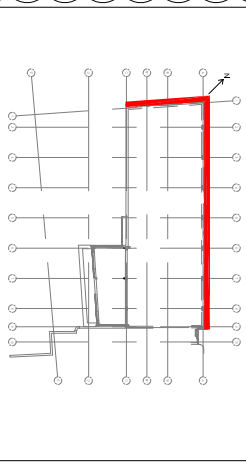

ALL DIMENSIONS SUBJECT TO FINAL BUILDING SURVEY FOLLOWING FACADE STRIP OUT

DRAWING BASED ON LATEST INFORMATION AVAILABLE. CONTRACTOR TO ALLOW FOR UPDATES TO DRAWINGS AND RE-SUBMISSION FOR CONSTRUCTION TO TAKE INTO ACCOUNT OF SURVEY BUILDING INFORMATION AND FINAL DESIGN/ENGINEERING

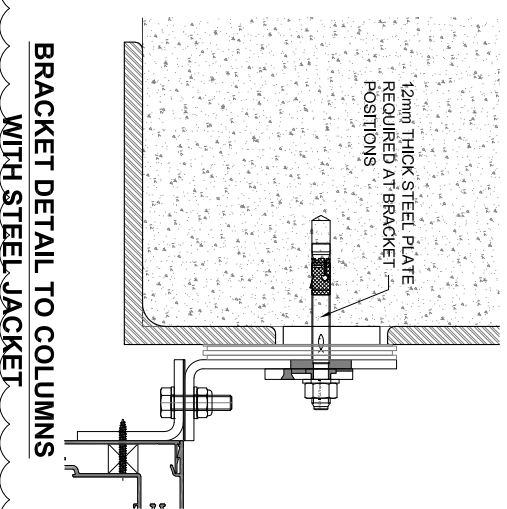
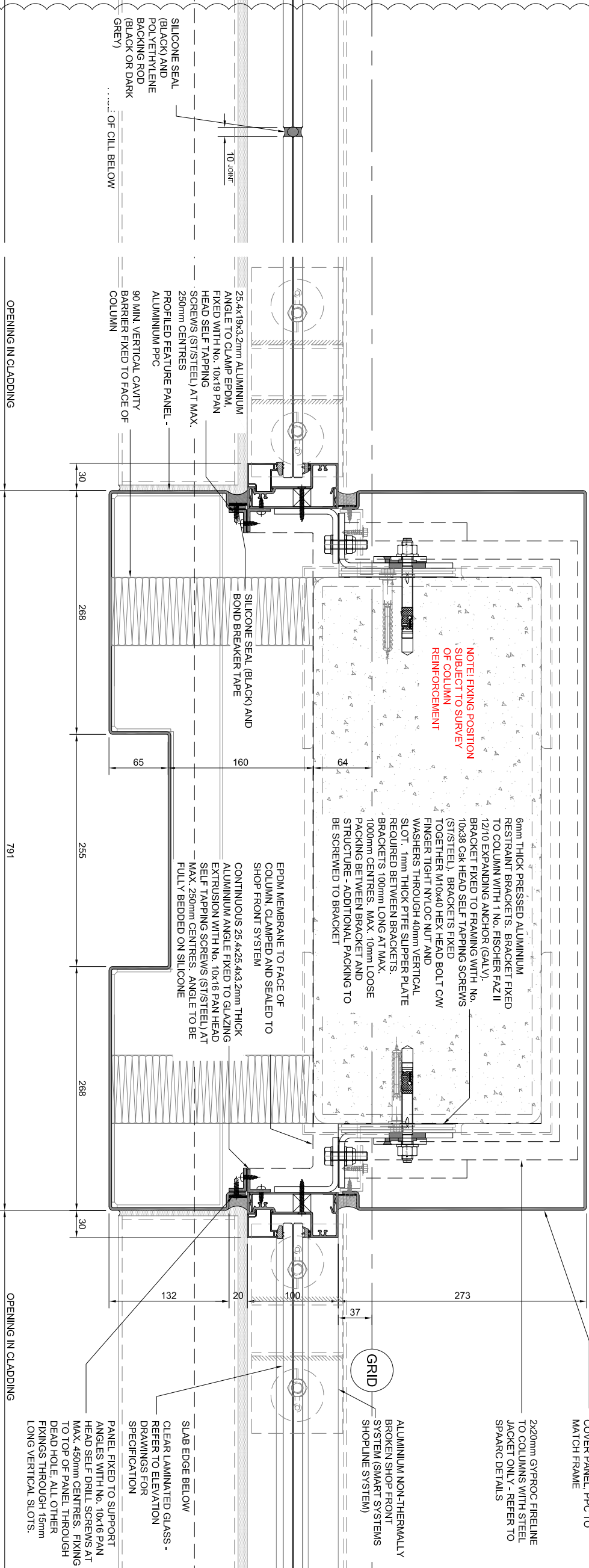
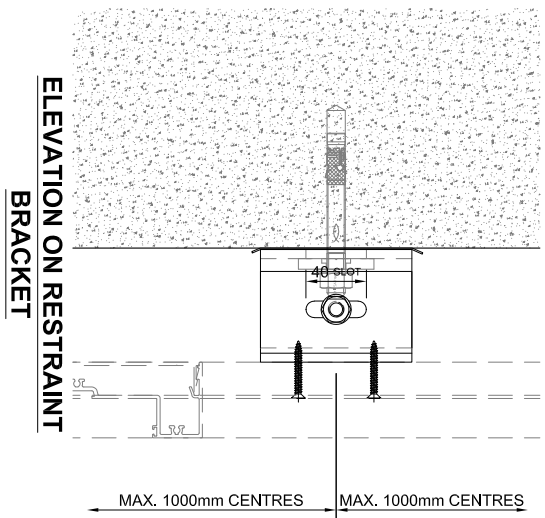

03 UPDATED TO SHOP FRONT SYSTEM 04.09.17 MAV CA
02 CONSTRUCTION ISSUE 05.07.17 MAV CA
01 ISSUED FOR INFORMATION 18.05.17 MAV CA
 No Revision Date Initial Chkd

WINTTECH
 FACADE ENGINEERING CONSULTANCY
 Quartz House, Pendeford Business Park,
 Woburn Road, Wotton Bassett, WY9 5TA
 Tel: +44(0)1902 307430 Email: enquiries@winttech-group.co.uk

Project Name: **182 - 184 HIGH HOLBORN, LONDON**

Drawing Title: **EMS-01: HORIZONTAL SECTION THROUGH FEATURE PANEL - GROUND FLOOR**

Status: **CONSTRUCTION** Scale: 1:5 @ A3 Date: 17.03.17

Project No.: **02164** Drawing No.: **D-1111** Rev.: **03**