

Dawson (development), Barry

From: Little, Tom
Sent: 20 September 2017 09:49
To: Planning
Subject: FW: The Waterhouse
Attachments: The Waterhouse -TCP - June 2017 - BO - 633-Waterhouse-110512-Proposed Site Plan-DWG & 14624_OGL-DWG-A1-TCP.pdf

Please register as a DD in my name.

There is an additional email with photos.

Many thanks,

Tom Little
Tree and Landscape Officer

Telephone: 02079746266



From: Adam Hollis [mailto:adam.hollis@landmarktrees.co.uk]
Sent: 20 September 2017 09:37
To: Little, Tom <Tom.Little@camden.gov.uk>
Cc: Bell, Nick <Nick.Bell@camden.gov.uk>
Subject: The Waterhouse

Hi Tom,

Good to see you on Monday, thanks for coming out. I've copied Nick in, as I haven't used your email for a while, and wasn't sure if I've got it right.

Please take this email as a 5-day notice to do the following works under Conservation Area exemption:

1. fell purple plum tree A on sketch below (severely decayed and leaning over neighbour's property and nearby parking space). Low tree previously concealed in scrub (now cleared).
2. fell hawthorn tree T4 on attached Tree Constraints Plan (dead and leaning over right of way).
3. deadwood hawthorn tree T6 on attached Tree Constraints Plan on sketch (dead branches next to right of way).

I will also send some supporting photos in a following email.

ce House

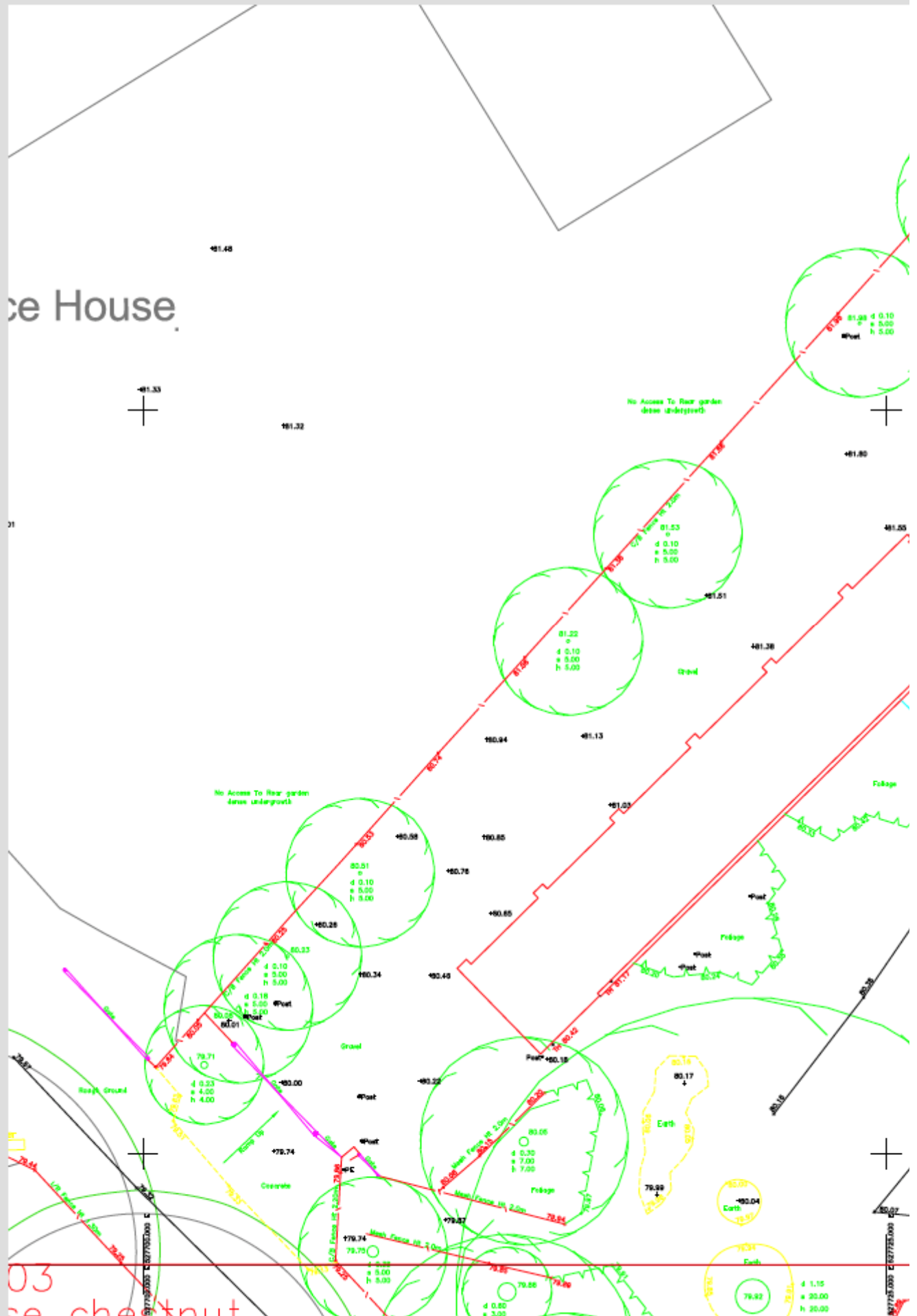

Kind regards

Adam

Adam Hollis

MSc Arb MICFor CENV F Arbor A

Registered Consultant

Chartered Forester

Chartered Surveyor

Chartered Environmentalist

Landmark Trees

Holden House,

4th Floor,

57 Rathbone Place,

London W1T 1JU

Mob: +44 (0)7812989928

Tel: +44 (0)20 7851 4544

<http://www.landmarktrees.co.uk>

This email is sent in confidence for the addressee(s) only and may be subject to legal professional privilege. Unauthorised use, dissemination, distribution, publication or copying of this communication is strictly prohibited. If you receive this communication in error, please notify us immediately and delete any copies.