

REVISION HISTORY			
REV	DESCRIPTION	DATE	DRAWN
C	Building position adjusted to avoid BT manhole. Landscaping revised.	11/12/15	AM
D	Floor plan amended; fall added, notes added; key added	04/08/16	BT
E	Building moved 300 mm	22/8/16	PR
F	Set out dimensions added to fence and gate	20/11/17	NA
G	New tree positioned within existing planter, species confirmed. 2 existing planters re-formed. Existing tarmac around new building re-laid. New fence lining re-aligned, store omitted. Deck over steps omitted. Slate tiles to covered entrance way.	22/3/17	NA
H	Planting Schedule added	25/8/17	NA
I	Plant species type A: Weeping Blue Atlas Cedar tree (Cedrus Atlanta Glauca Pendula) omitted from planting scheme.	18/9/17	JE

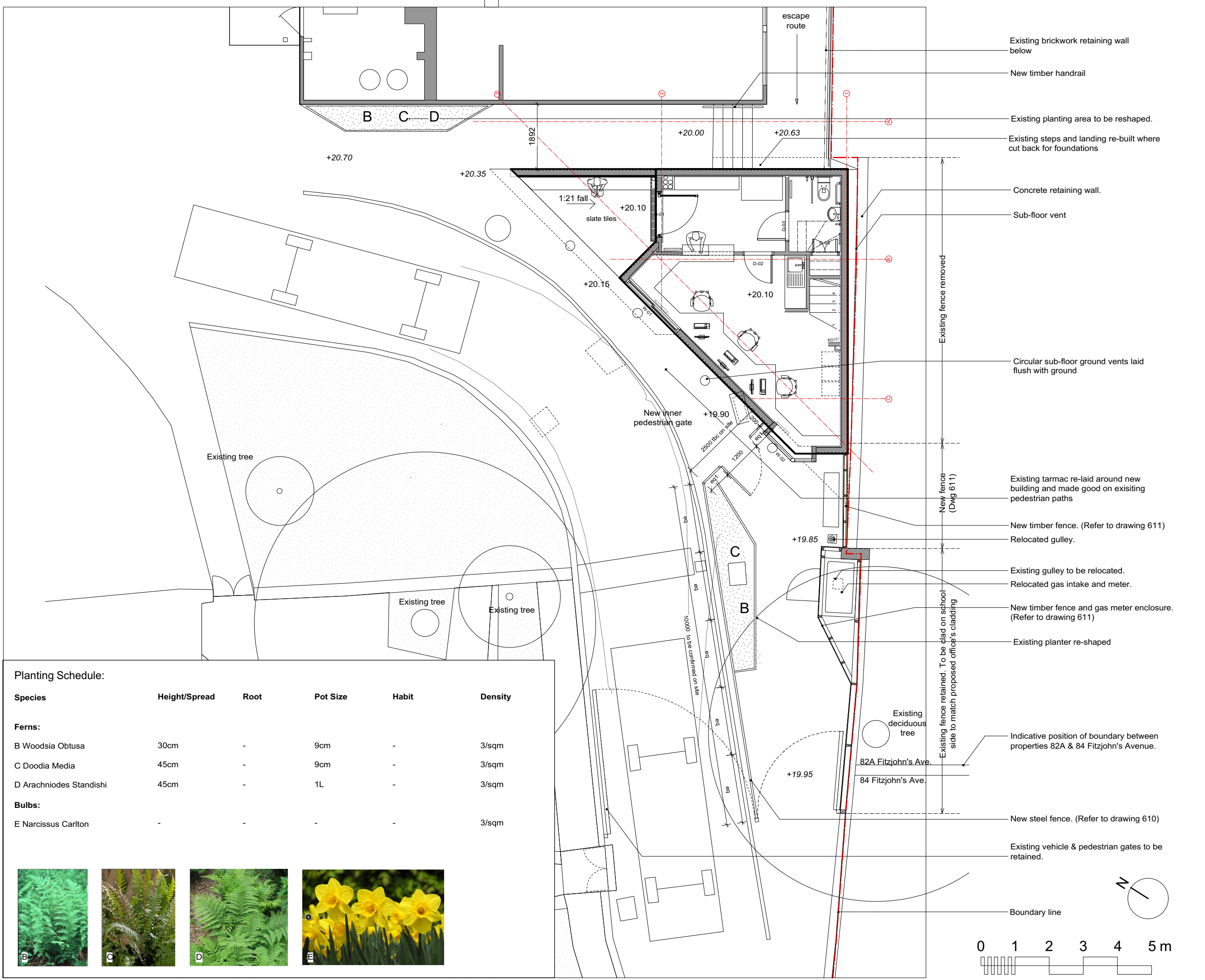

Planting Schedule:

Species	Height/Spread	Root	Pot Size	Habit	Density
Ferns:					
B Woodsia Obtusa	30cm	-	9cm	-	3/sqm
C Doodia Media	45cm	-	9cm	-	3/sqm
D Arachniodes Standishi	45cm	-	1L	-	3/sqm
Bulbs:					
E Narcissus Carlton	-	-	-	-	3/sqm



KEY

+20.35	Existing site levels
+20.15	Proposed site levels

© Copyright Curl la Tourelle Architects

NOTES:
All dimensions to be checked on site, not scaled from this drawing.

Any discrepancies on this drawing with other contract documents to be reported immediately to the Contract Administrator for clarification.

CONSTRUCTION

Client
Fitzjohns Primary School

Curl la Tourelle Head Architecture

80 Lambie Street, London NW5 4AB
tel +44 (0)20 7267 0055
www.citarchitects.co.uk

Job
New Office

86A Fitzjohn's Ave, Hampstead
NW3 6NP London

Drawing Title
Proposed Site Plan & Planting Schedule

Scale	1:50 @ A1
	1:100 @ A3
Date	Drawn Issued Checked
20.05.2015	RA RA NA
Drg. No.	Rev.
705E	102

