

Existing Plans & Elevations

HP17703/01

Note:

- This drawing is copyright.
- Contractors must check all dimensions on site.
- Figured dimensions are to be used in preference to scaled dimensions.
- Discrepancies must be reported immediately.
- Construction (Design & Management) Regulations 2007.

All persons associated with this project in particular (but not exclusively) the Instructing Client, the Principal Contractor, Sub-Contractors and other Designers are hereby notified and/or reminded of their obligations under Health & Safety legislation in general and in particular under the Construction (Design & Management) Regulations 2007 (and any subsequent amendments that may be issued from time to time).

In developing their design of the works, the Health & Safety of the builders and the users of the construction have been considered in accordance with the above regulations and declare that all reasonable efforts have been made to see that the construction and use of the work/building will be without any risks greater than those associated with the normal construction and use of a building of this type and size.

Where a CDM co-ordinator has been (or is required to be) appointed under the regulations for a notifiable project, no construction is to proceed before all H&S documentation is complete.

Party Wall Act.
The owner, should they need to do so under the requirements of the Party Wall Act 1996, has a duty to serve a Party Structure Notice on any adjoining owner if building work on, to or near an existing Party Wall involves any of the following: Support of beam, Insertion of DPC through wall, Raising a wall or cutting off projections, Demolition and rebuilding, Underpinning, Insertion of lead flashings. Excavations within 3 metres of an existing structure where the new foundations will go deeper than adjoining foundations, or with 6 metres of an existing structure where the new foundations are within a 45 degree line of the adjoining foundations. A Party Wall Agreement is to be in place prior to start of works on site.

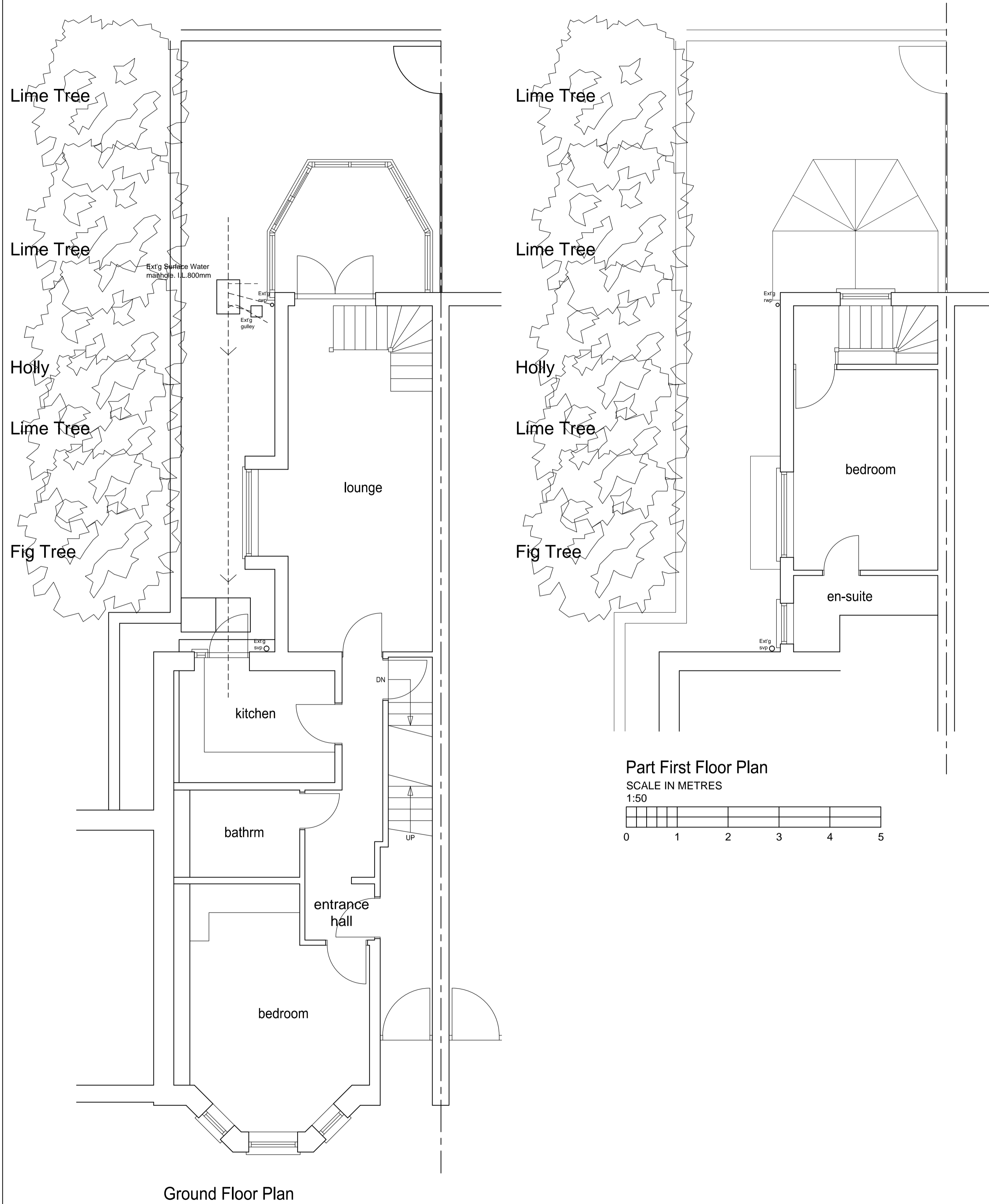

Legend:

Revision	Description	Date

Link
architectural planning & design

The Grange, 20 Market Street,
Swavesey, Cambridge, CB24 4QG
Office: 01954 232577 - Mobile: 07919 543521
ian@linkarch.co.uk

Client:
Candice Sammeroff.

Project Address:
76A Gascony Avenue,
West Hampstead, London, NW6 4NE.

Project Details:
Ground Floor Side & Rear Extensions.

Drawing Details:
Existing Plans & Elevations.

Scale:	Date:	Drawn:	ICH
1:50, 1:100	Sept. 2017	Checked:	
AutoCAD file code:	Project No.	HP17703	
HP17703	Drawing No.	HP17703/01	