

It is the responsibility of the client to ensure that those undertaking the works are competent and experienced in the type of work to be undertaken.

In addition to the hazards usually associated with the types of work detailed on this drawing, the following specific hazards have been identified through design risk assessment. The planning and execution of the works should take into account all usual and specific hazards.

Hazards should also be taken into account in the maintenance, operation, decommissioning and demolition of the works.

NOTES

- All dimensions are in millimetres (mm) and levels in metres Above Ordnance Datum (mAOD) unless noted otherwise.
- Do not scale from this drawing.
- The copyright in this drawing belongs to SC Structures Ltd; the designs and details may not be used on any project other than that indicated in the titleblock.
- Where CAD or BIM files of the drawing are issued, they are provided for the convenience of others, and shall not be used for construction purposes or relied upon for accuracy or completeness.
- This drawing is based on A J Browne R.L.B.A. Architects drawing number 5011 SK100 Revision A entitled Existing Ground Floor First Floor dated November 2016.

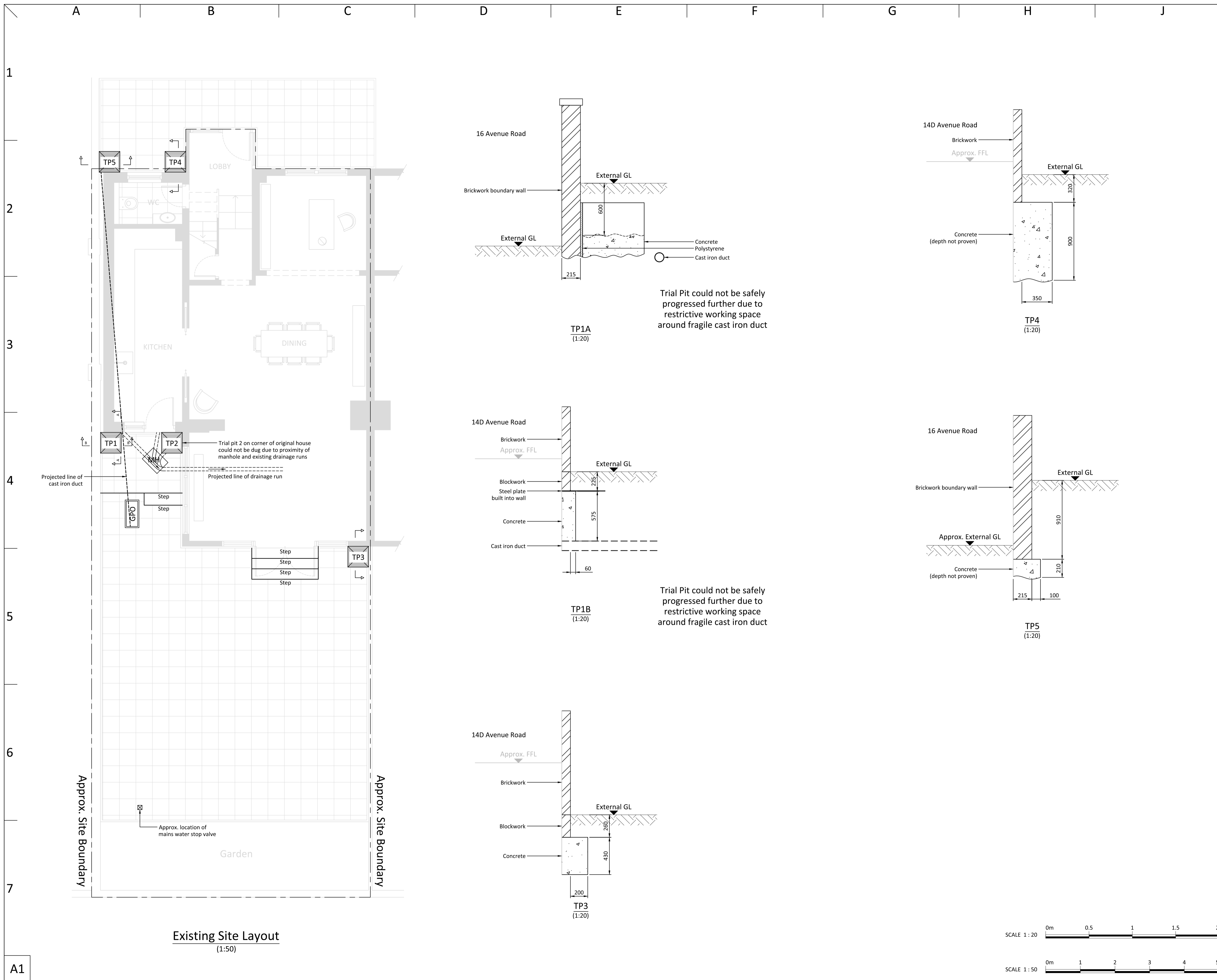

Existing Site Layout (1:50)

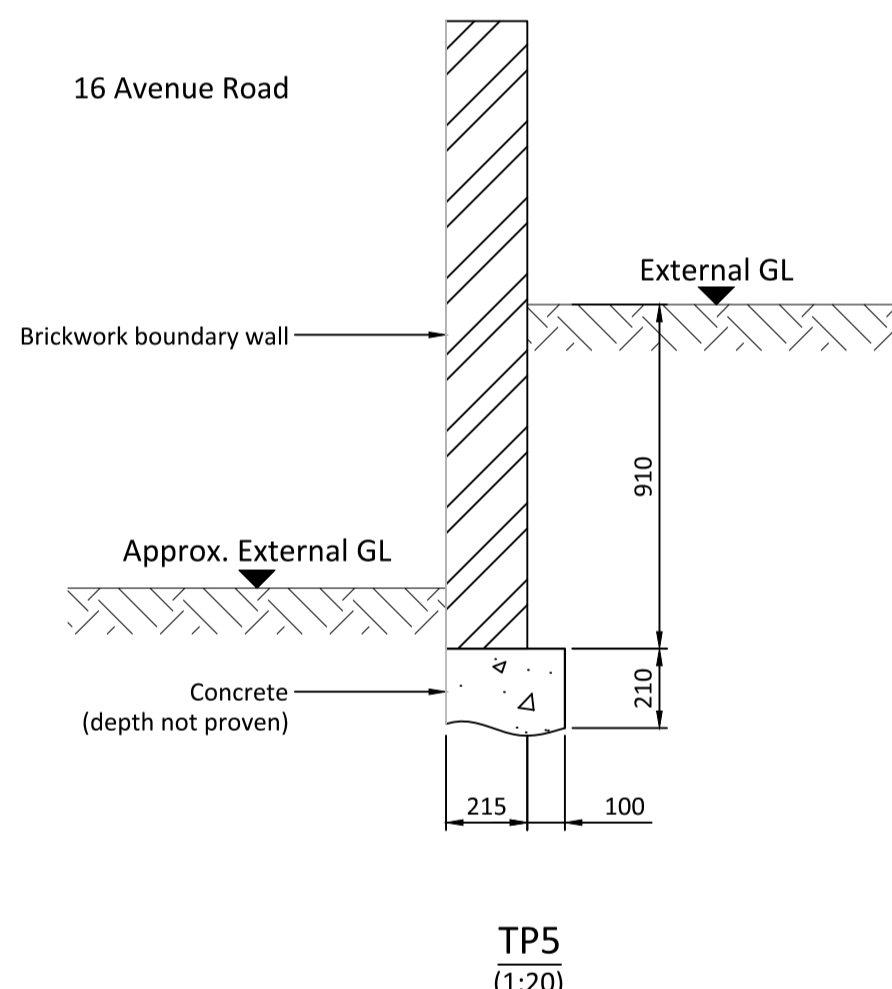
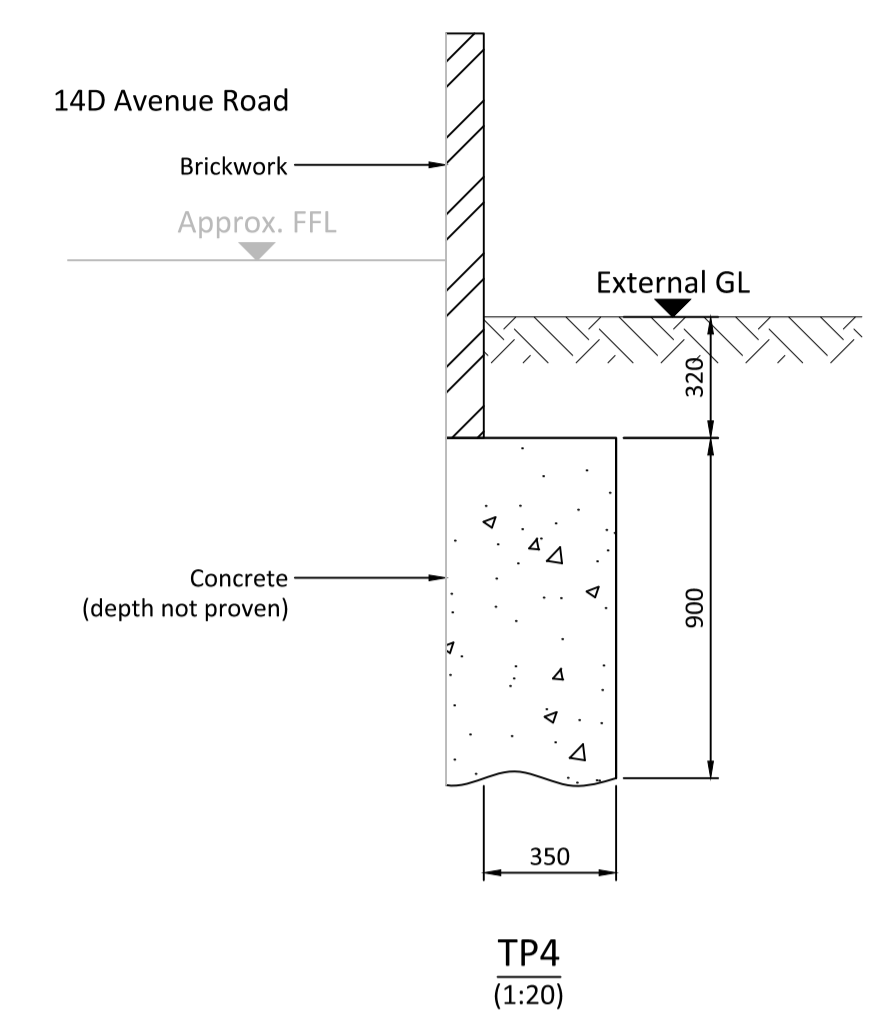
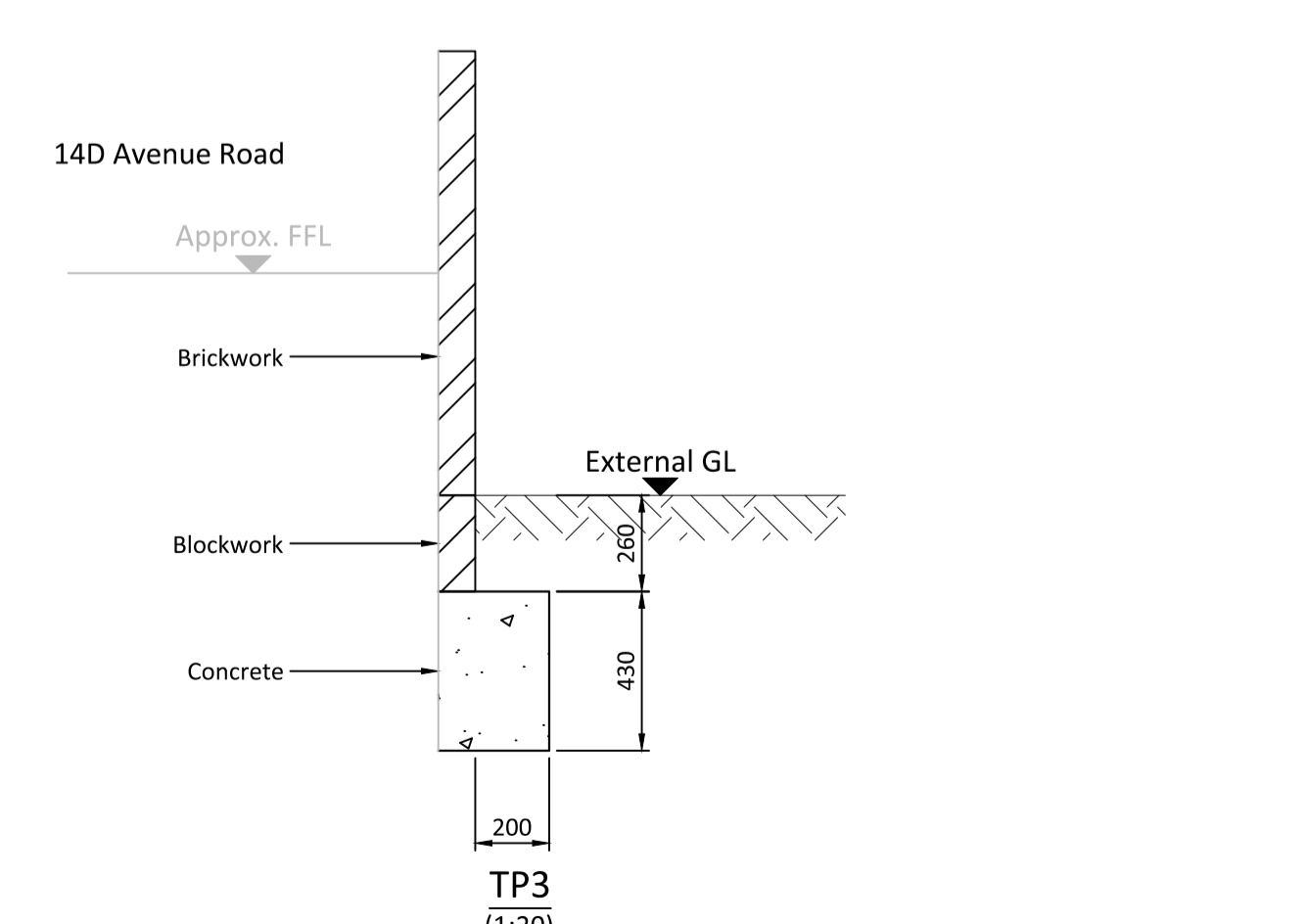
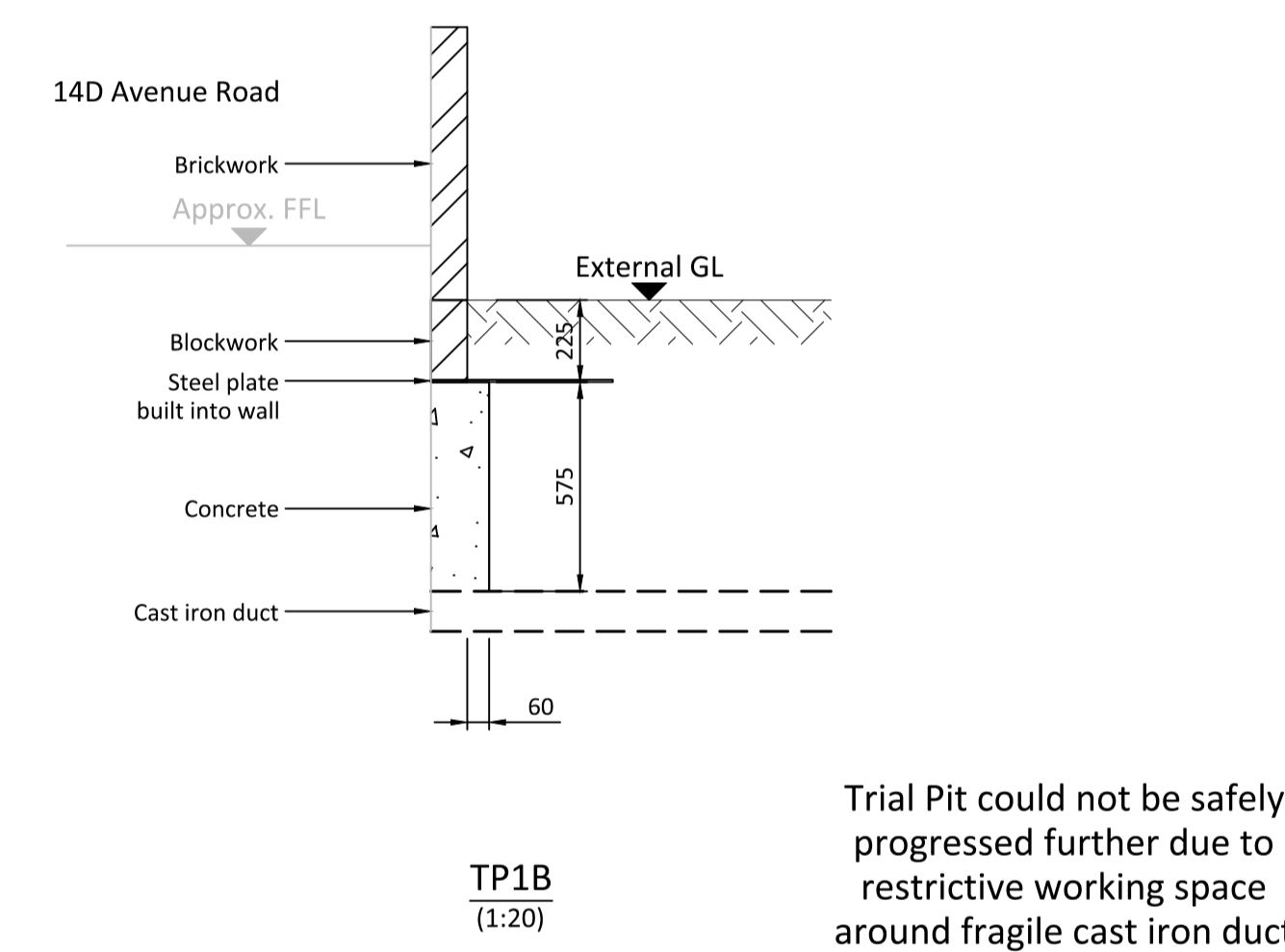
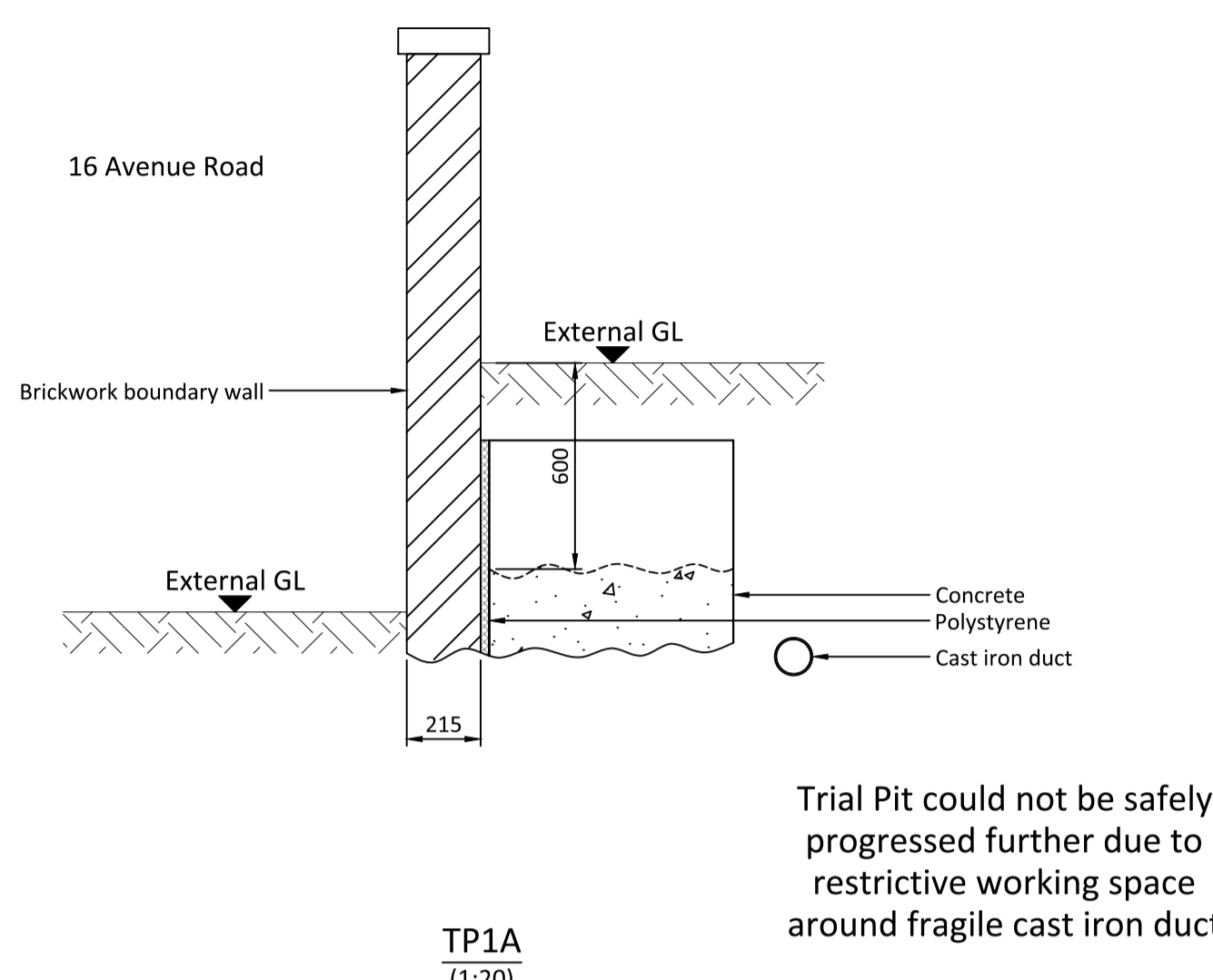

Rev.	Date	Description	Drawn	Checked
P2	08.09.17	UPDATED WITH A J BROWNE COMMENTS	AP	SC
P1	03.09.17	FIRST ISSUE	AP	SC

PRELIMINARY

14D Avenue Road

Trial Pit Record and Visible Existing Services



Drawing No: 0018-TP001 Revision: P2

