

REAR ELEVATION  
AS PROPOSED

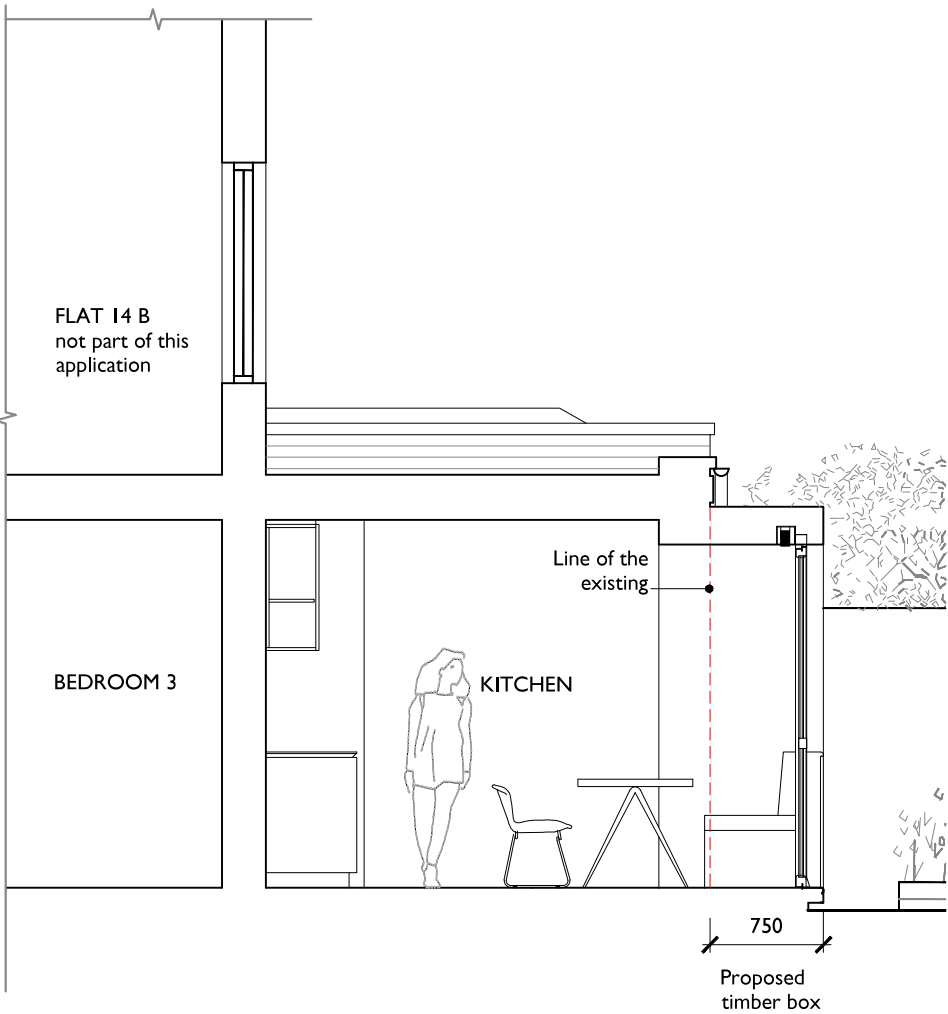

PART SECTION AA  
AS PROPOSED

Notes  
Allde assumes no responsibility for the accuracy of this record drawing or for any errors that may have been incorporated into it as a result of incorrect information provided to Allde.  
All setting out of work to be checked on site before work commences.  
Work only to measured dimensions, do not scale.  
All work to be in accordance to relevant Building Regulations and subject to Planning, Listed Building and relevant statutory authorities Consent. Allde owns the copyright of this design, which must be not reproduced in whole or part without the written permission of Allde.

ISSUED FOR PLANNING

Revisions					
Revision	Note	Date	Revision	Note	Date
A	Issued for Design.	27.06.17			
B	Issued for Planning. Info amended.	07.09.17			

NOTES:

WALLS Works to structure subject to Damproofing specialists and Structural Engineers's information

CEILINGS As existing

DOORS All original doors retained and overhauled.

WINDOWS All original windows to be overhauled as necessary unless otherwise specified

NB:  
Drawing based on approximate dimensions, all dimensions to be checked on site.



Project		
1056 Flat A 14 Boscastle Rd NWS IEG		
Date	20.03.2017	Title
Drawn by	RF	Rear Elevation and Part Section AA as Proposed
Scale	1:50 @ A3; 1:25 @ A1	Drawing No. 1056 APL 003 Rev. B