

Declaration of performance

DoP number: 134510-A1W1111

Product name:

OUVERTURE MARZIALE WDF

(1) Identification code of product-type is DoP-number

(2) Reference number: 134510-A1W1111

(4)



Wienerberger

Wienerberger B.V.
5301 LK Zaltbommel Hogeweg 95
Nederland

(3) Intended use(s) in masonry walls, columns and partitions for:

unprotected masonry

(6) Assessment and verification of constancy of performance:

System 2+

(7) Notified Body:

0957

Performed:

(i) initial inspection of the manufacturing plant and of factory production control

(ii) continuous surveillance, assessment and evaluation of factory production control and issued certificate number 0957-CPD-0621

(9) Declared performance:

Type of unit: HD -masonry unit

Dimensions and tolerances

			Tm	Rm
Length:	mm	215	± 4	9
Width:	mm	102	± 3	6
Height:	mm	66	± 2	5
Tolerance:	category		T2	
Range:	category		R1	
Flatness of bed faces:	mm		NPD	
Plane parallelism:	mm		NPD	

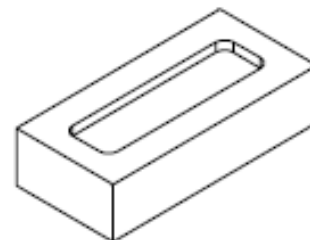

actual configuration may vary slightly

Configuration

Group of the unit:	-	1
Volume of all formed voids:	%	NPD
Volume of frogs:	%	NPD

Density

Gross dry density:	kg/m ³	1700
Net dry density:	kg/m ³	NPD
Tolerance:	category / %	D1 / 10

Compressive strength

Category:	-	1
Perpendicular to bedface:	N/mm ²	20
Perpendicular to header:	N/mm ²	NPD
Perpendicular to header 2:	N/mm ²	NPD

Bond strength:

	N/mm ²	NPD
--	-------------------	-----

Tabulated value according to EN 998-2, Annex C

Determination method EN 1745:2012: S1

Thermal conductivity λ_{10} , dry, unit:	W/(m·K)	0.51
--	---------	------

Tabulated value according to EN 998-2, Annex C

Water vapour permeability:	-	$\mu = 5\text{-okt}$
----------------------------	---	----------------------

According to CEN/TS 772-22

Durability:	category	F2
-------------	----------	----

Water absorption:	%	12
-------------------	---	----

Initial rate of water absorption:	kg/(m ² ·min)	0.3-2
-----------------------------------	--------------------------	-------

Active soluble salt content:	category	S2
------------------------------	----------	----

Moisture movement:	mm/m	NPD
--------------------	------	-----

Reaction to fire:	class	A1
-------------------	-------	----

Dangerous substances:	-	Voldoet aan BBk
-----------------------	---	-----------------

(10) The performance of the product is in accordance with the specification above.

Signed on behalf of the manufacturer:

CEO
2013-07-01



B.J. Koekoek

Wienerberger B.V.
5301 LK Zaltbommel Hogeweg 95
Nederland

EN 771-1:2011

Supplementary national information:

DoP number: 134510-A1W1111

Product name:

OUVERTURE MARZIALE WDF

(1) Identification code of product-type is DoP-number

(2) Reference number: 134510-A1W1111

(4)



Wienerberger

Wienerberger B.V.

5301 LK Zaltbommel Hogeweg 95

Nederland