

Full paving unit adjacent to planter.

5mm gap between paving units (maintained by pedestal spacer).

600 x 600 x 50mm Mayfair concrete paving flags by Tobermore or equal and approved. Colour (silver or graphite) varies depending on location, refer to ALD g.a. drawing KXC-S2-001-L-ALD775-90-0101 for colour locations.

Ø175mm x 15mm thick stackable pedestals by Caro with 2mm thick shim/s at base as required for fine tuning of levels.

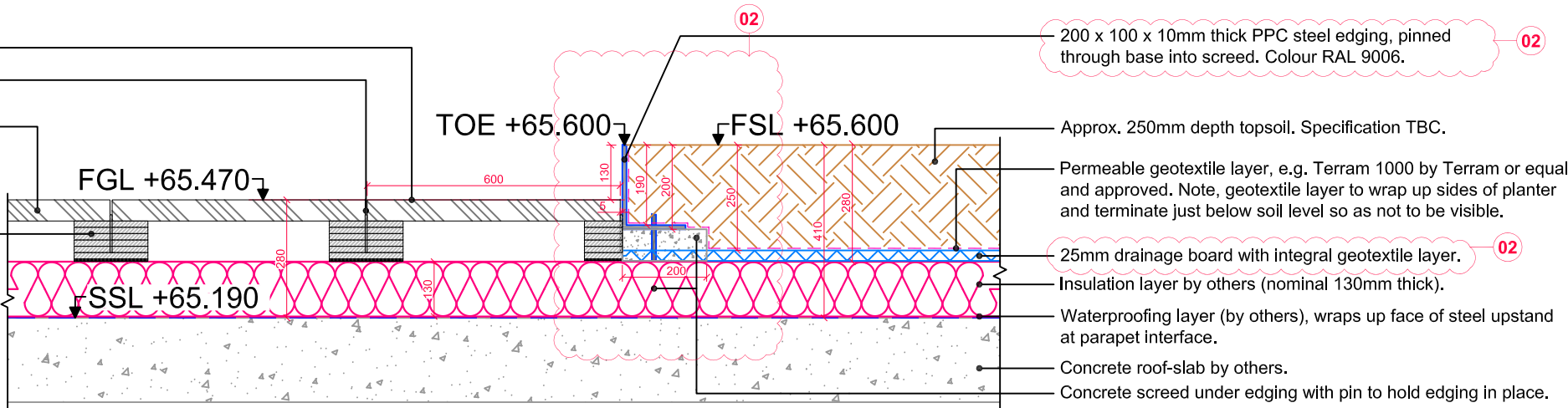

DETAIL 01:
SECTION THROUGH LOW PLANTER INTERFACE WITH PCC PAVING

LANDSCAPE ARCHITECT:

ALD

The Threshing Barn
Bignell Park Barns
Chesterton
Oxfordshire
OX26 1TD

Tel: 01869 249776
Fax: 01869 327513
Email: mail@appliedlandscape.co.uk

© 2017 Applied Landscape Design Limited. All rights reserved.

02	Updated following DTM review.	07.08.17
01	Issued for Contractors Proposals.	19.07.17
Rev.	Update	Date

PROJECT: S2 ROOF, KXC

CLIENT:

Willerby
LANDSCAPES

drawn: AB	checked: AnO
scale: 1:15 @ A3	date: 19th July 2017
status: Contractors Proposal	xref file ref: ALD775_detailsbase

DRAWING TITLE: SECTION THROUGH PAVING INTERFACE WITH LOW PLANTER	
DRAWING NUMBER: KXC-S2-001-ALD775-L-90-722	REVISION: 02