

176mm wide x 32mm thick x 3020mm long 'Carbonised Charred' composite deck board by Millboard or equal and approved. Attached to timber bearers below using Millboard Durafix hidden screw fixings as per manufacturers guidelines. Board to be trimmed to required length (3020mm) with each 'row' of deck comprising of a single board.

02 75 x 47mm treated timber bearer, supported on Caro pedestals/shims as required to achieve levels.

Insulation layer by others (nominal 130mm thick).

Waterproofing layer (by others).

Concrete roof-slab by others.

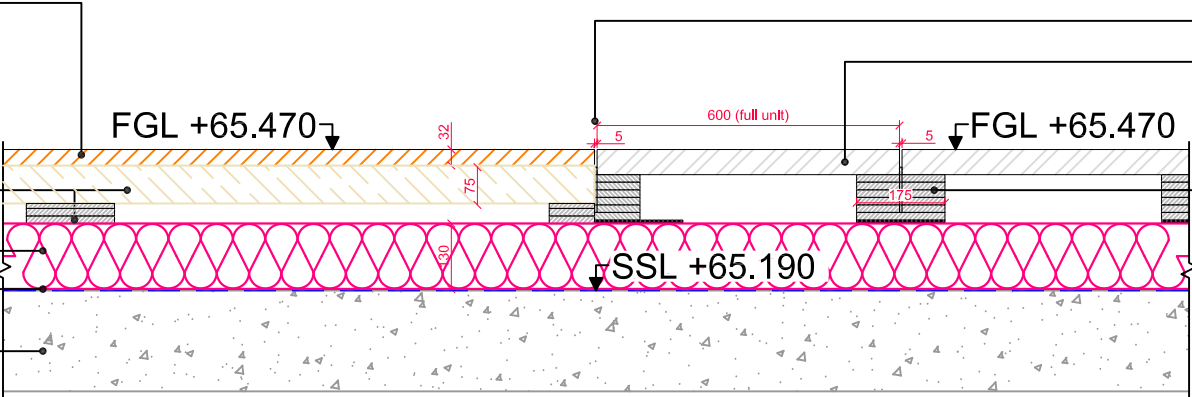

5mm joint between paving and deck.

600 x 600 x 50mm graphite coloured Mayfair concrete paving flags by Tobermore or equal and approved. Refer to ALD g.a. drawing KXC-S2-001-L-ALD775-90-0101 for colour locations. Full unit at deck interface.

Ø175mm x 15mm thick stackable pedestals by Caro with 2mm thick shim/s at base as required for fine tuning of levels.

DETAIL 01:  
SECTION THROUGH DECK INTERFACE WITH PCC PAVING (ALONG DECK BOARDS)

LANDSCAPE ARCHITECT:



The Threshing Barn  
Bignell Park Barns  
Chesterton  
Oxfordshire  
OX26 1TD

Tel: 01869 249776  
Fax: 01869 327513  
Email: mail@appliedlandscape.co.uk

© 2017 Applied Landscape Design Limited. All rights reserved.

02	Updated following DTM review.	07.08.17
01	Issued for Contractors Proposals.	19.07.17
Rev.	Update	Date

PROJECT:

S2 ROOF, KXC

CLIENT:



drawn:

AB

scale:

1:15 @ A3

status:

Contractors Proposal

checked:

AnO

date:

19th July 2017

xref file ref:

ALD775\_detailsbase

DRAWING TITLE:

SECTION THROUGH DECK  
INTERFACE WITH PAVING

DRAWING NUMBER:

KXC-S2-001-ALD775-L-90-724

REVISION:

02

ORIGINAL A3 SIZE SHEET