

TYPE 1 - POST

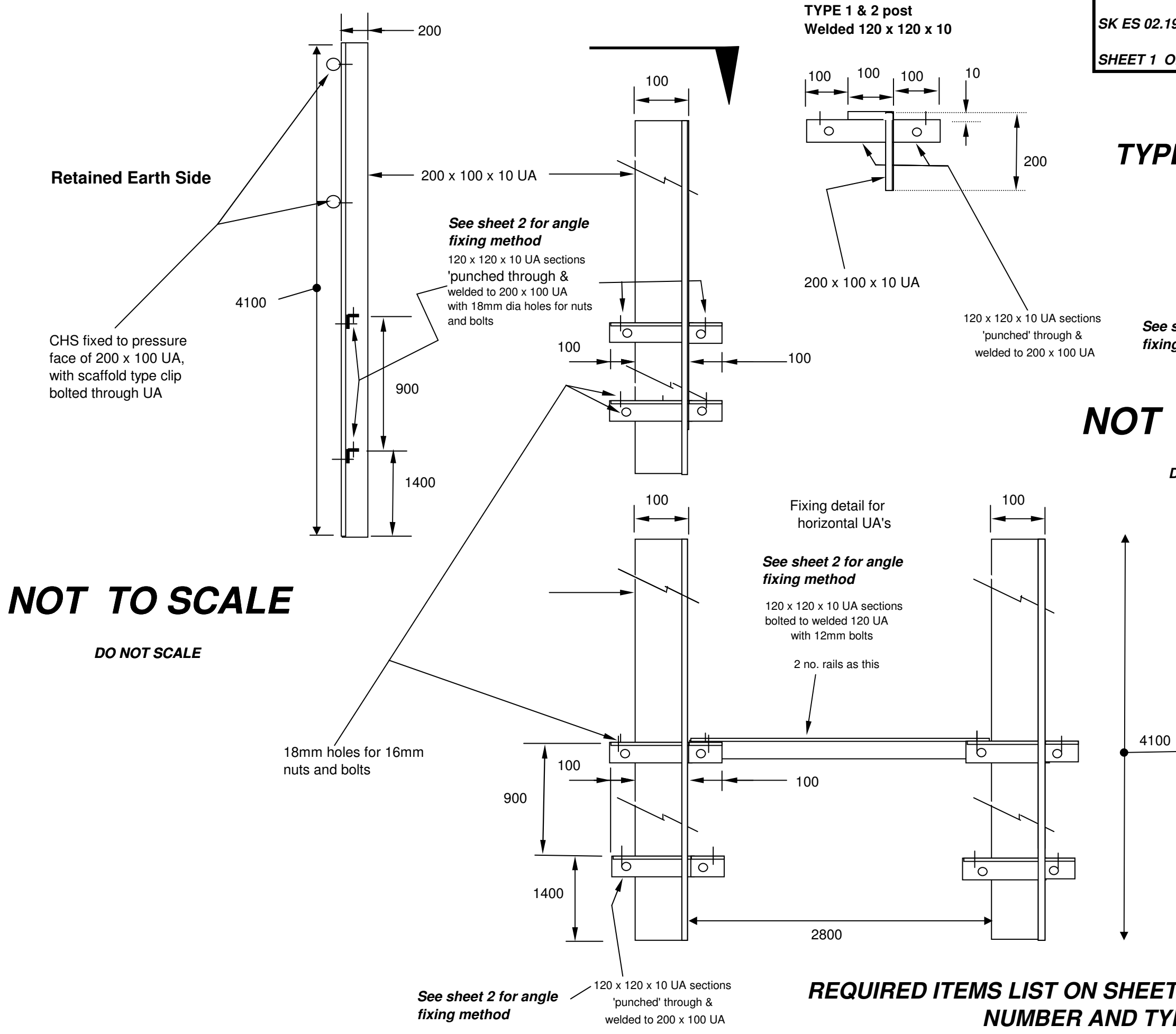

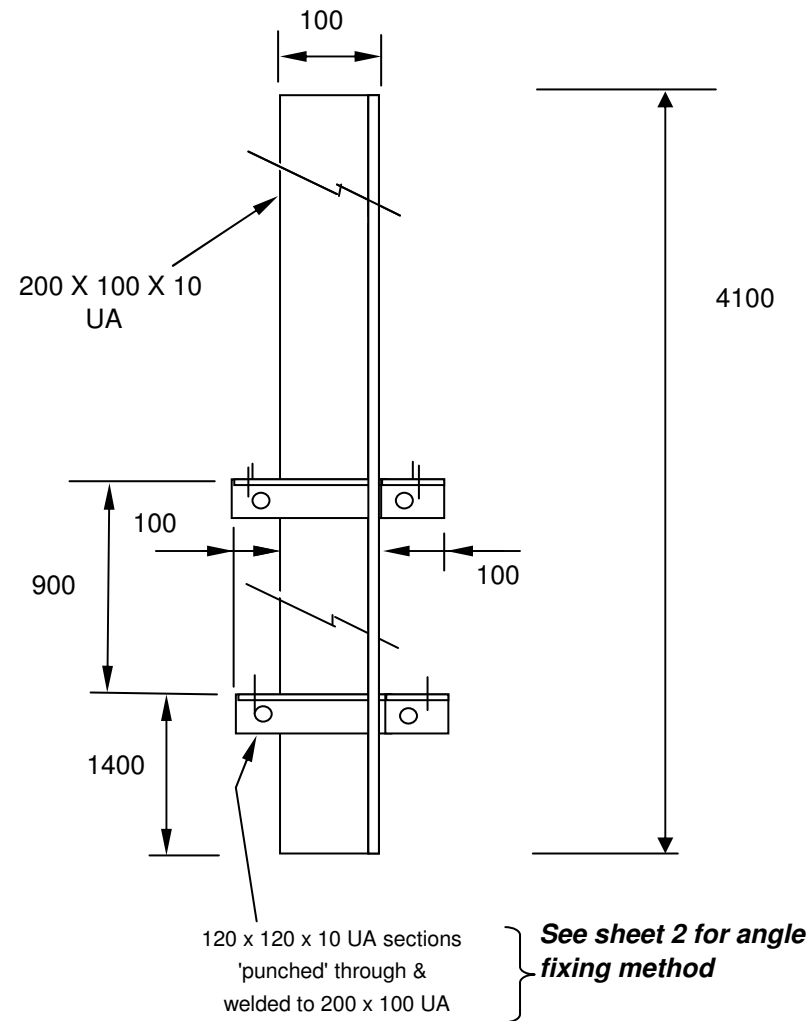

TYPE 1 - POST

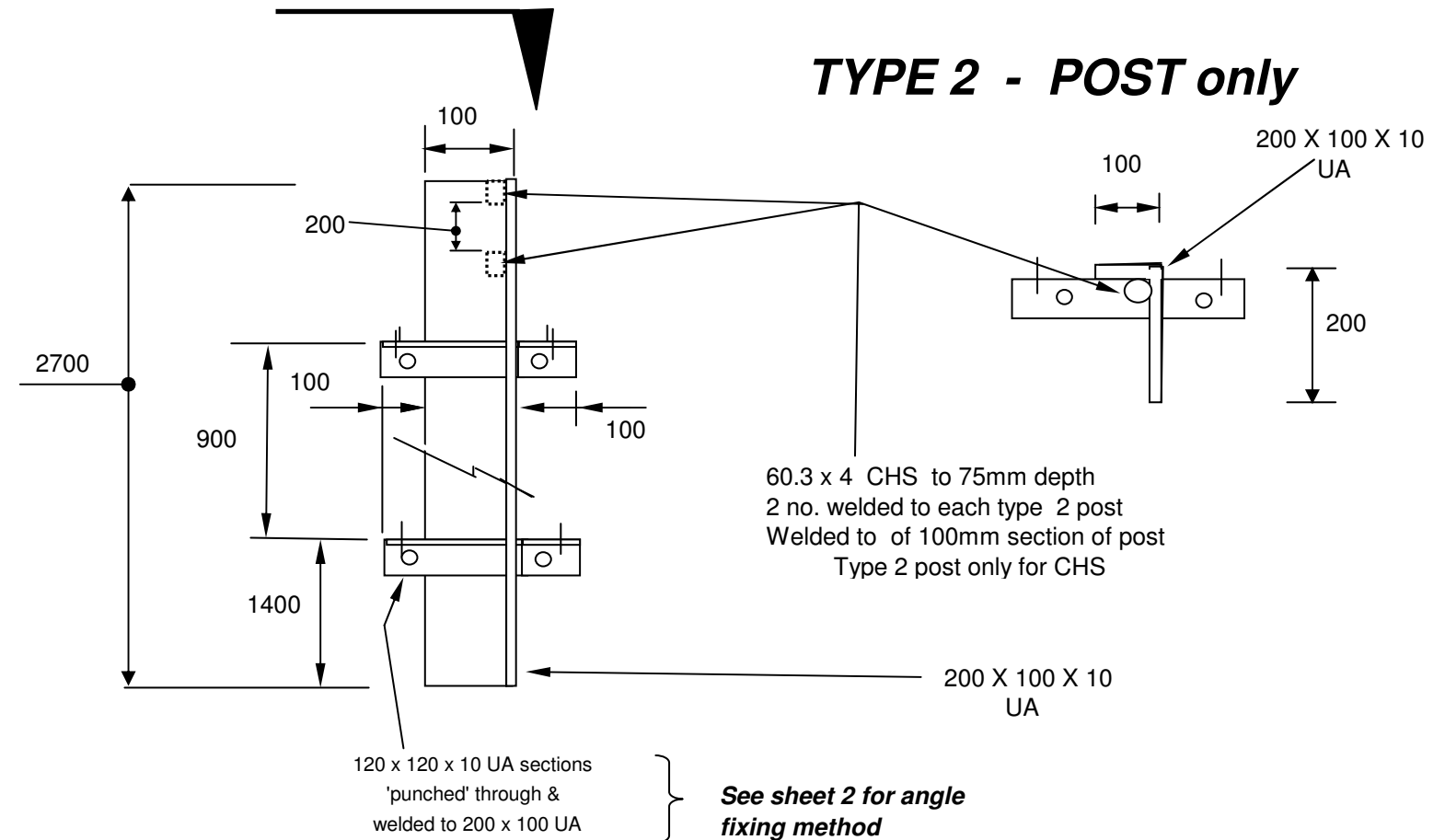

TYPE 2 - POST

NOT TO SCALE

DO NOT SCALE

Method of fixing/welding of 120 x 120 x 10 angles to 200 x 100 x 10 angle post

Shaped 'slot' to be cut or punched (NOT 'flame cut') into the 200 long leg of the 200 x 100 x10 'Unequal Angle' post. A 300 mm. Long segment of 120 x 120 x10 E.A. is to be fitted through the above 'slot', such that 100 mm. cantilever beyond the post to support long rails.

• 4 mm. Leg length continuous fillet welds should be placed / deposited along all intersection 'lines' of 120 angle with post

• 16mm diameter grade 8.8 bolts, should be used to connect stub cantilever & end of rail. A minimum of 2 no. bolts at each connection, 1 no. Bolt through vertical leg, another bolt through horizontal leg of the 'Equal Angles'.

REQUIRED ITEMS LIST - NUMBER AND TYPE

Areaview 13 Prince Albert Road NW1 7SR
SK ES 02.19-6-15 Post & Rails E/S
SHEET 3 OF 3

Requirements List:

Quantity of each

- | | |
|----|--|
| 6 | A. Type 1 post - 200 x 100 x 10 UA |
| 9 | B. Type 2 post - 200 x 100 x 10 UA |
| 20 | C. Horizontal rails - 120 x 120 x 10 Angle @ 2800 long
- Drilled to suit 120 x 120 x 10 welded angles to post types 1 & 2 - |
| 90 | D. Nuts, bolts and washers, 8.8. grade, 16mm, 40mm threaded length |
| 4 | E. 120 x 120 x 10 angle, undrilled, plain section @ 3300 long |
| 20 | F. Transverse web stiffner plates - 10 mm thick to suit 203 UC 52, for site fixing/welding |
| 10 | G. 170 x 220 x 12 thick MS plate |