

01: PROPOSED GROUND FLOOR PLAN
SCALE 1:50

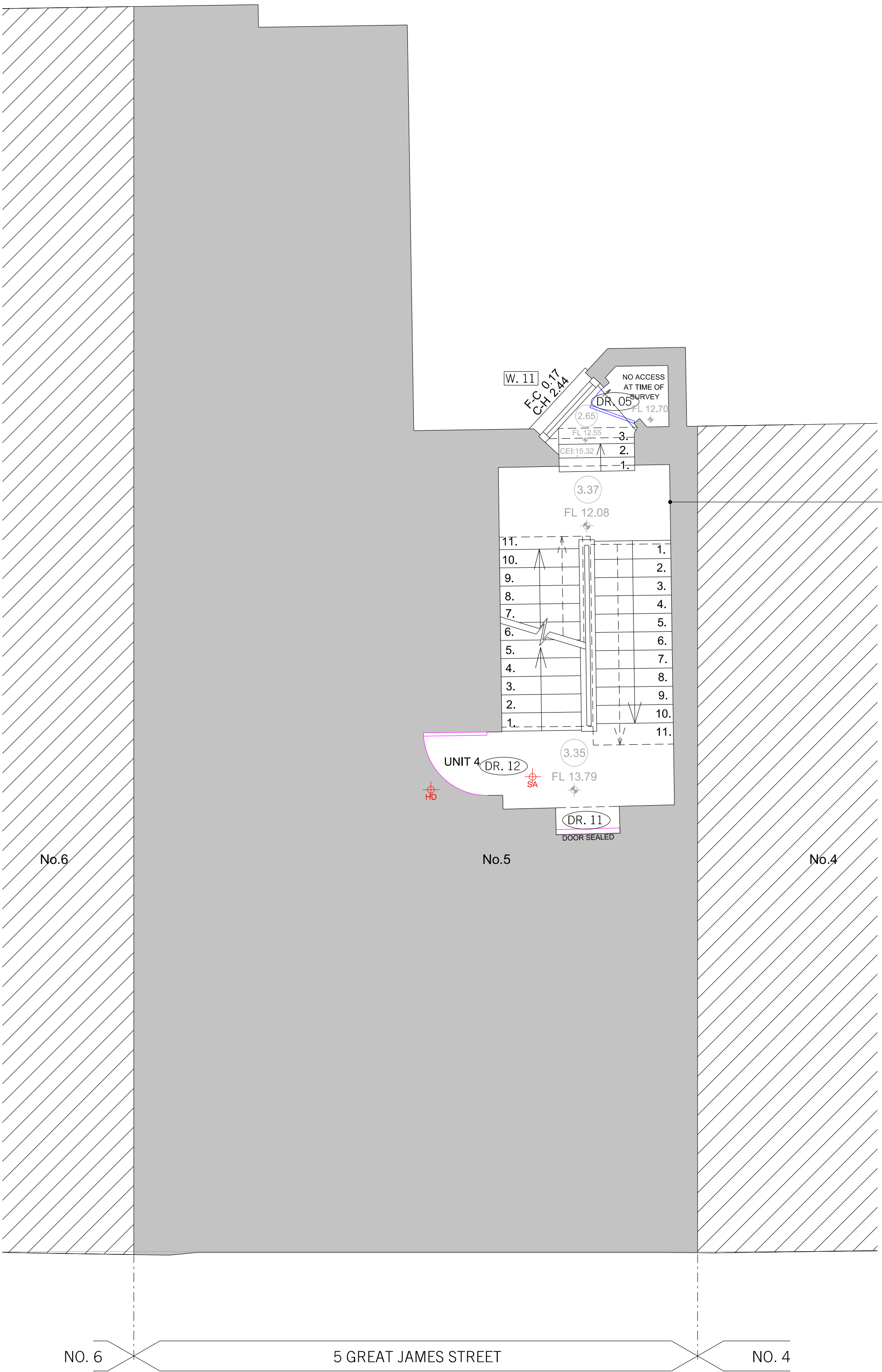

02: PROPOSED FIRST FLOOR PLAN
SCALE 1:50

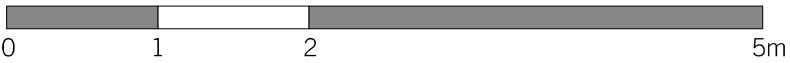
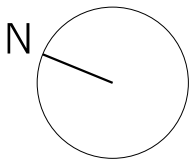

- KEY
- SA SMOKE ALARM, MAINS WIRED / BATTERY BACK-UP, RADIO LINKED.
 - HD HEAT DETECTOR ALARM, MAINS WIRED / BATTERY BACK-UP, RADIO LINKED.
 - ALL INSTALLED TO BS:5839 P+6:2013
 - FB WALL MOUNTED FIRE BLANKET
 - EXISTING CEILING HEIGHT
 - EXISTING FLOOR LEVEL
 - NEW 4-PANEL 30 MINUTE DOOR
 - NEW 6-PANEL 30 MINUTE DOOR

| | | | |
|------|----------|---------------------------------|---------|
| A | 17.08.17 | AMENDMENTS FOR HISTORIC ENGLAND | AT |
| REV. | DATE | REASON FOR ISSUE | CHK. BY |

NOTE:
- USE FIGURED DIMENSIONS ONLY.
- ALL DIMENSIONS TO BE CHECKED ON-SITE.
- ANY DISCREPANCIES BETWEEN CONSULTANT DRAWINGS TO BE REPORTED TO THE ARCHITECT BEFORE ANY WORK COMMENCES.
- MATTHEW SPRINGETT ASSOCIATES ©

MSA
MATTHEW SPRINGETT ASSOCIATES Ltd.
70 HATTON GARDEN
LONDON EC1N 8JT
T+44 (0)20 7692 5950
F+44 (0)20 7692 5951

CLIENT
HATTON GARDEN PROPERTIES LTD.

PROJECT
THIRD FLOOR FLAT
5 GREAT JAMES STREET

TITLE
GENERAL ARRANGEMENT:
PROPOSED GROUND AND FIRST
FLOOR PLANS

| | | | |
|------------|---------|----------|---------|
| DATE | JOB NO. | DRAWN BY | PURPOSE |
| 03.07.17 | 177 | KS | PL. |
| SCALE @ A1 | NUMBER | REV. | |
| 1:50 | 177-210 | A | |