

FLOOR FINISHES KEY

-  FF09B 1000 x 1000 Green woven tile
-  FF10B 1000 x 1000 Light grey woven tile
-  FF11B 1000 x 1000 Dark grey woven tile
-  FF12 Blue carpet
-  FF14 Polished concrete flooring TBC
-  FF15 - Surestep Stone Blue Concrete 17132
-  FF16 - Staffroom flooring Carpet -TCT 5092 Azzuri Halifax
-  Transition Strips Gradus ETR302UFO DWG Ref: ST-K21-01 Rev B

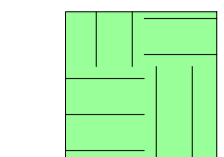
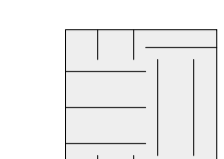
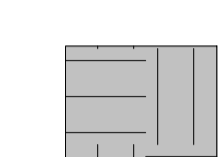
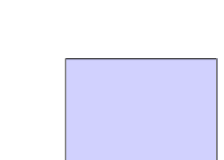
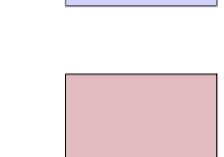
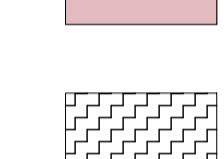
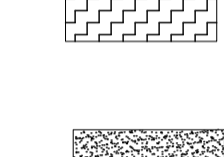
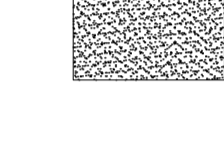
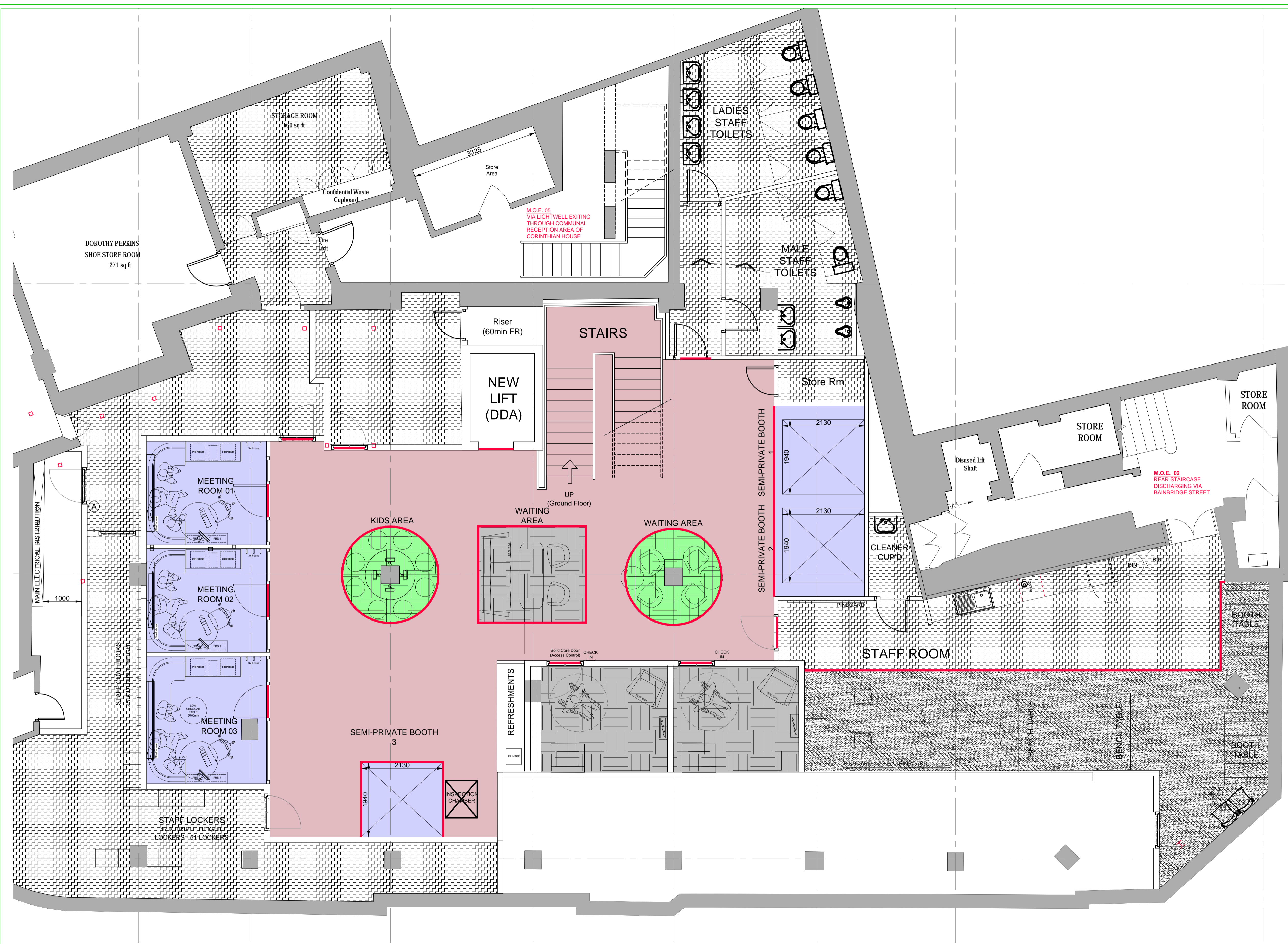

A	03/08/2017	PLANNING ISSUE	RA
REV	DATE	REVISION	INITIALS

LLOYDS BANKING GROUP

ALL DIMENSIONS TO BE VERIFIED PRIOR TO COMMENCING WORK. DRAWING TO BE READ IN CONJUNCTION WITH PROJECT SPECIFICATIONS.

THIS DRAWING IS THE PROPERTY OF LLOYDS BANKING GROUP AND COPYRIGHT IS RESERVED BY THEM. THE DRAWING IS ISSUED ON CONDITION THAT IT IS NOT COPIED OR DISCLOSED BY OR TO ANY UNAUTHORISED PERSONS WITHOUT PRIOR CONSENT IN WRITING TO LLOYDS BANKING GROUP - GROUP PROPERTY. ALL MODIFIED DRAWINGS SHOULD BE RETURNED TO LLOYDS BANKING GROUP.

GROUP PROPERTY

BRISTOL - PO Box 112, Canons House, Canons Way, BRISTOL, BS99 7LB
 EDINBURGH - Sighthill South, 12 Bankhead Crossway South, EDINBURGH, EH11 4EN
 HALIFAX - Trinity Road, HALIFAX, West Yorkshire, HX1 2RG

PROJECT ADDRESS	SCALE
Halifax 118-132, New Oxford Street West End LONDON, WC1A 1HL	A1 - 1:50 A3 - 1:100
DRAWING DESCRIPTION	DATE
Basement Plan Floor Finishes PLANNING	05.05.2017
DRAWING NUMBER	DRAWN BY
50941725-AR01-B1-0601-PL	RA
	REVISION
	A