

1:50  
Longitudinal  
section  
through  
Lightwell

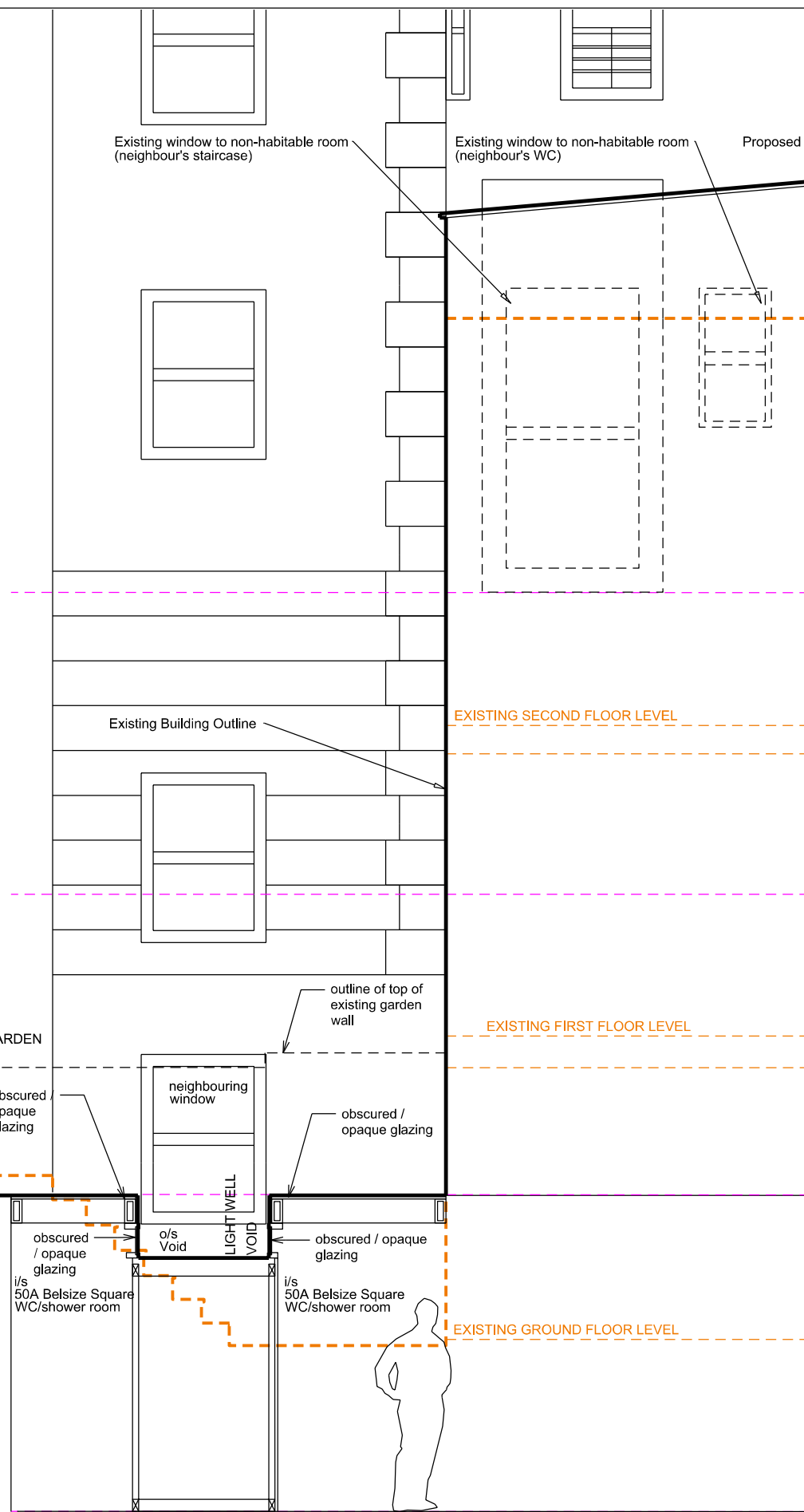

1:20 Longitudinal  
section through  
Lightwell

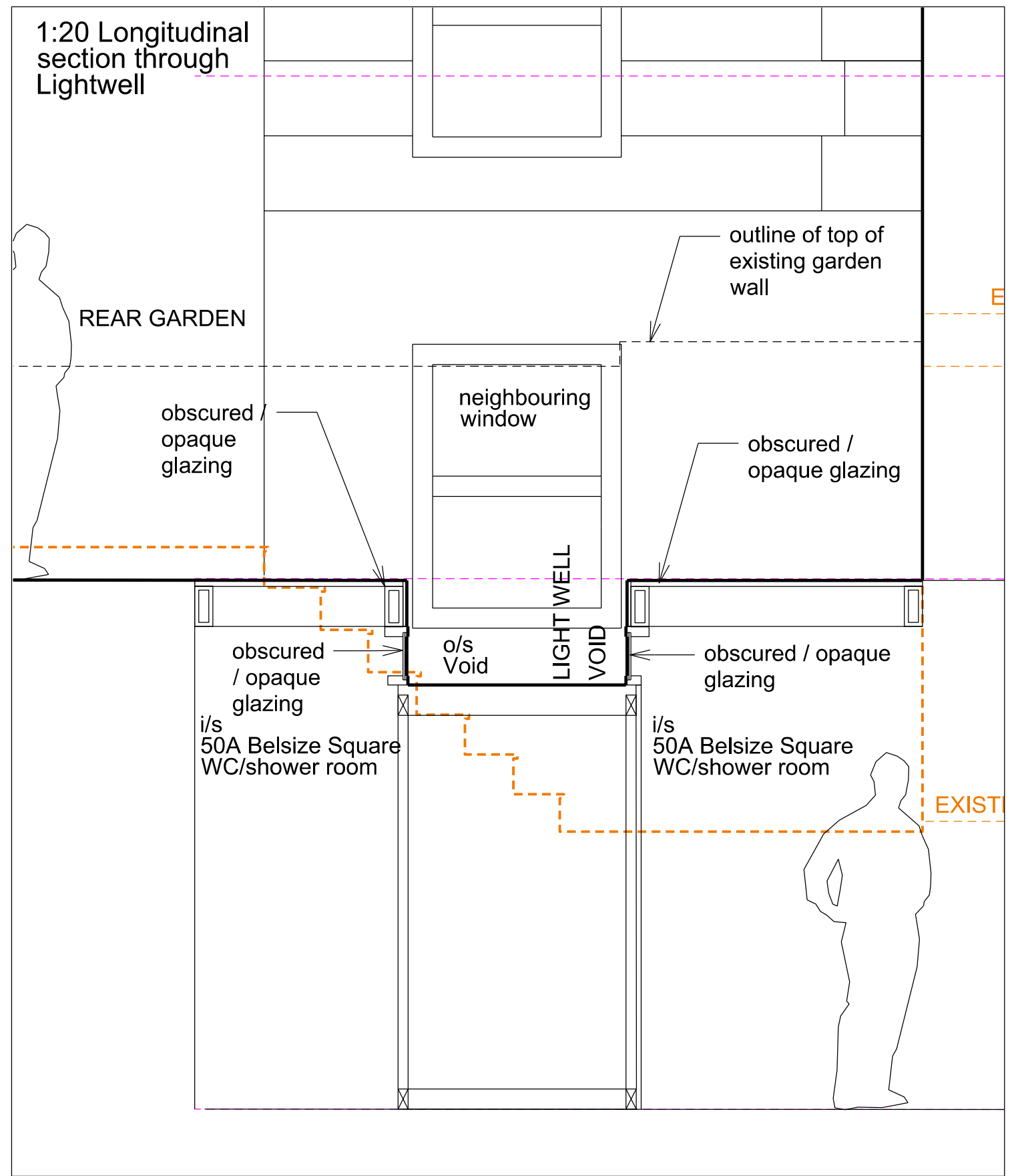

Notes:	Revision:	<b>Studio Gil LTD</b> Floor 5 Hannibal House Elephant & Castle Shopping Centre London SE1 6TE T: +44(0)207 6177 932 E: mail@studio-gil.com	Project: THE COACH HOUSE, 50A BELSIZE SQUARE, LONDON NW3 4HN		
<small>This drawing is to be read in conjunction with all related drawings. Do not scale from this drawing.          All dimensions must be checked and verified on site before commencing any work or producing shop drawings.          The originator should be notified immediately of any discrepancy.          This drawing is copyright and remains the property of Studio Gil LTD and is not to be reproduced without permission.</small>			Drawing Title: Proposed Longitudinal Section through lightwell Drawing Number: 1507_PL_014 Scale: 1:50 and 1:20 @ A3 Date: August 2017 Revision: -		
		Status: <input checked="" type="checkbox"/> for information <input type="checkbox"/> for tender <input type="checkbox"/> for construction			