

PCC RECTANGULAR INSPECTION CHAMBER - PLAN

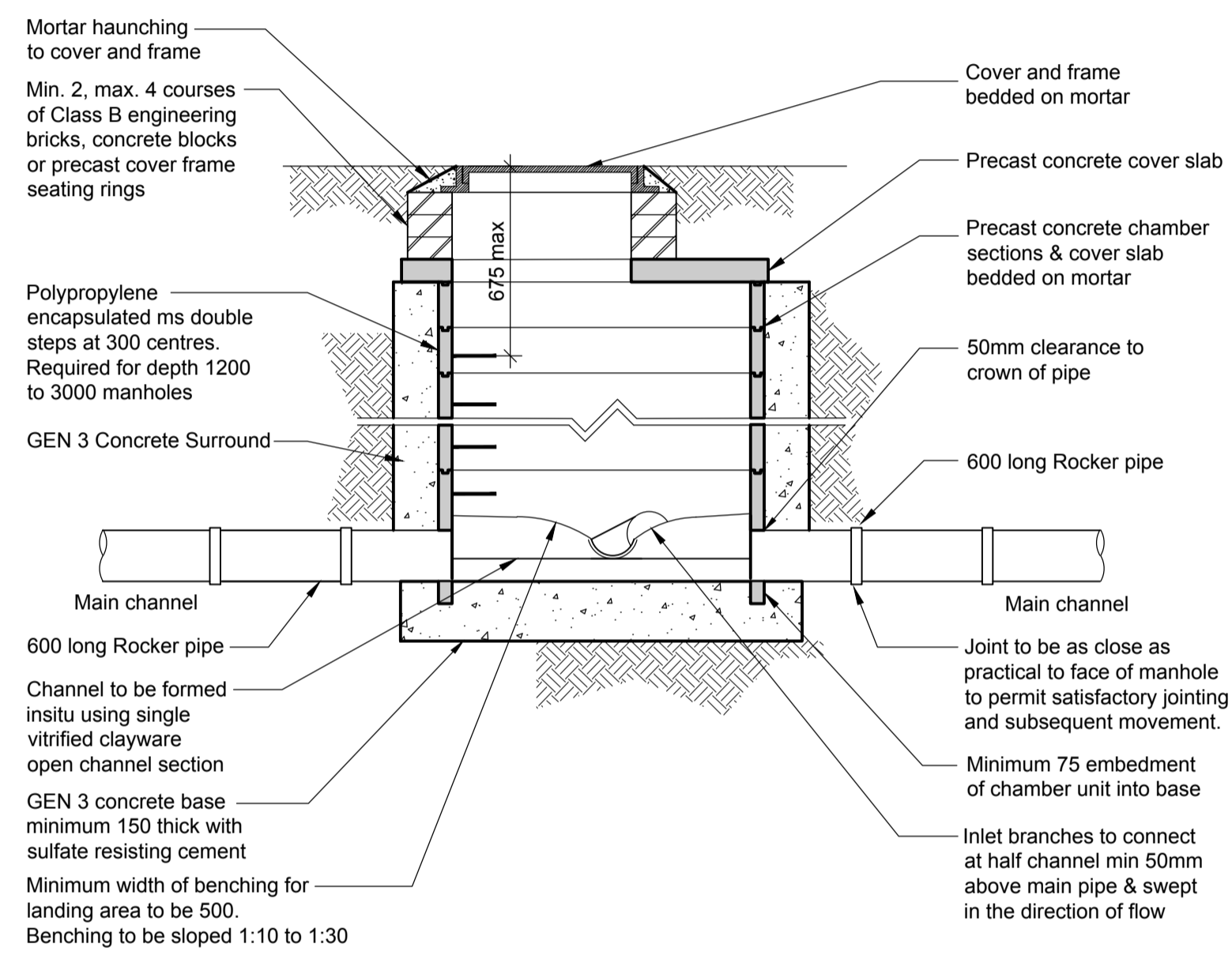

PCC RECTANGULAR INSPECTION CHAMBER (REFER TO SCHEDULE FOR CHAMBER SIZE)

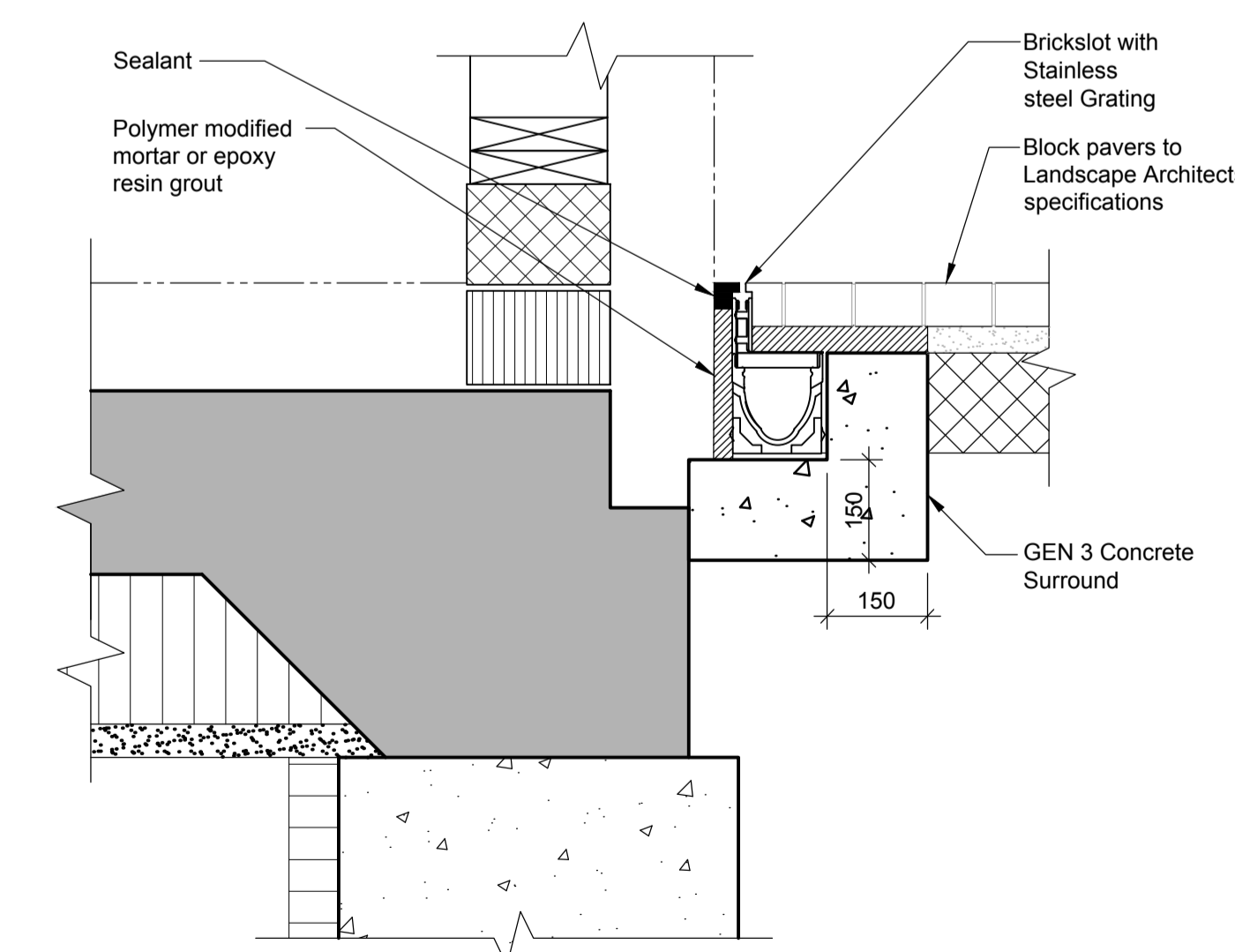

LINEAR SLOT DRAIN AT THRESHOLD DETAIL
SCALE 1:10

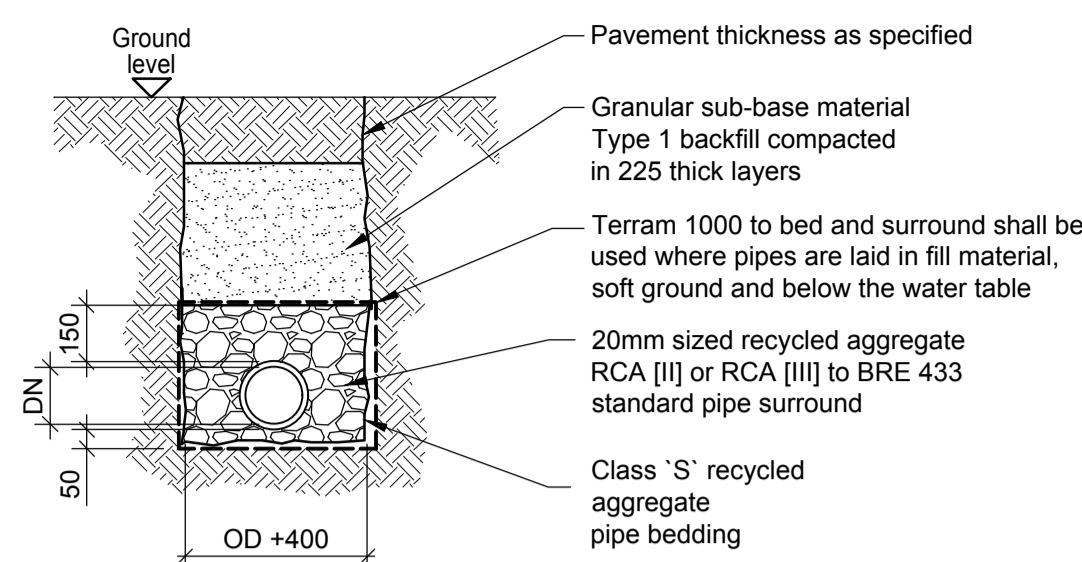

CLASS S RECYCLED AGGREGATE BEDDING PIPE BEDDING & BACKFILL UNDER CARRIAGEWAY DETAIL [For Vitrified Pipes]

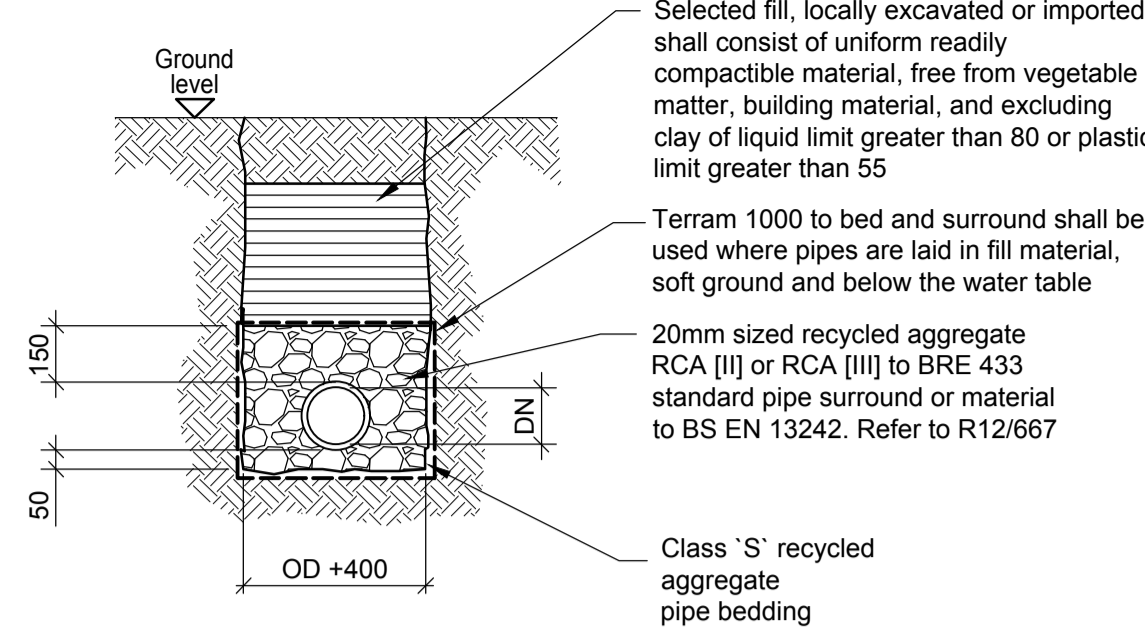

CLASS S RECYCLED AGGREGATE BEDDING PIPE BEDDING & BACKFILL UNDER VERGE DETAIL [For Vitrified Pipes]

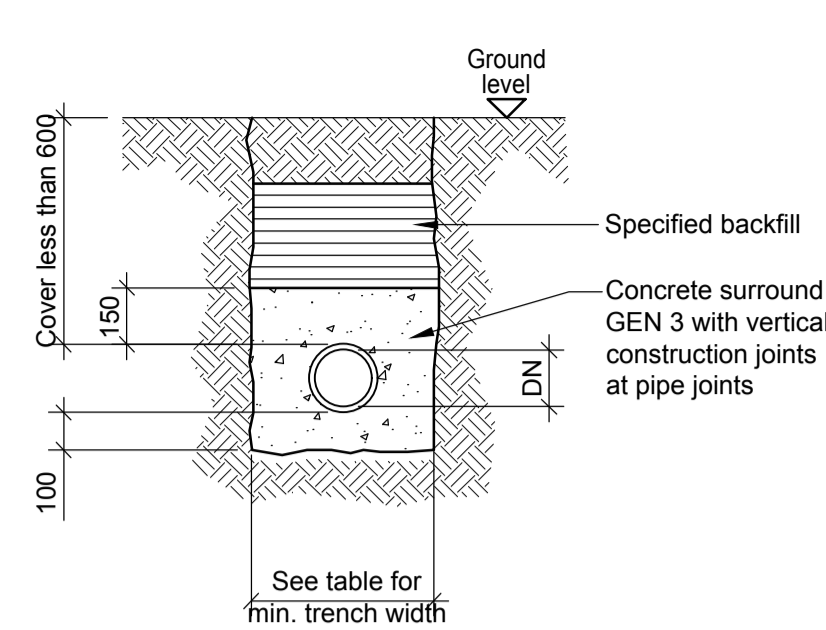

CLASS Z BEDDING CONCRETE PIPE BEDDING SURROUND DETAIL

- Notes :**
- This drawing is to be read in conjunction with all relevant Architect's, Engineer's and specialists' drawings and specifications.
 - Do not scale from this drawing in either paper or digital form. Use written dimensions only. To check that this drawing has been printed to the intended scale this bar should be 50mm long @ A1 or 25mm long @ A3.
 - Health & Safety :** All specific drawing notes are to be read in conjunction with the project "Information Pack" and "Site Rules".

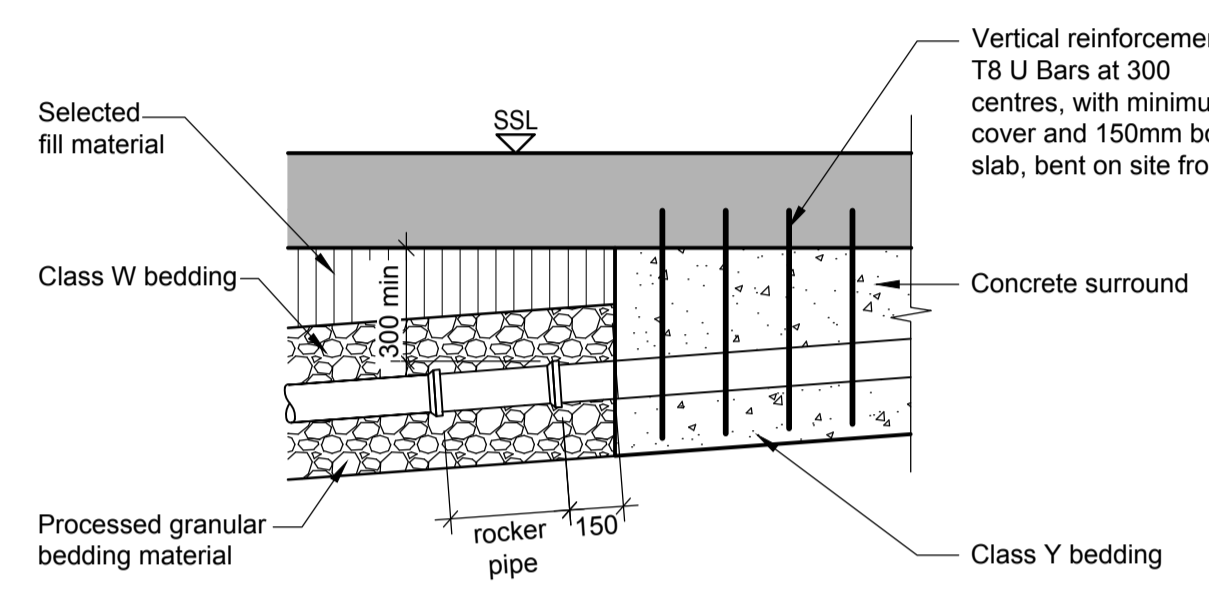

TYPICAL DETAIL FOR PIPELINES UNDER SLABS CLASS Y AND W BEDDING

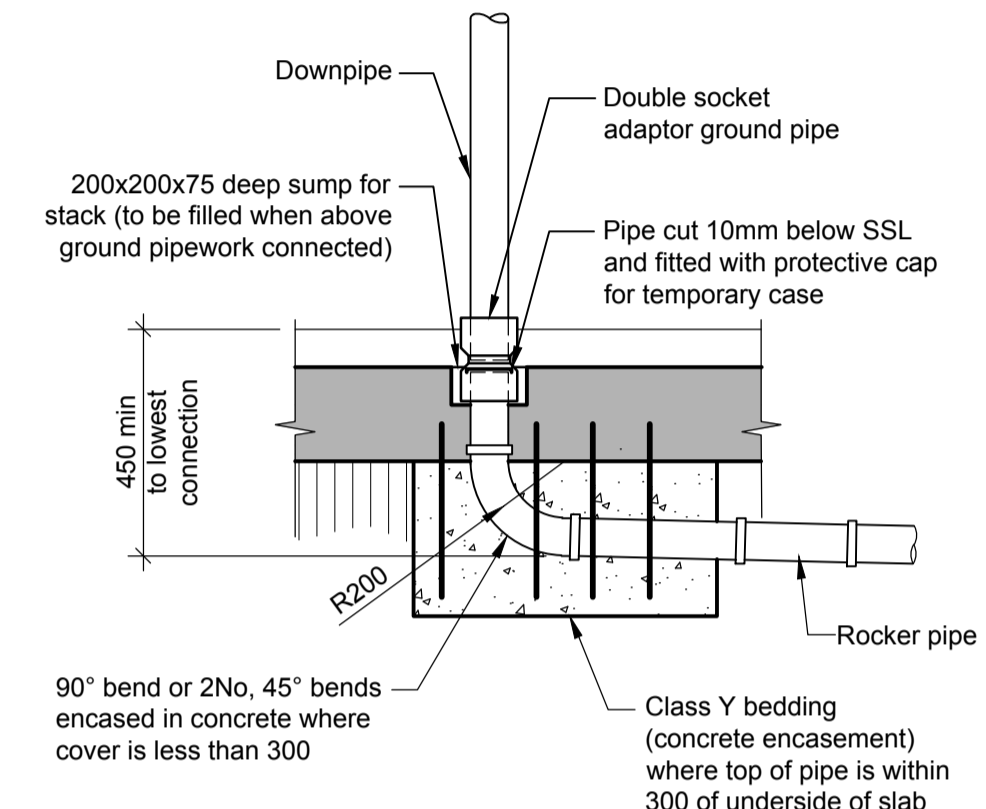

TYPICAL FOUL STACK DETAIL

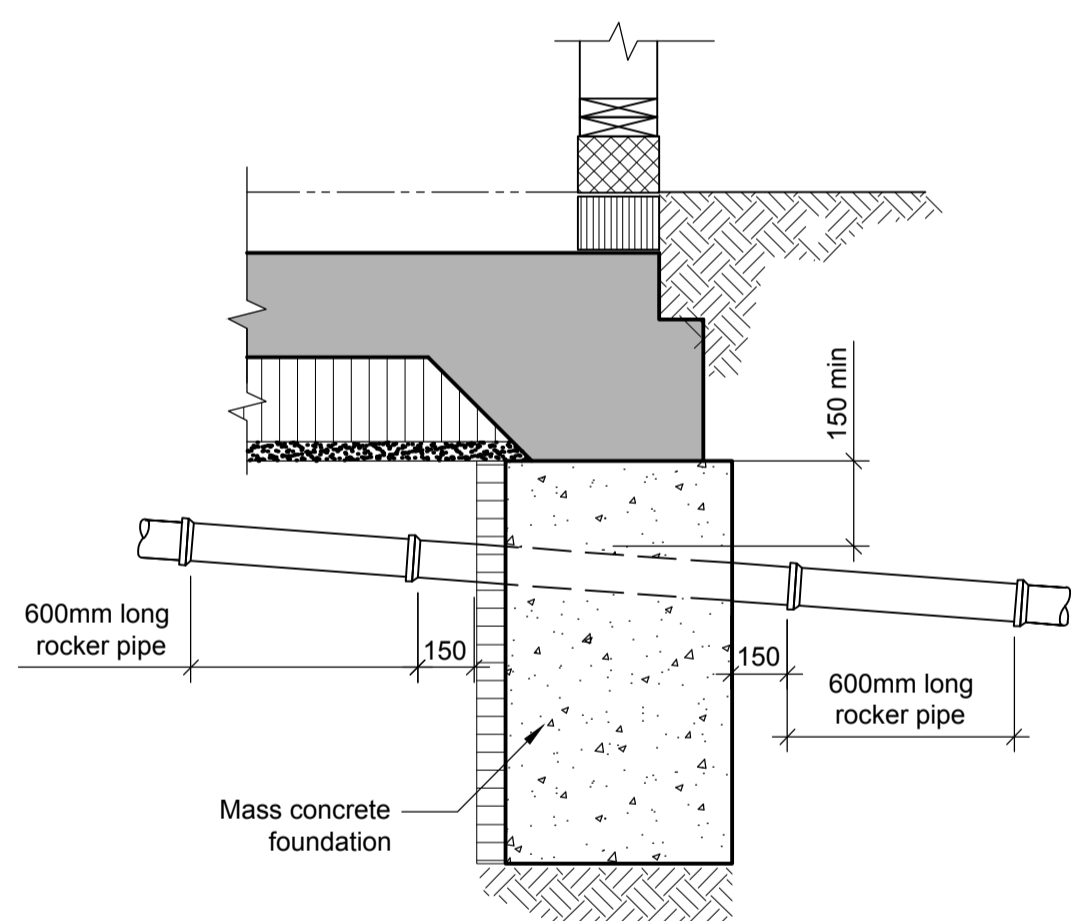

DRAIN CAST INTO FOUNDATION

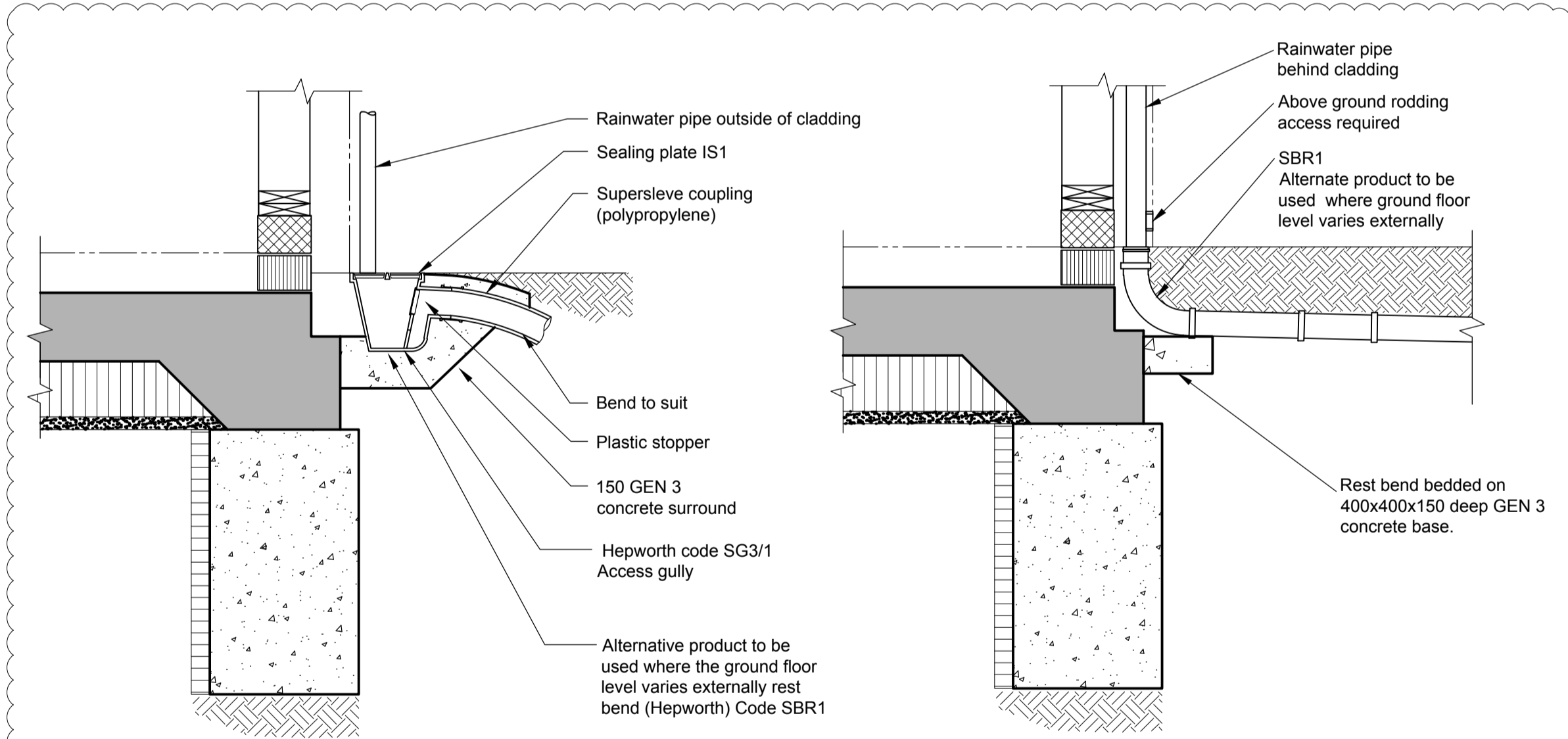

RAINWATER ACCESS GULLY CONNECTION

RAINWATER DOWN PIPE TO DRAIN (SURFACE WATER SYSTEM)

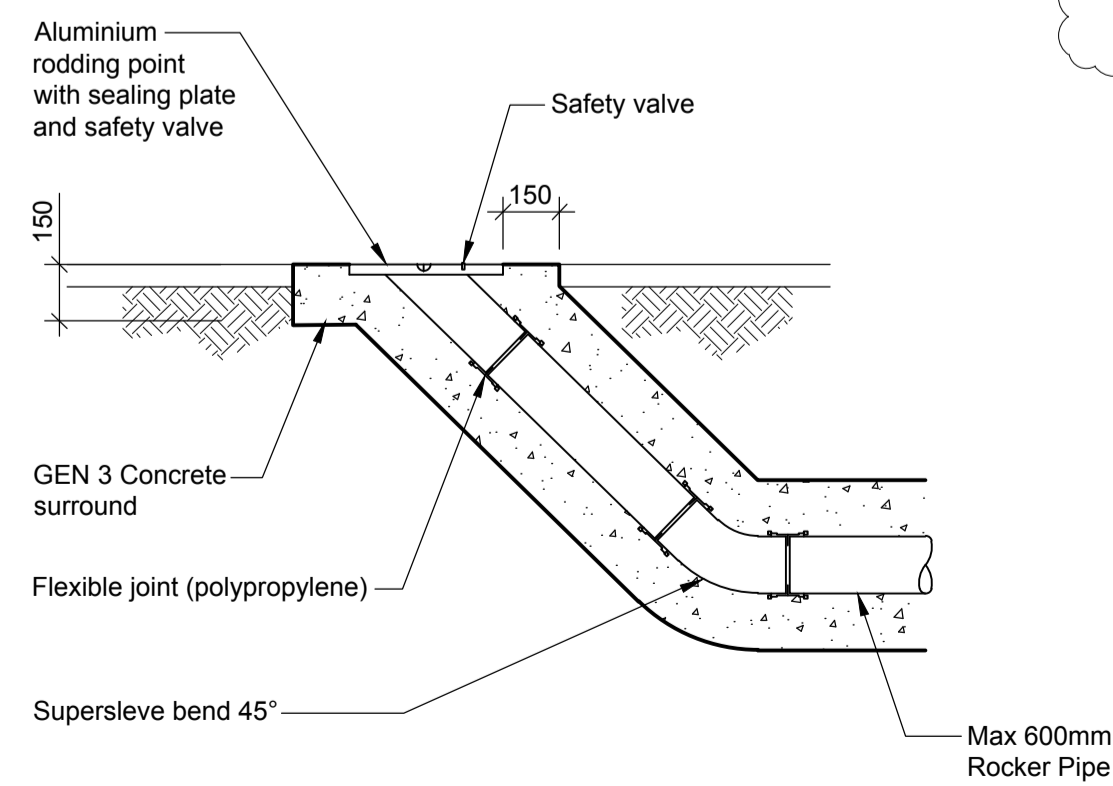

RODDING EYE

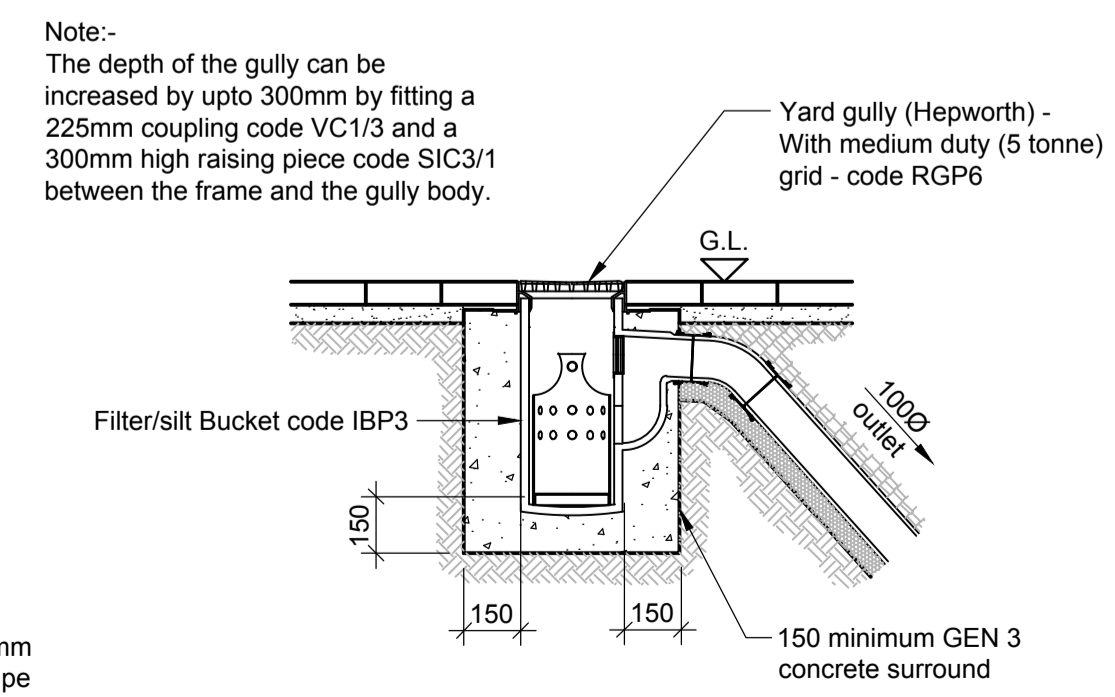

YARD GULLY

Ver	Date	Drawn	Eng	Amendment
4	04.08.17	AH	JZ	Issued for Construction
3	01.08.17	DLA	JZ	Issued for Construction
2	02.05.17	SK	JZ	Issued for Tender
1	21.04.17	DLA	JZ	Issued for Draft Tender

KINGSGATE PRIMARY SCHOOL, NW6 4LB

BELOW GROUND DRAINAGE DETAILS

Status **FOR CONSTRUCTION**

Drawn	DLA	Eng	JZ
Scales	1:20 at A1	1:40 at A3	
Drawing No	24220.002-610	Ver	4