

Specification

Aluminium 6063T6 alloy to BS EN 755 standard, powder coated to BS 6496 to 60 micron finish.
Aluminium Finish: White.
Sub-Frame: Primed high quality, environmentally certified (MTCS) engineered timber.
Glazing: All frames are factory glazed in 8.8mm Clear Acoustic Laminated glass.
Gasket colour: White.
DN Acoustic ventilators to bottom subframe.

In line with our company policy of continuous product development and improvement, Granada reserves the right to make minor alterations to specification without notice.

Approved Drawing	
Approved by:	Print Signature
Date:	

Drawing Title: Listed Building Consent for HS2 Secondary Glazing

Project: 34 Park Village East

Client: CSJV

Scale: As Noted 1st issue date: 18.05.17.

Drawn by: MW Checked: RH

Drawing Number: P2229-PVE34-02-01-P

Rev	Date	Notes
-	18.05.17	First issue of drawings

This drawing belongs to the above company and no unauthorised copy or disclosures can be made by or to a third party and be returned whenever required.

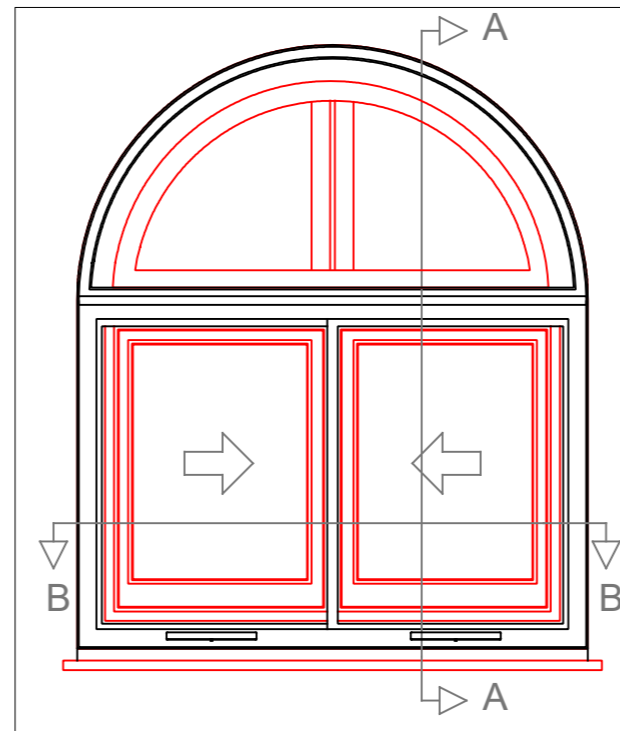
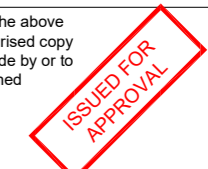

PROPOSED ELEVATION - PVE34-02-01
(FRONT BEDROOM)
WITH SECONDARY GLAZING AND
ACOUSTIC VENTS
(SCALE 1:20 @ A3)

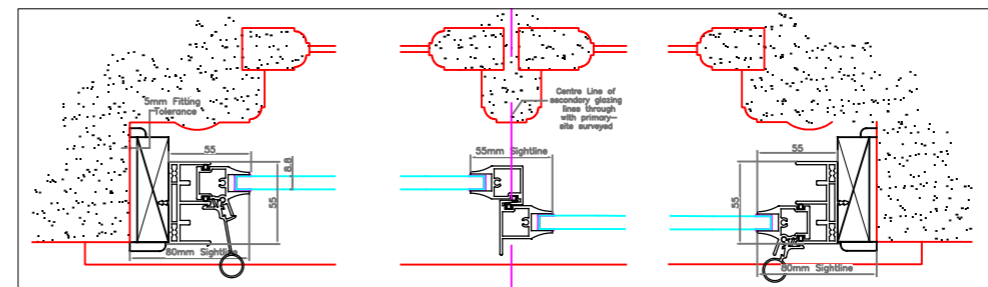

HORIZONTAL SECTION - PVE34-02-01
(SCALE 1:5 @ A3)

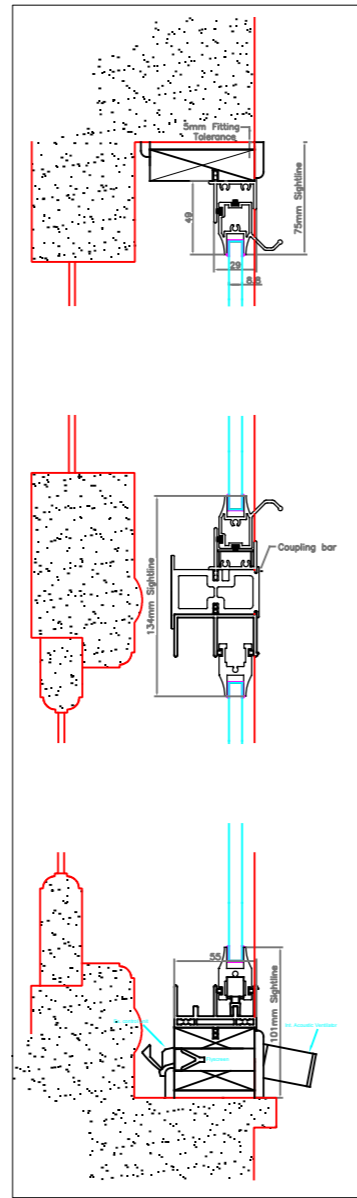

VERTICAL SECTION - PVE34-02-01
(SCALE 1:5 @ A3)

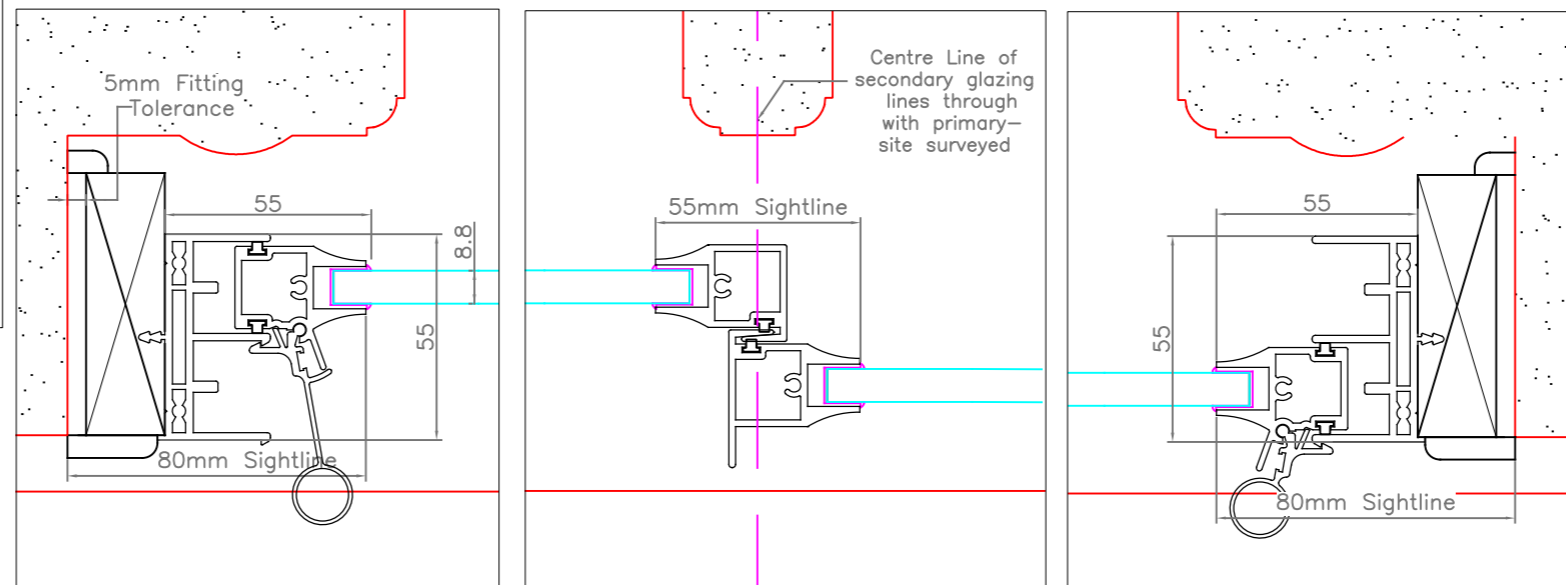

HORIZONTAL SECTION B-B - PVE34-02-01
INC. PROFILE DETAILS
(SCALE 1:2 @ A3)

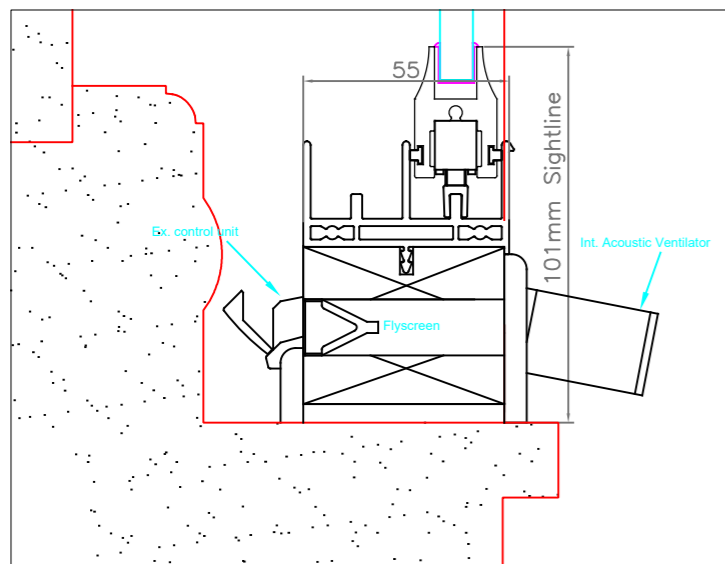
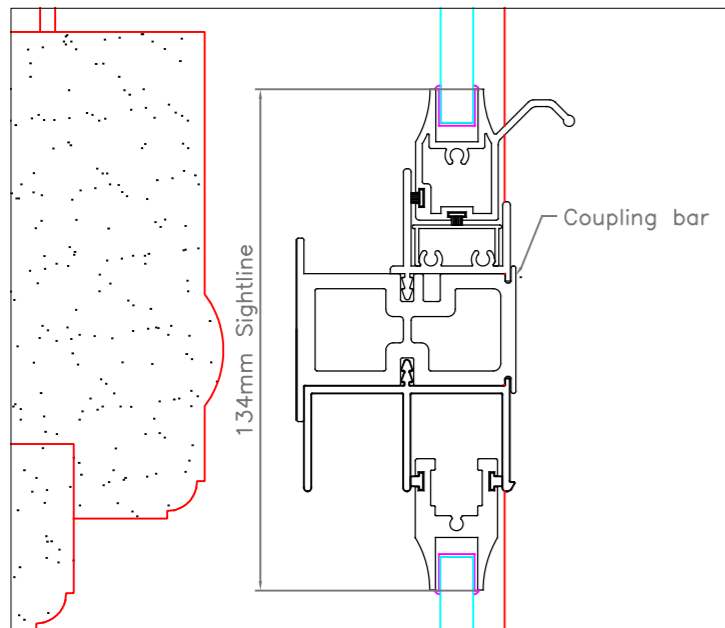
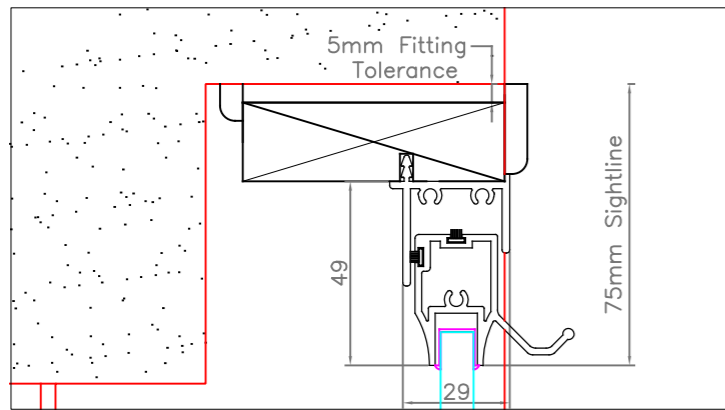

VERTICAL SECTION A-A - PVE34-02-01
INC. PROFILE DETAILS
(SCALE 1:2 @ A3)

