

01 Typical Detail through GMP Glazing Base  
 21\_528 Refer to Drawing 21\_100

**Notes**

Contractor to check all dimensions on site. Do not scale from this drawing. Stanton Williams to be advised of any variation between the drawings and site conditions.

© Stanton Williams. All rights described in Chapter IV of the Copyright, Designers and Patents Act 1998 have been asserted.

To be read in conjunction with the specification and all relevant drawings.

**Materials Key**

- ALEX Aluminium extrusion
- ALPR Aluminium pressing
- BAL-01 Balustrade to L2 terrace
- BR-01 Fair faced brickwork (F10/110)
- BR-02 Running course brickwork (F10/112)
- BR-03 English bond brickwork (F10/115)
- DR-01 Main entrance doors (H11/200)
- DR-02 Louvered hinged doors to substation (H31/140)
- DR-04 Automated bi-fold metal doors (L20/150)
- EWS-A Curtain walling, north (H11/110)
- EWS-B Curtain walling in brickwork (H11/120)
- EWS-C Structural glazing, Ground Floor (H11/130)
- EWS-D Structural glazing/doors, Outpatients terrace (H11/140)
- EWS-E Curtain walling, GMP north and south (H11/150)
- EWS-F Metal panel cladding, GMP east and west (H31/112)

- EWS-G Flush curtain walling, Outpatients north (H11/160)
- EWS-H Flush glazing in brickwork (H11/170)
- LSF Lightweight steel framing (G10/140)
- LVR-01 Weather-proof louvered metal screens (H31/142)
- LVR-02 External plant room louvres (H31/145)
- LVR-03 Enclosed plant room louvres (H31/148)
- MFL Metal facade panels, integrated doors/louvres (H31/110)
- PC-C Precast concrete cladding (H40/110)
- RFL-01 Main atrium rooflight (H10/110)
- RFL-02 Outpatients rooflight (H10/120)
- TR-01 Terracotta cladding, piers (H55/110)
- TR-02 Terracotta coping (H55/120)
- TR-03 Terracotta cladding, flat panels (H55/130)
- TR-04 Terracotta eills (H55/140)
- Movement joint (F30/610)

Revision	Date	Description
PO	14.07.17	Planning Issue

**Location**

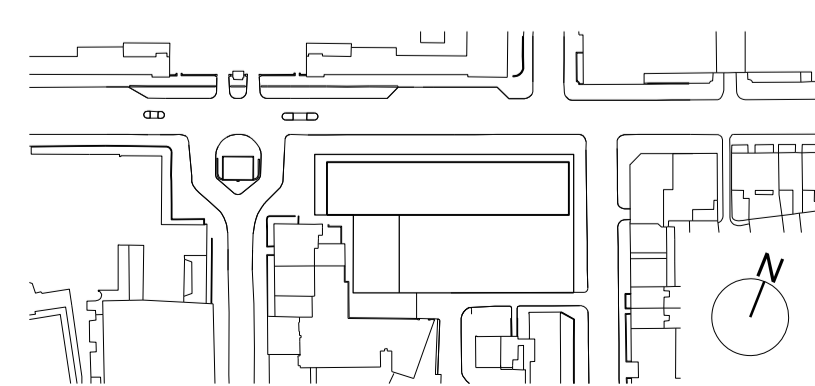

Stanton Williams  
 36 Graham Street  
 London N1 8GJ  
 Phone +44 (0)20 7880 6400  
 Email 464@stantonwilliams.com  
 www.stantonwilliams.com



**Project**  
 Zayed Centre for Research  
 into Rare Disease in Children

**Drawing Title**  
 External Wall  
 Section Details  
 North Elevation  
 GMP Glazing Base Detail

Date	Scale @ A1(A3)	Status	Project No.	Drawing No.	Revision
06/02/2015	1:5 (1:10)	Planning	464	21_528	PO
<b>Drawn</b>	<b>Checked</b>	<b>Approved</b>			
LO	KI	GH			