

REFER TO DRAWINGS 90_450 & 90_451 FOR CAPPING BEAM DETAILS

01 Typical ground floor glazing detail to Lab A
21_520 Refer to drawing 21_100

Notes

Contractor to check all dimensions on site. Do not scale from this drawing. Stanton Williams to be advised of any variation between the drawings and site conditions.
© Stanton Williams. All rights described in Chapter IV of the Copyright, Designers and Patents Act 1998 have been asserted.
To be read in conjunction with the specification and all relevant drawings.

Materials Key

- ALEXT Aluminium extrusion
- ALPR Aluminium pressing
- BAL-01 Bolustrade to L2 terrace
- BR-01 Fair faced brickwork (F10/110)
- BR-02 Running course brickwork (F10/112)
- DR-01 Main entrance doors (H11/200)
- DR-02 Louvered hinged doors to subsidence (H31/140)
- DR-04 Automated 3-fold metal doors (L20/150)
- EWS-A Curtain walling, north (H11/110)
- EWS-B Curtain walling in brickwork (H11/120)
- EWS-C Structural glazing, Ground Floor (H11/130)
- EWS-D Structural glazing/doors, Outpatients terrace (H11/140)
- EWS-E Curtain walling, GMP north and south (H11/150)
- EWS-F Metal panel cladding, GMP east and west (H31/112)

- EWS-G Flush curtain walling, Outpatients north (H11/160)
- EWS-H Flush glazing in brickwork (H11/170)
- LSF Lightweight steel framing (G10/140)
- LVR-01 Weather-proof louvered metal screens (H31/142)
- LVR-02 External plant room louvres (H31/145)
- MTL Metal facade panels, integrated doors/louvres (H31/110)
- PR-C Precast concrete cladding (H42/110)
- RFL-01 Main atrium rooflight (H10/110)
- RFL-02 Outpatients rooflight (H10/120)
- TR-01 Terracotta cladding piers (H55/110)
- TR-02 Terracotta coping (H55/120)
- TR-03 Terracotta cladding, flat panels (H55/130)
- TR-04 Terracotta cills (H55/140)
- Movement joint (F30/610)

Revision	Date	Description
PO	16.08.17	Planning Issue

Location

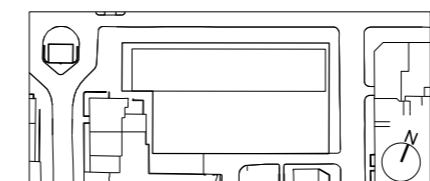

Stanton Williams
36 Graham Street
London N1 8GU
Phone +44 (0)20 7880 6400
Email 464@stantonwilliams.com
www.stantonwilliams.com



Project			Drawing Title		
Centre for Research into Rare Disease in Children at Great Ormond Street Hospital			External Wall Section details North elevation Ground floor glazing to Lab A		
Date	Scale @ A3	Status	Project No.	Drawing No.	Revision
06/02/15	1:5	Planning	464	21_520	PO
Drawn	Checked	Approved			
EM	KI	GH			