

01 Lab A glazing and brickwork Interface  
 21\_301 Refer to drawing 00\_309

**Notes**

Contractor to check all dimensions on site. Do not scale from this drawing. Stanton Williams to be advised of any variation between the drawings and site conditions.  
 © Stanton Williams. All rights reserved in Chapter IV of the Copyright, Designers and Patents Act 1998 have been asserted.  
 To be read in conjunction with the specification and all relevant drawings.

**Materials Key**

ALEX	Aluminium extrusion
ALPR	Aluminium pressing
BAL-01	Balustrade to L2 terrace
BR-01	Fair faced brickwork (F10/110)
BR-02	Running course brickwork (F10/112)
DR-01	Main entrance doors (H11/200)
DR-02	Louved hinged doors to substation (H31/140)
DR-04	Automated sliding metal doors (L20/150)
EWS-A	Curtain walling, north (H11/110)
EWS-B	Curtain walling in brickwork (H11/120)
EWS-C	Structural glazing, Ground Floor (H11/130)
EWS-D	Structural glazing/doors, Outpatients terrace (H11/140)
EWS-E	Curtain walling, GMP north and south (H11/150)
EWS-F	Metal panel cladding, GMP east and west (H31/112)

EWS-G	Flush curtain walling, Outpatients north (H11/160)
EWS-H	Flush glazing in brickwork (H11/170)
LSF	Lightweight steel framing (G10/140)
LVR-01	Weather-proof louved metal screens (H31/142)
LVR-02	External plant room louvers (H31/145)
MTL	Metal facade panels, integrated doors/louvers (H31/110)
PR-C	Precast concrete cladding (H42/110)
RFL-01	Main atrium rooflight (H10/110)
RFL-02	Outpatients rooflight (H10/120)
TR-01	Terracotta cladding piers (H55/110)
TR-02	Terracotta coping (H55/130)
TR-03	Terracotta cladding, flat panels (H55/130)
TR-04	Terracotta cills (H55/140)
TR-05	Movement joint (F30/610)

Revision	Date	Description
P0	14.07.17	Planning Issue

**Location**

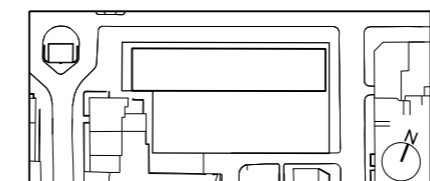

Stanton Williams  
 36 Graham Street  
 London N1 6GU  
 Phone +44 (0)20 7880 6400  
 Email 464@stantonwilliams.com  
 www.stantonwilliams.com



Date	Scale @ A3	Status	Project No.	Drawing No.	Revision
06.02.15	1:5	Planning	464	21_301	P0
Drawn	Checked	Approved			
EM	KI	GH			

**Project**  
 Centre for Research into Rare Disease in Children  
 at Great Ormond Street Hospital

**Drawing Title**  
 External wall  
 Plan details  
 Ground floor  
 Lab A glazing and brickwork Interface