

- NOTES**
1. All dimensions in millimetres unless otherwise shown.
 2. All levels in metres above Ordnance Datum (mAOD) unless reported to Employer.
 3. All dimensions to be checked on site and any discrepancies reported to Employer before pricing / work starts.
 4. Any ambiguities or discrepancies within this drawing and any other information given elsewhere must be reported to Camlins and the Employer for clarification before pricing work proceeds.
 5. All drawings to be read in conjunction with other Camlins drawings and specification information as appropriate.
 6. Refer to relevant Engineer's and Architect's information as appropriate for confirmation of all engineering and architectural details.
 7. All works to be carried out in accordance with the latest British Standards and appropriate codes of practice as a minimum.

LOCAL HIGHWAY AUTHORITY APPROVAL
 Exact details of reinstatement to Eton Avenue Adopted Highway Footway where affected by the works to be agreed with Local Highway Authority and Transport For London.

Existing ground levels to Eton Avenue carriageway to be retained

Minor regrading works to Eton Avenue Adopted Highway footway. Minor changes in ground levels to drain surface water towards gully locations (gully low points located within Essential Living land)

EXTENT OF ESSENTIAL LIVING OWNERSHIP

Existing Ground Levels
 Location of new stone channel to link gully locations. Stone channel laid flush with adjacent paved surfaces. Gully low points located within Essential Living Land

Proposed paved surface to Essential Living land. Exact details to be confirmed

Existing Building To Be Demolished

Building Frontage

DOOR THRESHOLD LOCATION
 FFL 57.425

Local Highway Authority Adopted Footway

Land Within Essential Living Ownership

Section Through Proposed Interface With Eton Avenue Footway
 Scale: 1:20 at A1

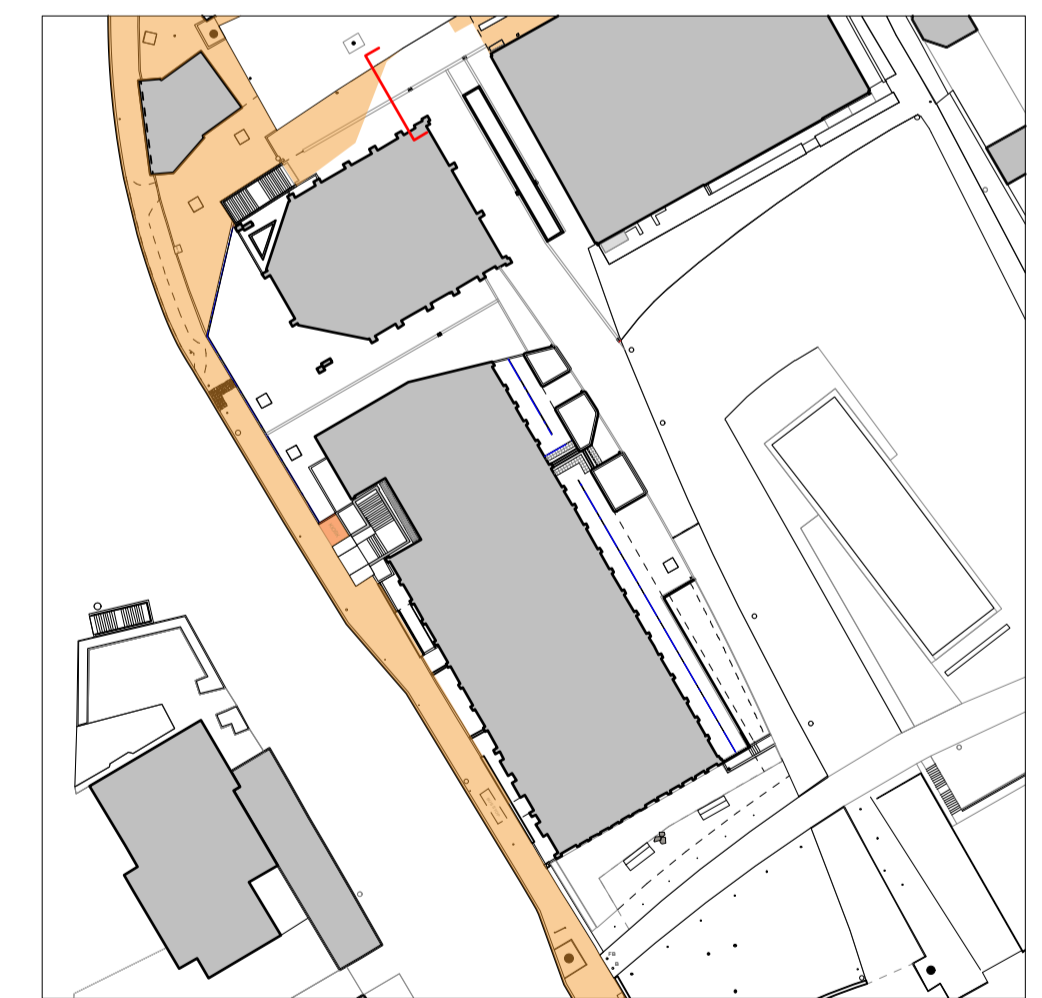

Rev.	Date	Description	Revised by	Checked by

Camlins
 New Dolanog House, Severn Road, Welshpool, Powys, SY21 7AR
 01928 554896
 www.camlins.com

100 Avenue Road, London
 Essential Living
 Section G - Condition 4 Levels At Highway Boundary

Status Planning	Drawn by JS	Checked by DWJ
Drawing Number LL443-150-0029	Revision -	Scale 1:20@A1
Date 15.08.2017		