

NOTE
 Refer to MKP drawings for Utility cupboard, kitchen and electrical layouts.
 For further Entry Equipment Please Refer to MKP Drawings.
Pendant Lights & Pendant Wiring position shown on RCP Plans. Wired connection point for possible future pendant with associated patressing. Separate switch for each Pendant.
 Structural requirements for patress TBC by SE.
 Wiring for speaker system in Living, Dining, kitchen and Master Bedroom, for future installation of speakers by customer.
 Wiring and connection point to All glazing for electrical Curtains/ Blind System.
Dimable Lights - in Living/dining and Master Bedroom.
Automated Lights - in Utility/Coat cupboards, LED Lights to all wardrobes.
Kitchen Manufacture to provide setting out of all sockets and fittings within cabinets as required. Pop up sockets in kitchens
Bathroom layouts shown indicatively only
 Refer to Detailed Bathroom Layouts drawings.

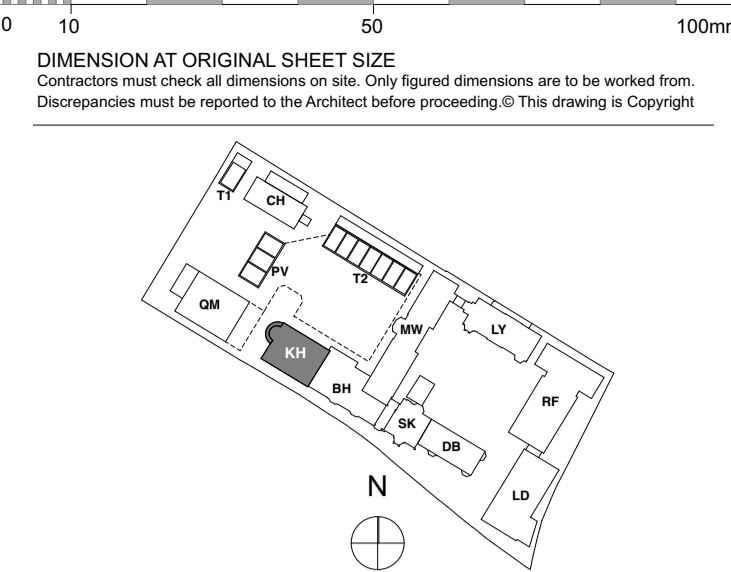

LEGEND

Lighting & Fire Alarm

- Switch
- 2 way switch
- 3 way switch
- Switch dimmer
- Pendant light
- Pendant Wiring
- Modular luminaire
- Linear Luminaire
- Single downlights
- Double directional downlights
- Wall light, internal
- Recessed low energy LED downlighter
- LED strip lighting to wardrobes & under wall units
- Wall light, external
- Recessed wall lights at floor level
- Wall light
- Single socket
- Double socket
- Shaver socket
- Video entryphone and intercom
- TV media plate. Refer to MAE specification
- BT phone & data point
- Floor recessed outlet
- Smoke detector
- Heat detector
- Extractor
- Air supply in
- Linear slot diffuser for supply & extract air
- Emergency Light
- Fire Detector
- Fire Detector Sounder base & flashing beacon
- Manual Fire alarm call point
- Thermostatic Sensor
- Access Panel
- Surface Mounted LED Circular Luminaire
- Fob Access
- Speakers
- Recessed uplighter
- Deck Mounted Light

Ceiling Info.

- Ceiling Recess
- Existing Cornice
- Proposed Cornice to match existing
- New Cornice
- Cornice segment to be removed

FOR CONSTRUCTION

REVISION	DRN	CHKD	DATE
C1 Issued for Construction	NV	TW	17/01/2017
C2 Amended as Detailed	NV	KG	03/02/2017
C3 RCPs reviewed following client's comments in workshop coordination 17.04.07	GC	TW	12/04/2017



CLIENT
 MOUNT ANVIL LTD

PROJECT
 KIDDERPORE AVENUE

DRAWING
 Kidderpore Hall
 Level LG RCP

SCALE	1:50 @ A1	DATE	April 2017
DRAWING No.	15 230	DRAWN BY	NV
	9000-DRG-23KH-LG030	REV	REV
		C3	

A & Q PARTNERSHIP (LONDON) LTD
 THE LUX BUILDING, 2-4 HOXTON SQUARE, LONDON N1 6 NU
 Tel: 020 7613 2244 Fax: 020 7613 2642 Email: london@aqp.co.uk
 ARCHITECTURE DESIGN MASTERPLANNING INTERIORS