

EXTRACT OF KH_LEVEL UG 1:50

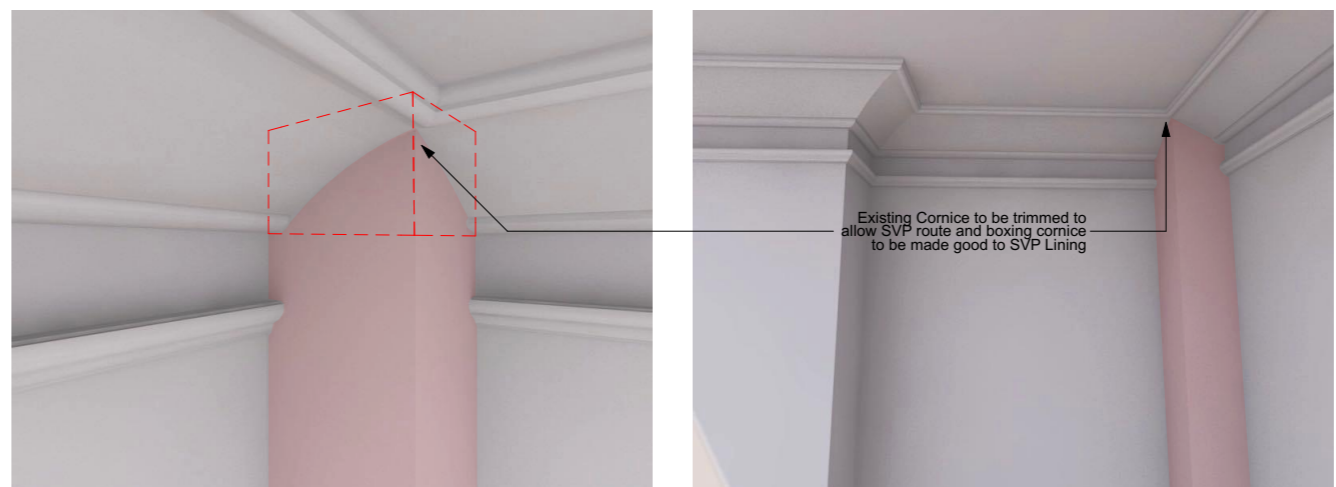

Existing Cornice to be trimmed to allow SVP route and boxing cornice to be made good to SVP Lining

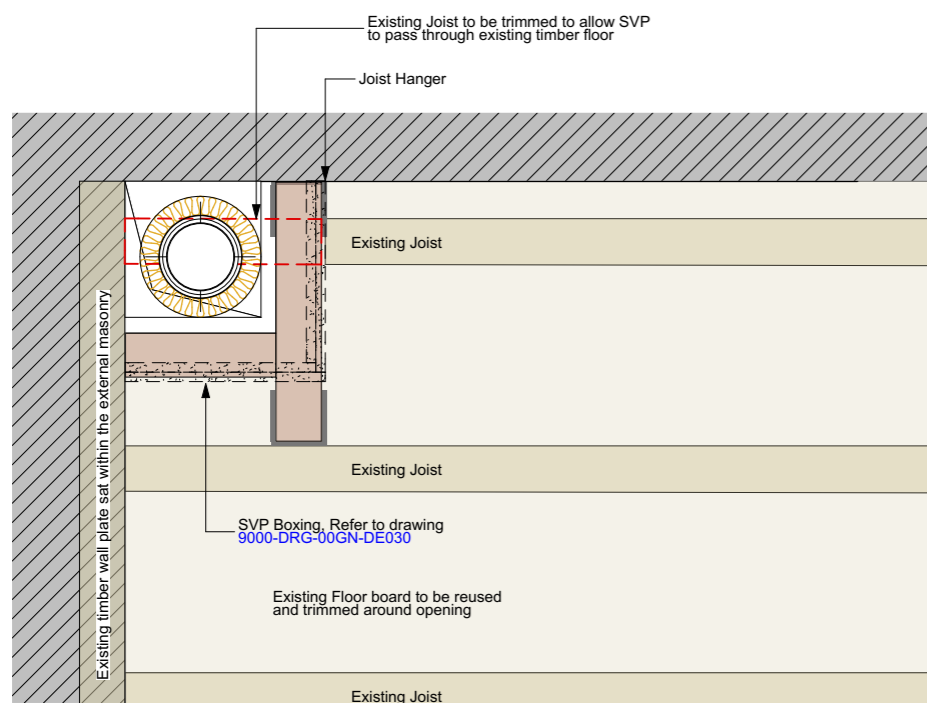

EXTRACT OF LEVEL 02 PLAN 1:10

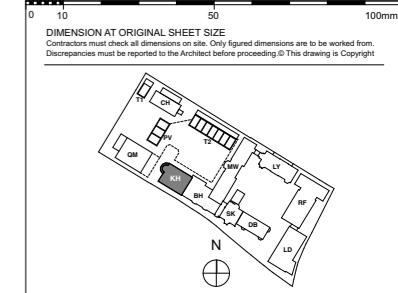
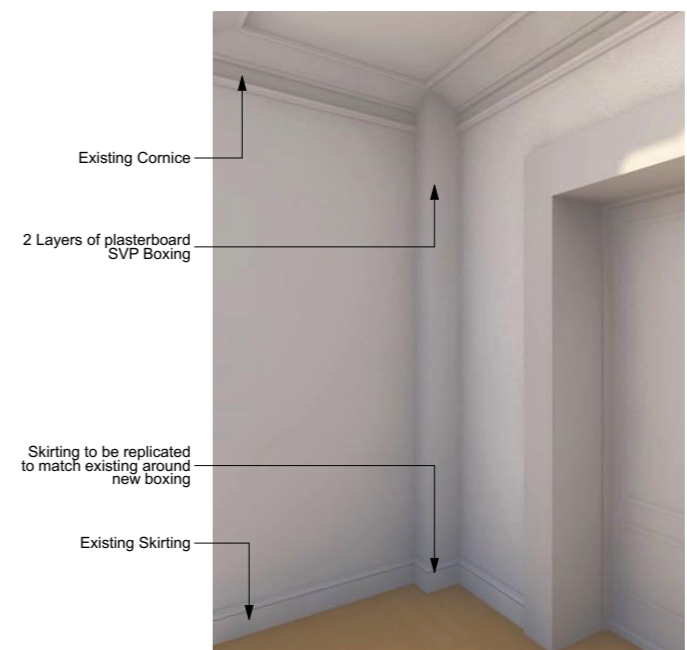

KEY PLAN
NOTE: ALL INFORMATION SHOWN ON THIS DRAWINGS IS SUBJECT TO DESIGN DEVELOPMENT

FOR PLANNING

REVISION	DRN	CHKD	DATE	
A	First Issue	GC	KJC	27/02/2017

A&Q
PARTNERSHIP

CLIENT
MOUNT ANVIL LTD

PROJECT
KIDDERPORE AVENUE

DRAWING
Kidderpore Hall
SVP Penetrations

SCALE 1:50, 1:10 @ A3 DATE June 2017

DRAWING No. 15 230 DRAWN BY GC

9000-DRG-00KH- DE009 REV A

A & Q PARTNERSHIP (LONDON) LTD
THE LUX BUILDING, 2-4 HOXTON SQUARE, LONDON N1 6 NU
Tel: 020 7613 2244 Fax: 020 7613 2642 Email: london@aqp.co.uk
ARCHITECTURE DESIGN MASTERPLANNING INTERIORS