

Detail 1: Typical Tile Pitched Roof / Mastic Asphalt Flat Roof Junction (1:5 @ A1)

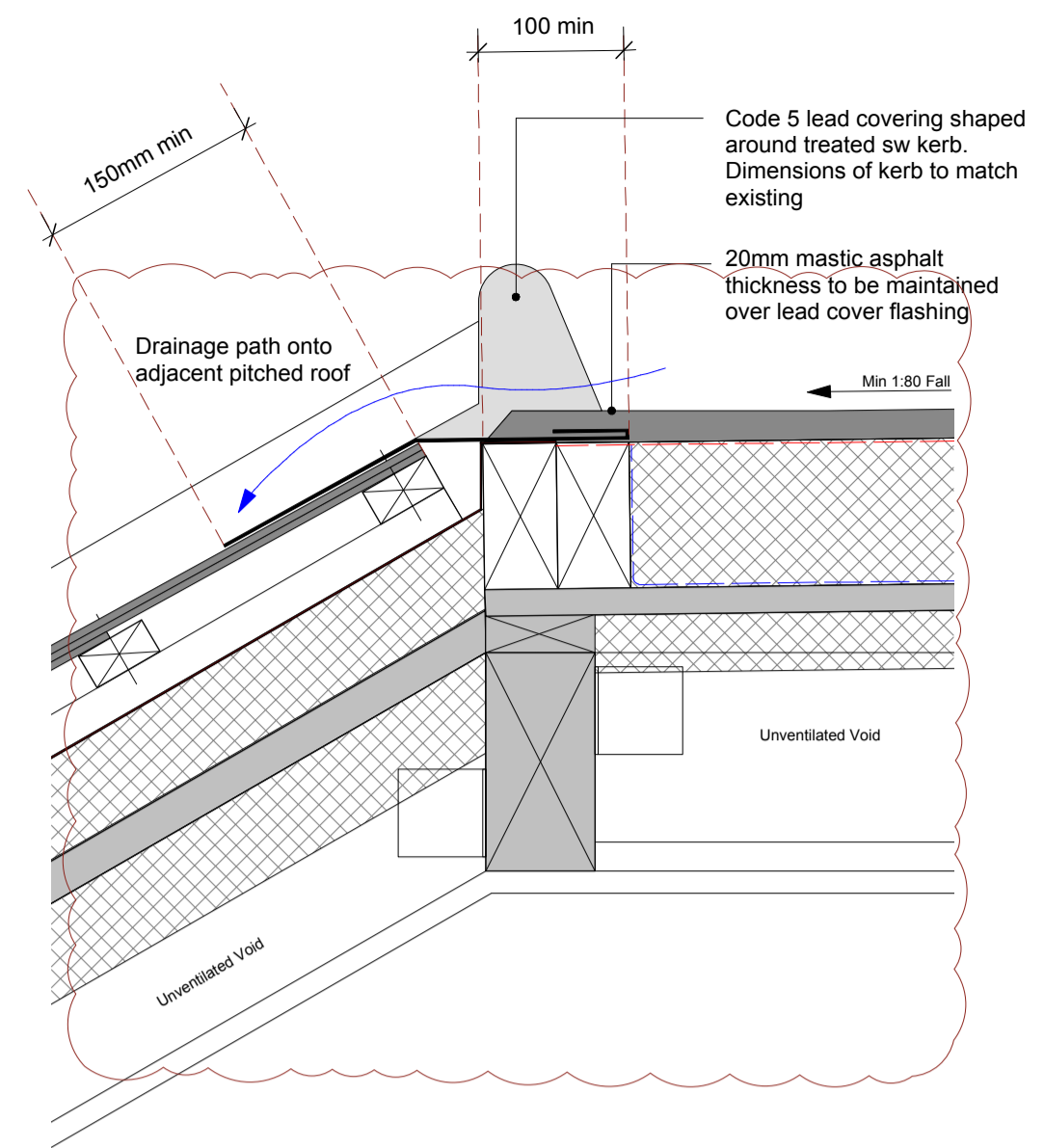

Detail 2: Drainage Detail at Perimeter Kerb (1:5 @ A1)

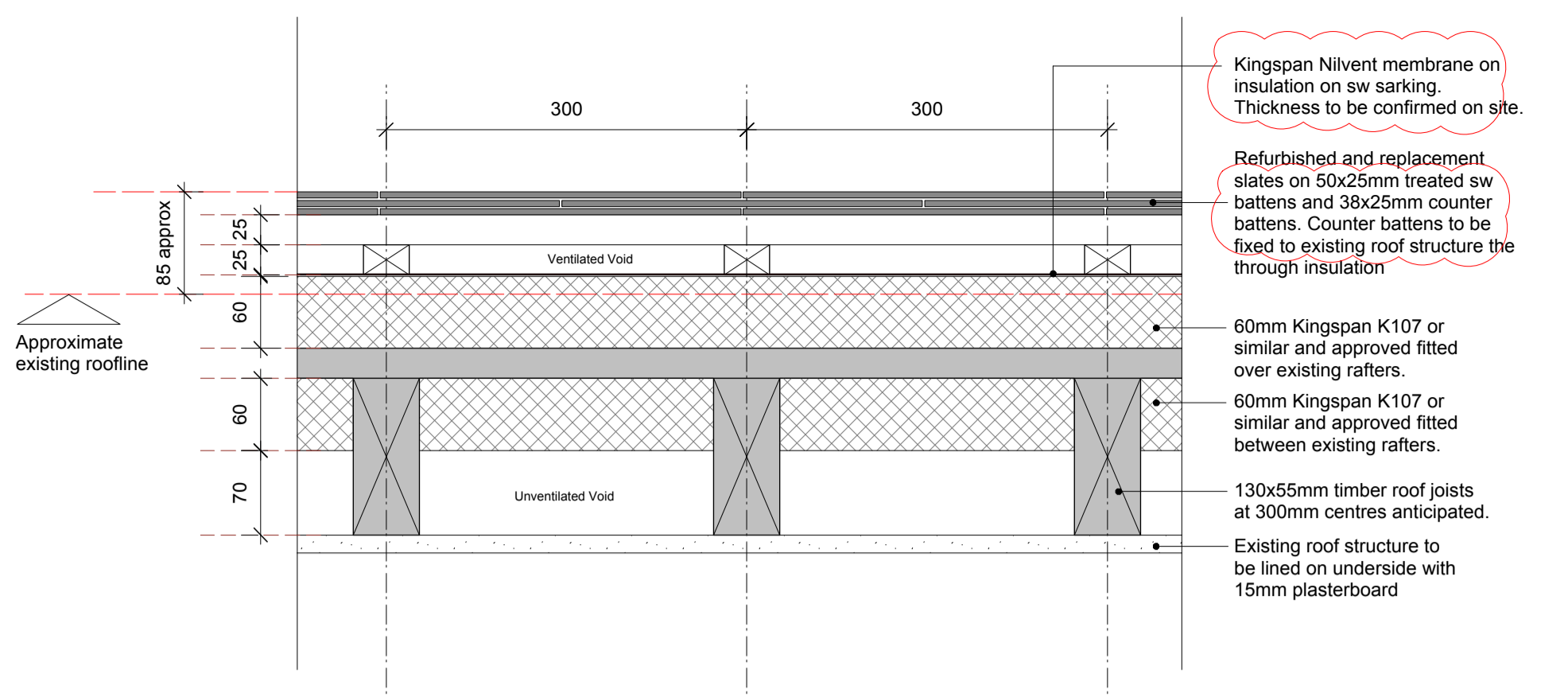

Typical Pitched Roof Build Up (1:5 @ A1)

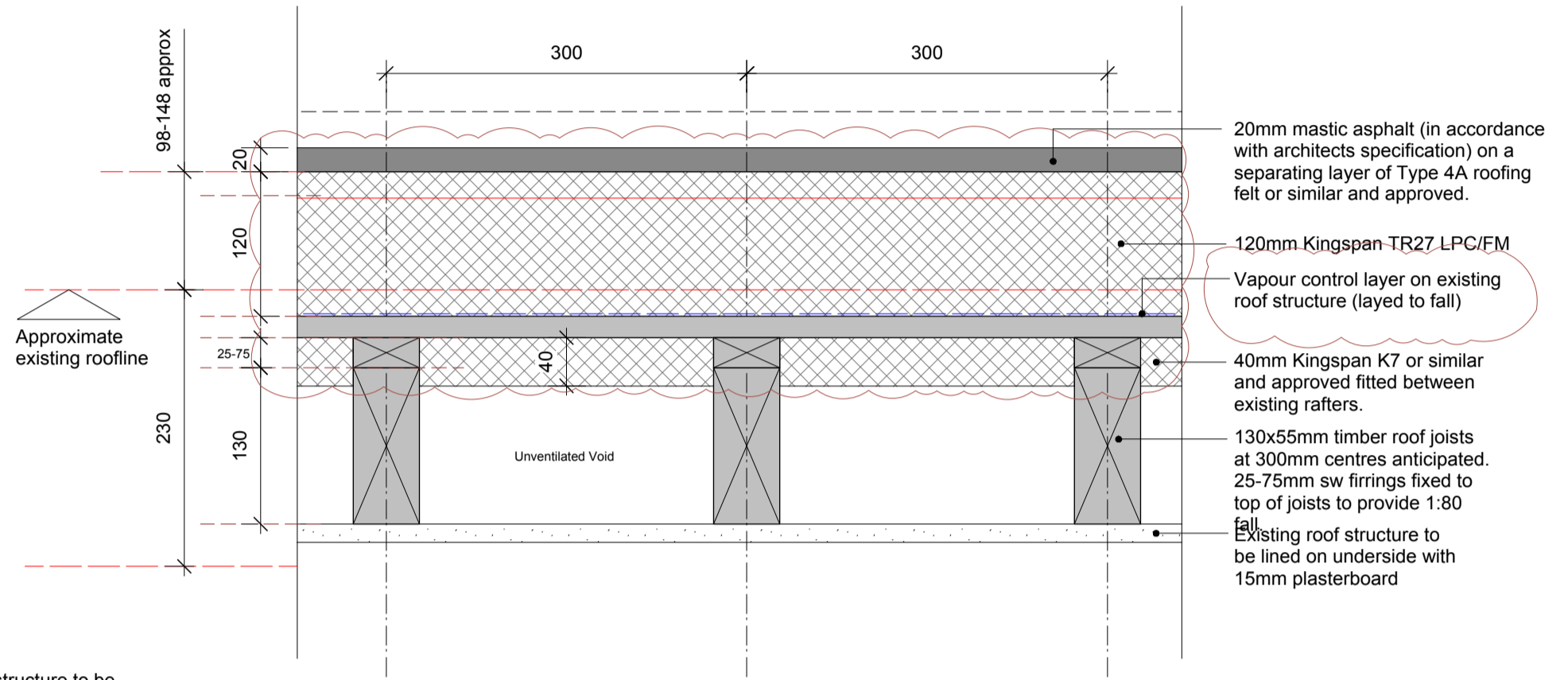

Typical Mastic Asphalt Flat Roof Build Up (1:5 @ A1)

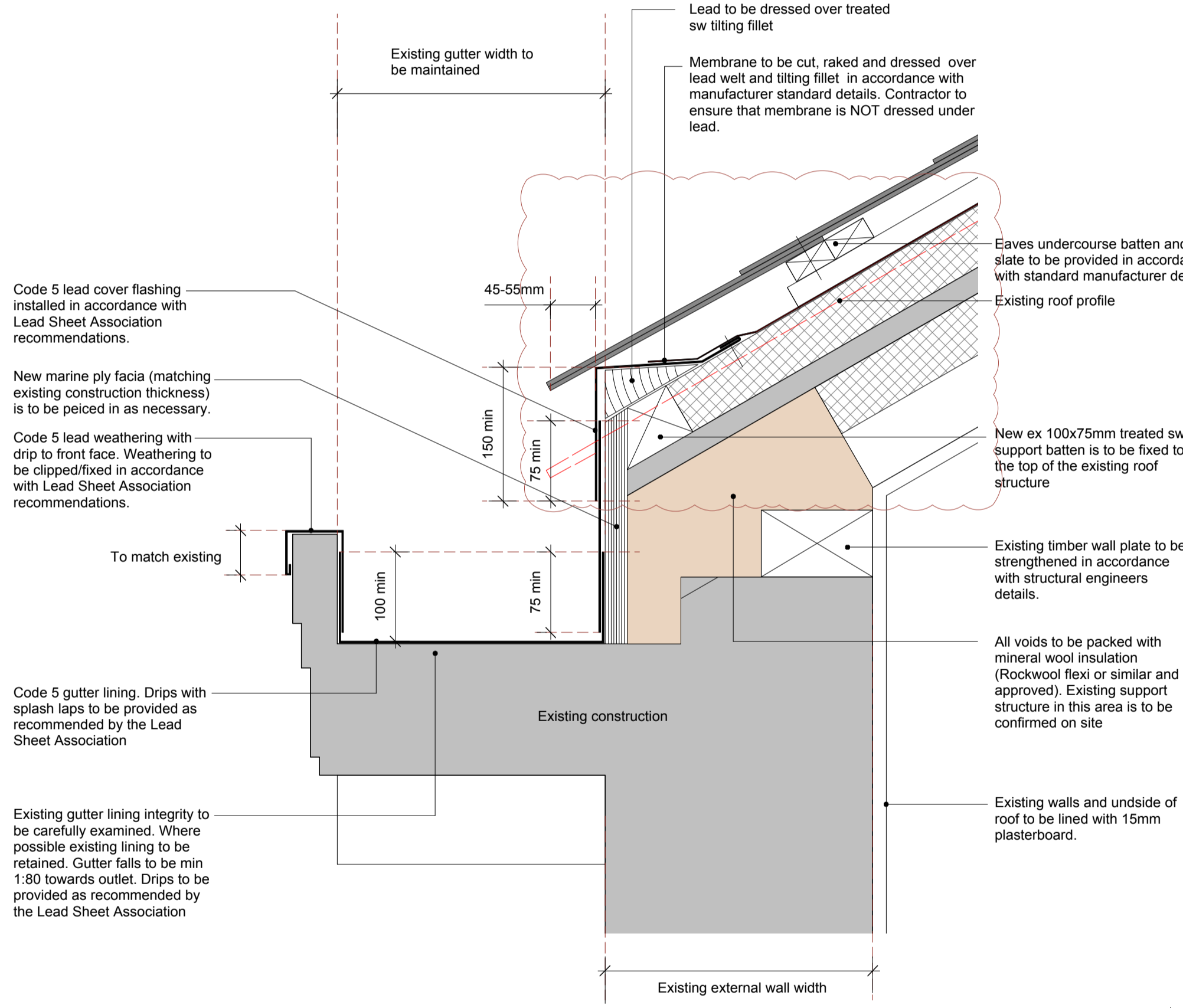

Detail 3: Typical Eaves Gutter Detail (1:5 @ A1)

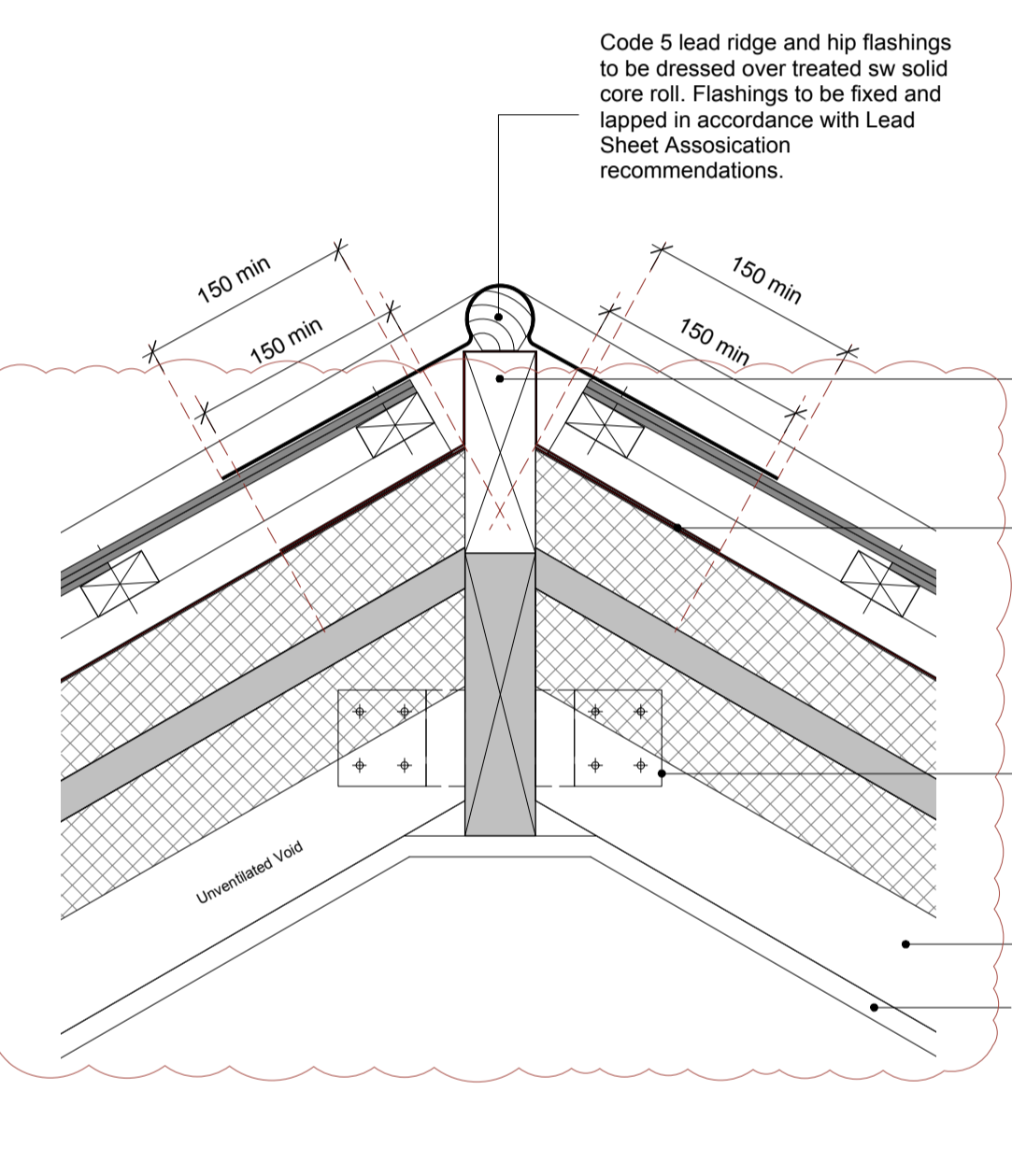

Detail 4: Typical Slate Ridge/Hip Detail (1:5 @ A1)

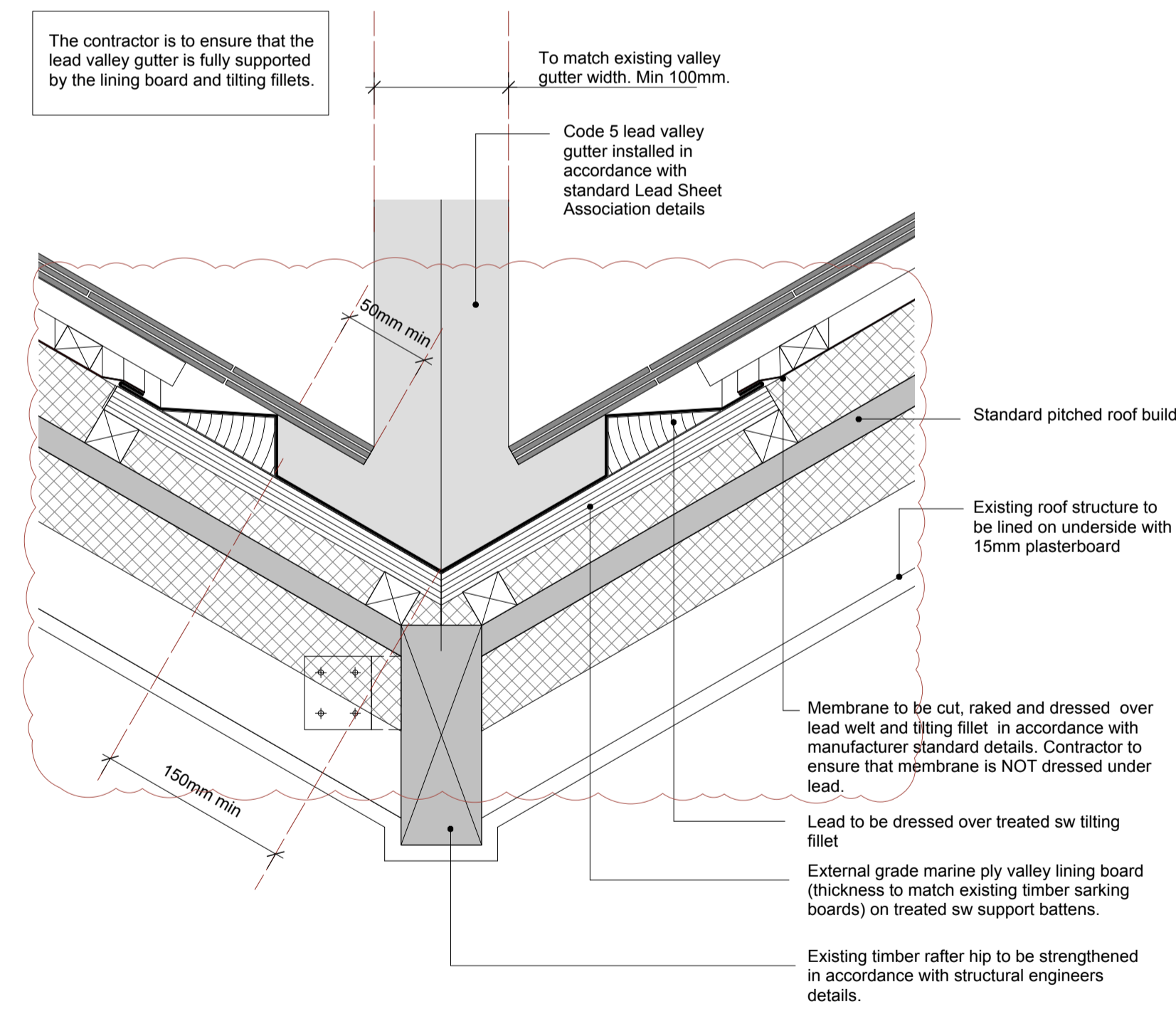

Detail 5: Typical Lead Lined Valley Detail (1:5 @ A1)

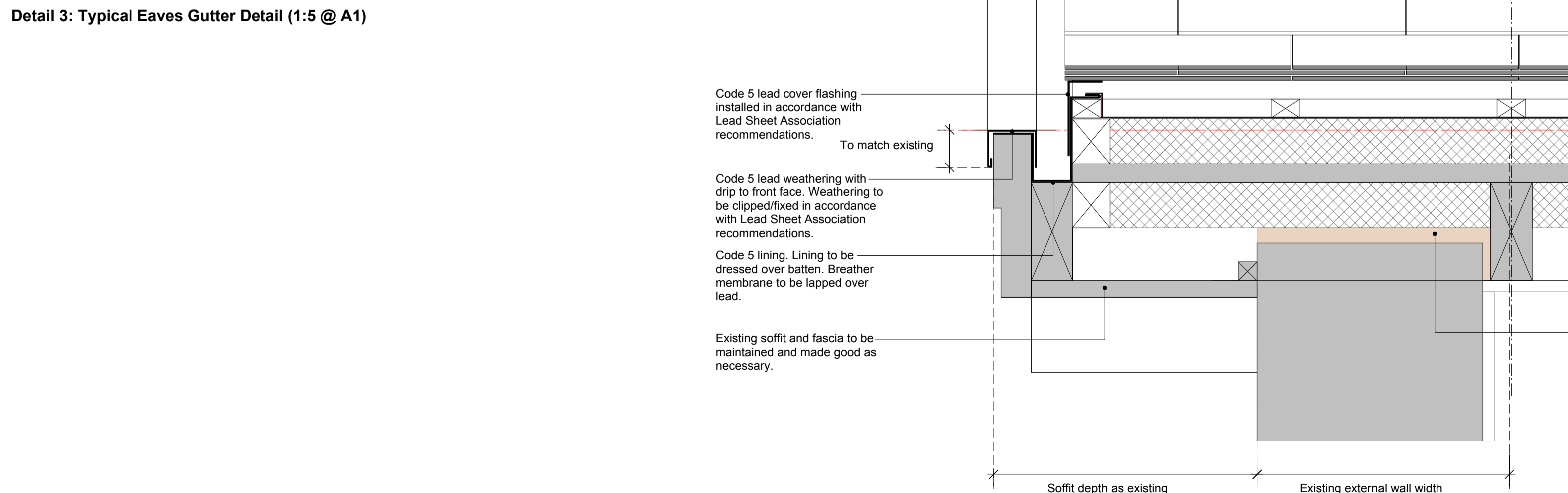

Detail 6: Typical Verge Detail (1:5 @ A1)

- Notes:**
- KIDDERPORE HALL IS A LISTED BUILDING. NO UNAUTHORISED WORK IS TO BE CARRIED OUT.**
- The contractor is to take all measures possible to protect the listed building.
1. ALL existing constructions, structure, build ups etc are to be confirmed on site PRIOR to proceeding with the work.
 2. This drawing is to be read in conjunction with all relevant Architect GA drawings and specifications.
 3. This drawing is to be read in conjunction with all relevant drawings and specifications produced by the structural engineer and M&E consultant.
 4. This drawing is to be read in conjunction with the relevant fabric survey produced by ESG.
 5. This drawing is to be read in conjunction with the relevant condition investigation report produced by Hutton & Rostrom.
 6. All lead details to be installed in accordance with Lead Sheet Association recommendations and guidance.

CONSTRUCTION

REVISION	DRN	CHKD	DATE
T1 First Issue	ST	TW	04.11.16
C1 Construction Issue. Roof build up amended to show existing timber lined on underside with plasterboard.	ST	TW	17.01.17
C2 Sarking board retained	KrC	KC	03.07.17

A&Q PARTNERSHIP

CLIENT
MOUNT ANVIL LTD

PROJECT
KIDDERPORE AVENUE

DRAWING
Kidderpore Hall
Typical Roof Details

SCAL E 1:5 @ A1 DATE Nov 2016

DRAWING No. 15 230 DRAWN BY ST

9000-DRG-00KH-DE003 REVISION N C2