



Structural & Architectural Design(S3DA)

www.s3da-design.com

Haidern Droid Senior Professional Structural Eng.

Email: haidern.droid@conelife-arch.com

Phone: +44 1355377206

1. THE CONTRACTOR MUST CHECK ALL DIMENSIONS ON SITE BEFORE COMMENCING WORK
2. ALL WORK MUST CONFORM TO CURRENT BUILDING REGULATIONS, BRITISH STANDARDS & CODES OF PRACTICE AND NHBC STANDARDS
3. THESE DRAWINGS ARE TO BE READ IN CONJUNCTION WITH ALL RELEVANT DESIGNER, ENGINEER OR SPECIALIST DRAWINGS AND SPECIFICATIONS
4. ALL DIMENSIONS ARE IN MILLIMETERS UNLESS STATED OTHERWISE
5. THE CONTRACTOR IS RESPONSIBLE FOR PROVIDING ALL NECESSARY TEMPORARY SUPPORT TO THE BUILDING AND ANY ADJACENT STRUCTURES

NOTE:

PROJECT TITLE: LOFT CONVERSION

CLIENT: STEWART BRANNAN

ADDRESS: 18 BELSIZE PARK, LONDON

TITLE: PROPOSED LOFT & ROOF PLAN

DRAWING NO: 04

REV:

DRAWN BY: H.D.

Date: JUNE 2017

SCALE: 1:100@ A3

MECHANICAL VENTILATION

PROVIDE MECHANICAL VENTILATION TO NEW KITCHEN WITH FAN CAPABLE OF EXTRACTING AIR AT A RATE OF 60 L/S, OR BY MEANS OF A COOKER HOOD CAPABLE OF EXTRACTING AIR AT A RATE OF 30 L/S. PROVIDE MECHANICAL VENTILATION TO ENSUITES / BATHROOM WITH FAN CAPABLE OF EXTRACTING AIR AT A RATE OF 15 L/S AND OPERATED BY HUMIDITY SENSOR, UTILITY ROOM TO HAVE AN EXTRACT FAN, CAPABLE OF EXTRACTING AT 30 LITRES/SECOND, PROVIDE MECHANICAL VENTILATION TO W.C WITH FAN CAPABLE OF EXTRACTING AIR AT A RATE OF 6L/S AND OPERATED BY LIGHT SWITCH WITH 15MINUTE OVERRUN.

FD 30 FIRE RATED DOOR

 EXTRACT FAN

HD HEAT DETECTOR (MAINS POWERED WITH BATTERY BACKUP)

SD SMOKE DETECTOR (MAINS POWERED WITH BATTERY BACKUP)

BACKGROUND AND PURGE VENTILATION

Background ventilation - Controllable background ventilation via trickle vents to BS EN 13141-3 within the window frame to be provided to new habitable rooms at a rate of min 5000mm². and to kitchens, bathrooms, WCs and utility rooms at a rate of 2500mm²

Purge ventilation - New Windows/rooflights to have openable area in excess of 1/20th of their floor area, if the window opens more than 30° or 1/10th of their floor area if the window opens less than 30°

Internal doors should be provided with a 10mm gap below the door to aid air circulation.

Ventilation provision in accordance with the Domestic Ventilation Compliance Guide.

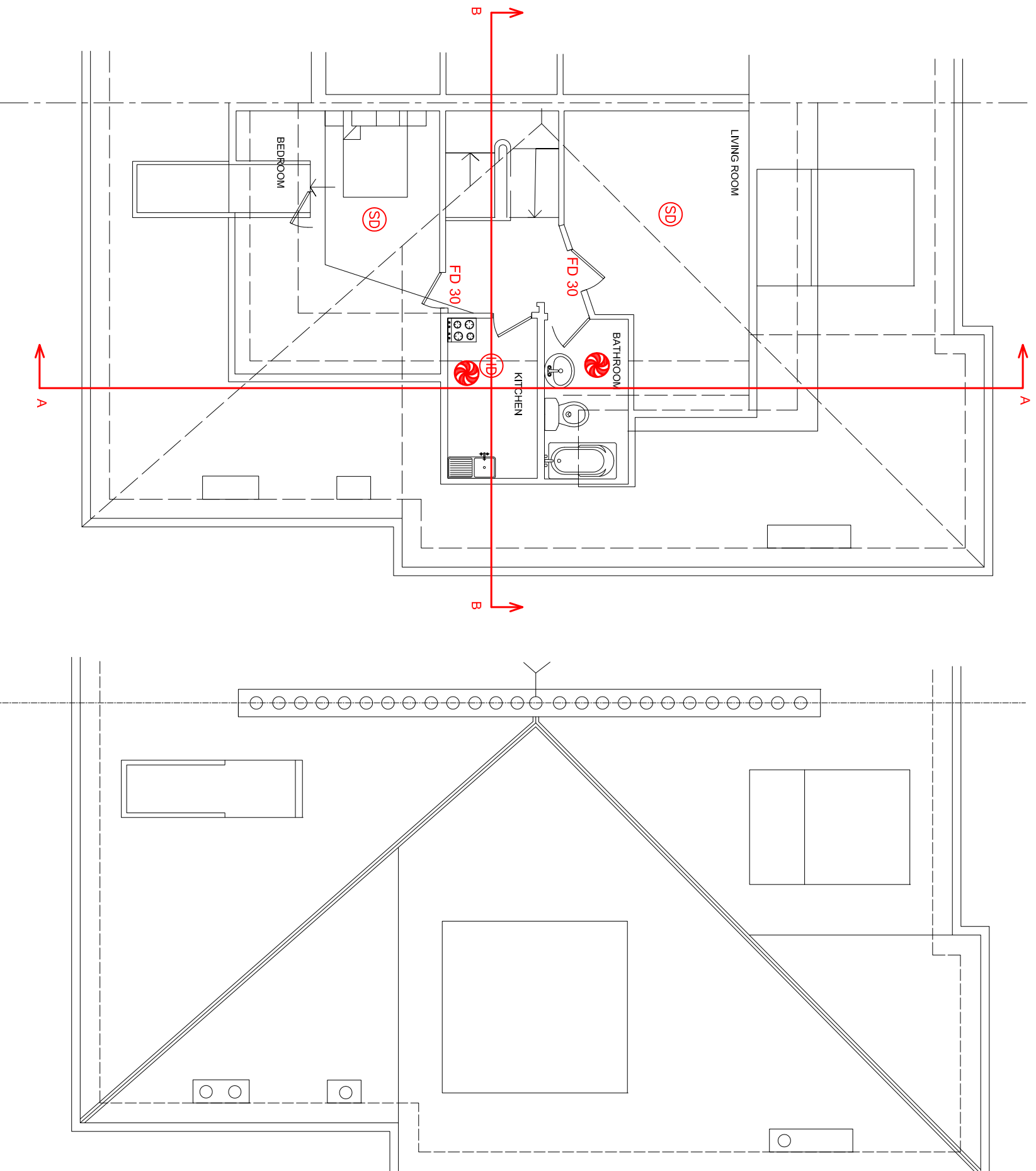

PROPOSED LOFT FLOOR PLAN

PROPOSED ROOF PLAN