

| Internal Door | | | | | | | | | | | | |
|---|---------------------------|----------------------------|--|--|--|--|--|--|--|--|--|--|
| Location | CH_BASEMENT | CH_BO-02 | CH_LOWER GROUND | | | | | | | | | |
| Door Ref | CH-BO-01 | CH-BO-02 | CH-D-LG-01 | CH-D-LG-02 | CH-D-LG-03 | CH-D-LG-04 | CH-D-LG-05 | CH-D-LG-06 | CH-D-LG-07 | CH-D-LG-08 | CH-D-LG-09 | CH-D-LG-10 |
| Nominal Leaf size W x H (excluding undercut) | 1,424x2,100 | 1,424x2,100 | 838x2,035 | 755x1,947 | 838x2,035 | 838x2,035 | 610x2,035 | 838x2,035 | 838x2,035 | 838x2,035 | 838x2,035 | 838x2,035 |
| Nominal S.O in new wall | N/A | N/A | N/A | N/A | 914 x 2,073 | 914 x 2,073 | 686 x 2,073 | 914 x 2,073 | 914 x 2,073 | 914 x 2,073 | 1,741 x 2,094 | 1,741 x 2,094 |
| Nominal S.O in Existing/Masonry Wall | 1,516 x 2,146 | 1,516 x 2,146 | 930 x 2,081 | 847 x 1,993 | N/A | N/A | N/A | N/A | N/A | N/A | N/A | N/A |
| Elevation | | | | | | | | | | | | |
| Fire Rating * | FD30s | FD30s | FD20 | Zero | FD20 | FD20 | FD20 | FD20 | FD20 | FD20 | Zero | Zero |
| Status | New Door | New Door | New Door | New Door, existing opening | New Door | New Door | New Door | New Door | New Door | New Door | New Sliding Door | New Sliding Door |
| Glazing | N/A | N/A | N/A | N/A | N/A | N/A | N/A | N/A | N/A | N/A | N/A | N/A |
| Description | Aluminium plant room door | Aluminium refuse room door | 10 No. panelled door to match existing. Architrave similar in style throughout the building. | 10 No. panelled door to match existing. Architrave similar in style throughout the building. | 10 No. panelled door to match existing. Architrave similar in style throughout the building. | 10 No. panelled door to match existing. Architrave similar in style throughout the building. | 5 No. panelled door to match style of existing. Architrave similar in style throughout the building. | 10 No. panelled door to match existing. Architrave similar in style throughout the building. | 10 No. panelled door to match existing. Architrave similar in style throughout the building. | 10 No. panelled door to match existing. Architrave similar in style throughout the building. | Flush panel sliding door - Enigma style by Selo | Flush panel sliding door - Enigma style by Selo |
| Ironmongery | TBC | TBC | New ironmongery to match in style throughout the building. | New ironmongery to match in style throughout the building. | New ironmongery to match in style throughout the building. | New ironmongery to match in style throughout the building. | New ironmongery to match in style throughout the building. | New ironmongery to match in style throughout the building. | New ironmongery to match in style throughout the building. | New ironmongery to match in style throughout the building. | New ironmongery to match in style throughout the building. | New ironmongery to match in style throughout the building. |

| Internal Door | | | | | | | | |
|---|--|--|--|--|--|--|--|--|
| Location | CH_ENTRANCE LEVEL | | | | | | | |
| Door Ref | CH-D-LG-11 | CH-D-UG-01 | CH-D-UG-02 | CH-D-UG-03 | CH-D-UG-04 | CH-D-UG-05 | CH-D-UG-06 | CH-D-UG-07 |
| Nominal Leaf size W x H (excluding undercut) | 838x2,035 | 838x2,035 | 838x2,035 | 838x2,035 | 838x2,035 | 838x2,035 | 610x2,035 | 838x2,035 |
| Nominal S.O in new wall | 914 x 2,073 | 914 x 2,073 | 914 x 2,073 | 914 x 2,073 | 914 x 2,073 | 914 x 2,073 | 686 x 2,073 | 914 x 2,073 |
| Nominal S.O in Existing/Masonry Wall | N/A | N/A | N/A | N/A | N/A | N/A | N/A | N/A |
| Elevation | | | | | | | | |
| Fire Rating * | FD20 | FD20 | FD20 | Zero | FD20 | Zero | FD20 | Zero |
| Status | New Door | New Door | New Door | New Door | New Door | New Door | New Door | New Door |
| Glazing | N/A | N/A | N/A | N/A | N/A | N/A | N/A | N/A |
| Description | 10 No. panelled door to match existing. Architrave similar in style throughout the building. | 10 No. panelled door to match existing. Architrave similar in style throughout the building. | 10 No. panelled door to match existing. Architrave similar in style throughout the building. | 10 No. panelled door to match existing. Architrave similar in style throughout the building. | 10 No. panelled door to match existing. Architrave similar in style throughout the building. | 10 No. panelled door to match existing. Architrave similar in style throughout the building. | 5 No. panelled door to match style of existing. Architrave similar in style throughout the building. | 10 No. panelled door to match existing. Architrave similar in style throughout the building. |
| Ironmongery | New ironmongery to match in style throughout the building. | New ironmongery to match in style throughout the building. | New ironmongery to match in style throughout the building. | New ironmongery to match in style throughout the building. | New ironmongery to match in style throughout the building. | New ironmongery to match in style throughout the building. | New ironmongery to match in style throughout the building. | New ironmongery to match in style throughout the building. |

INTERNAL DOOR NOTES:
All Doors
 CONTRACTORS, SUB-CONTRACTORS AND MANUFACTURERS TO ENSURE THAT ALL MATERIALS AND COMPONENTS ARE SUITABLE FOR THEIR INTENDED PURPOSE AND LOCATION; DESIGNED, MANUFACTURED AND INSTALLED IN ACCORDANCE WITH ALL RELEVANT CURRENT BRITISH STANDARDS, CODES OF PRACTICE, AND MANUFACTURER'S SPECIFICATIONS.

Any reference to an Approved Document in this Specification relates to the relevant Approved Document of the Building Regulations.

Refer to drawing 9000-DRG-08GN-DE001 and DE002 for joinery details.

All door leaf sizes shown **exclude** undercuts and packing zones.

All existing and proposed structural openings, frames, door leaves and associated structures (ceilings, stairs, etc) to be confirmed on site prior to manufacture.

For door handing, refer to GA Plans.

Sliding Doors
 Scheduled sliding door leaf widths and height are shown as the nominal dimensions. Manufacturer to confirm actual width and height required. Sliding door gear, pockets and jamba to be confirmed and sized prior to manufacture to ensure structural openings are adequate

Fire Doors
 All FD30 doors to receive smoke seals and intumescent strips.

All fire door sets to meet all requirements of BS 5588. Fire door sets to be tested to meet BS 476-22 or BS EN4547 and supplied with product conformity certificates.

Door linings, stops, vision panels, cold smoke seals (denoted by the 's' suffix) etc., all to meet doors manufacturers standard fire tested details to achieve fire ratings as noted.

Door schedules to be read in conjunction with relevant joinery details.
 * For ALL apartment doors, refer to Fire Drawings

Doors to apartment entrances and communal corridors

Doors to be fitted with self closing mechanisms. Entrance doors to achieve minimum of 29Db sound reduction - refer to Sol acoustic report, Section 10 for further requirements.

Ironmongery

All ironmongery TBC.

- Plant room doors to meet BS 3621 and engineers requirements.

- Cycle store doors to have PAS 24 doors (or LPS 175 Security 2) and fob access.

Door Finishes:
 Refer to finishes schedule.

Glazing
 Any 'new' glazing panels below 800mm in windows or 1200mm in glazed doors or screens within 300mm of doors, will need to be able to break safely on impact.

Door panels
 Refer to drawings 9000-DRG-08GN-DE005 for panel setting out of door panels, handle heights, etc.

NOTE:
 Structural opening sizes have been calculated from details on drawing 9000-DRG-08GN-DE002 and are predicated on the use of the 30mm Ahmarra frame for all side hung doors. Use of another frame size may require adjustments to the structural opening calculation.

Sliding doors use the Selo Enigma system sizes supplied by the manufacturer. Use of a different supplier may require different structural openings.

NOTE: Existing opening sizes to be confirmed on site and new door sizes to be set (to suit opening size) and agreed prior to manufacture.

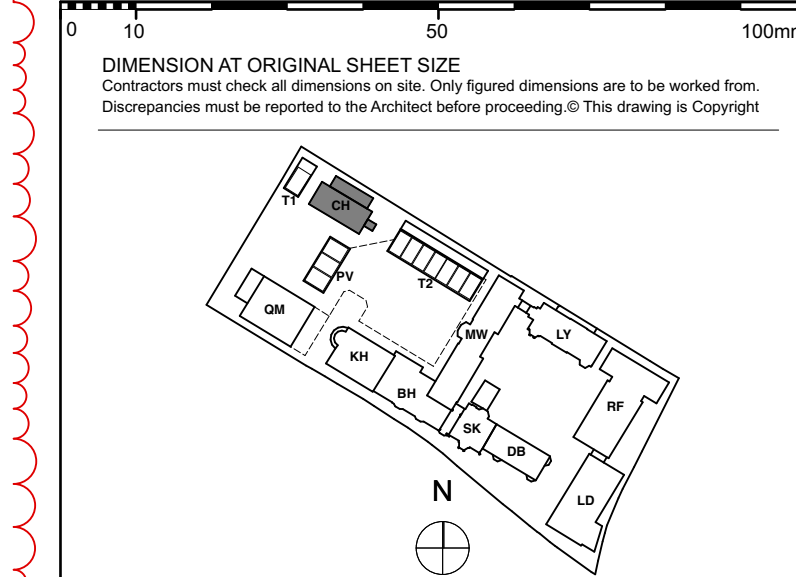

KEY PLAN
NOTE:
 ALL DIMENSIONS ARE GUIDELINES ONLY - ALL DIMENSIONS TO BE CHECKED ON SITE PRIOR TO MANUFACTURING.
 TO BE READ IN CONJUNCTION WITH HUTTON + ROSTRON WINDOW CONDITION SURVEYS WHERE APPLICABLE.
 ALL ADDITIONAL IRONMONGERY TO BE AGREED WITH THE ARCHITECT PRIOR TO INSTALLATION

All new and replacement window and door shop drawings are to be reviewed and approved by the architect prior to manufacture.

Glazing
 Any 'new' glazing panels below 800mm in windows or 1200mm in glazed doors or screens within 300mm of doors, will need to be able to break safely on impact.

Door panels
 Refer to 9000-DRG-08GN-DE005 for panel setting out of door panels, handle heights, etc.

Key:
 References in red apply to the surrounding masonry conditions of doors and windows:
 H1 - Head Detail reference
 J2 - Jamb detail reference
 TS/SD1 - Sill Detail Reference

Ex - Existing condition
 Details for individual door and window frames, glazing bars, mouldings, stiles, etc., where not shown in the details above, are annotated in blue:

HD1 - Door / window component detail reference

Refer to: drawings 9000-DRG-08GN-DE047 to 9000-DRG-08GN-DE048 for details outlined above.

NOTE:
 In all instances new head, sill and jamb details and glazing bars are to visually match existing adjacent conditions.

FOR CONSTRUCTION

| REVISION | DRN | CHKD | DATE |
|--|-----|------|------------|
| C1 Issued for Construction | NV | TW | 23/12/2016 |
| C2 Annotation Added/Revised | NV | TW | 22/03/2017 |
| C3 Door Leaf Added/Revised | MRR | ST | 14/06/2017 |
| C3 Structural opening dimensions Added/Revised | MRR | ST | 14/06/2017 |
| | | | |
| | | | |
| | | | |
| | | | |
| | | | |
| | | | |
| | | | |
| | | | |
| | | | |
| | | | |
| | | | |
| | | | |
| | | | |
| | | | |
| | | | |
| | | | |
| | | | |
| | | | |
| | | | |
| | | | |
| | | | |



CLIENT
 MOUNT ANVIL LTD

PROJECT
 KIDDERPORE AVENUE

DRAWING
 Chapel
 Internal Door Schedule

SCALE NTS @ A1 **DATE**
 March 2017

DRAWING No. **DRAWN BY**
 15 230 MRR
9000-SCH-CH-004 **REV**
 C3

A & Q PARTNERSHIP (LONDON) LTD
 THE LUX BUILDING, 2-4 HOXTON SQUARE, LONDON N1 6NU
 Tel: 020 7613 2244 Fax: 020 7613 2642 Email: london@aqp.co.uk
 ARCHITECTURE DESIGN MASTERPLANNING INTERIORS