

Land adjacent to No.1 Elsworthy Terrace,
London NW3
Appendix 14

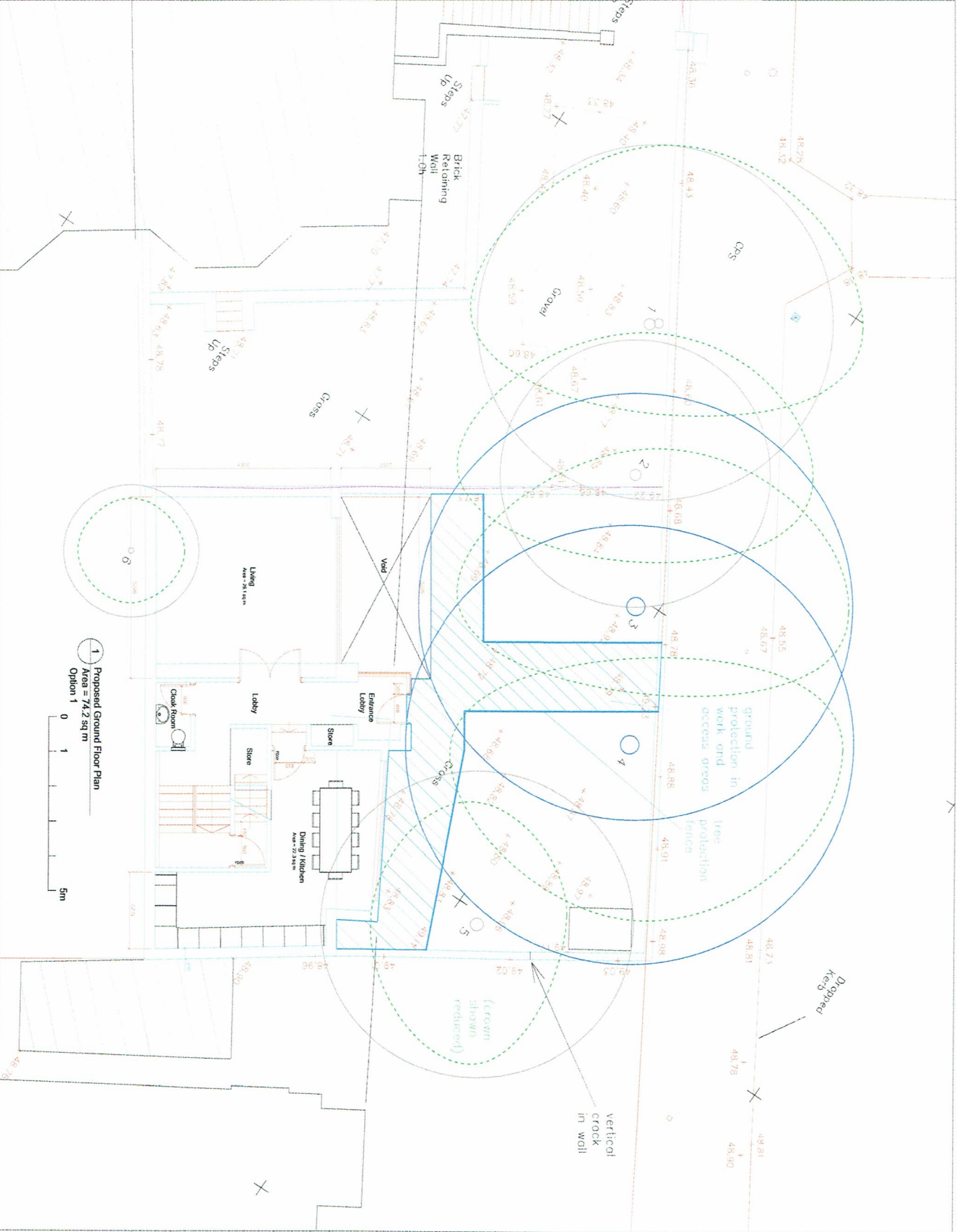

1 Proposed Ground Floor Plan
Area = 74.2 sq m
Option 1



Simon Pryce Arboriculture

Client:
Caroline Nourani

Site:
Land ad 23 Elsworthy Road, London,
NW3 3DR

Title:
Proposed site ground floor plan

Date: 20 October 2015

Ref: 15/045 Rev: a

Scale: 1:100 at A3

CP House,
Overspool Way,
Watford,
WD15 8HP
tel 01923 467600
info@simonpryce.co.uk
www.simonpryce.co.uk

Original drawing:
Ko Architects

Root protection areas (RPA) are shown in red. Root protection zones (RPZ) are shown in blue. Trees in relation to design, demolition and construction.

A = green
B = blue
C = red
U = red - dashed - also used to denote dead trees with no RPA
Tree protection fencing = mid blue
Crown spreads = mid green