

Demolition Legend:

- Existing
- Demolition/Strip Out Works

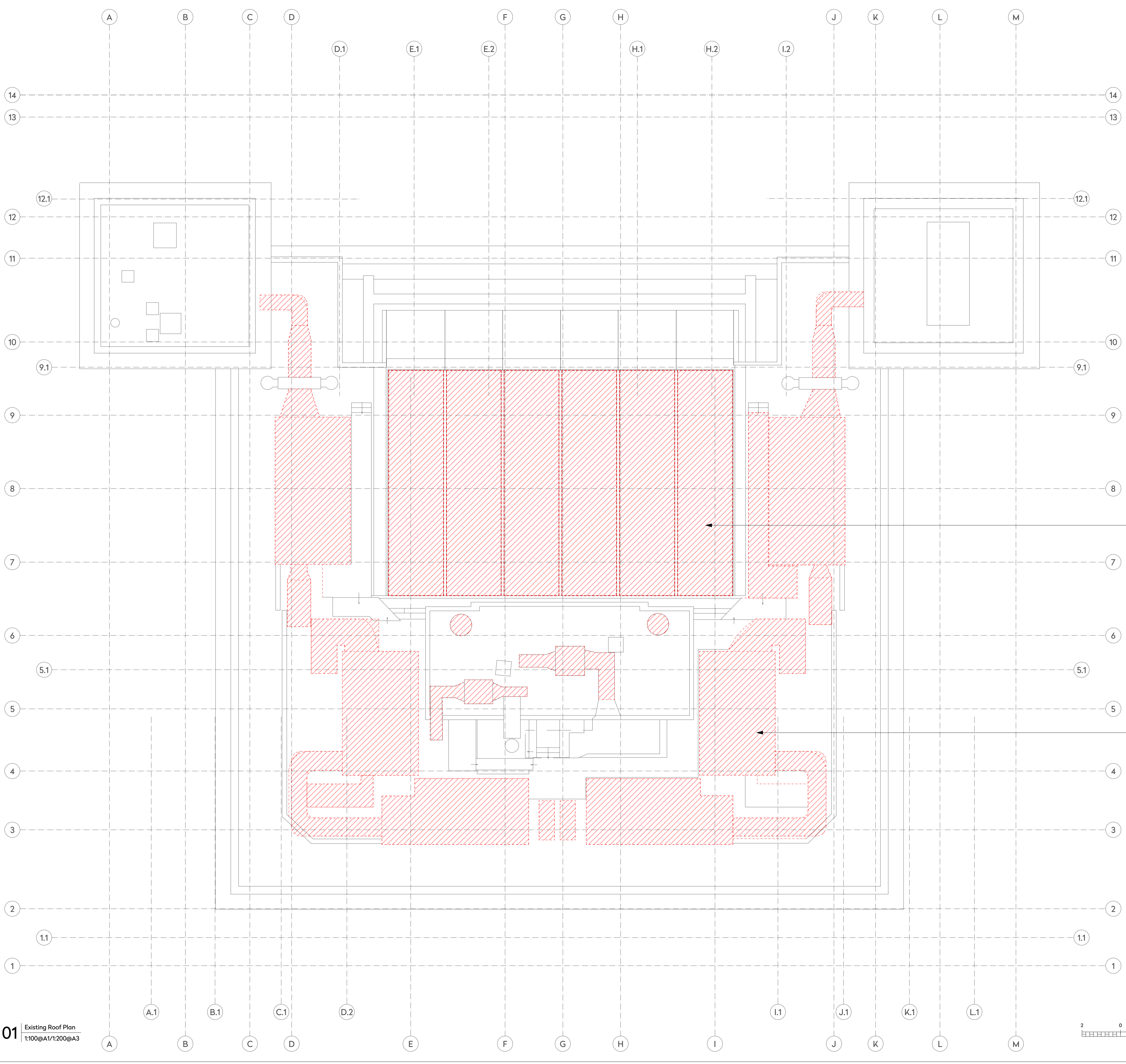

Existing lightweight PTFE roof to be removed and replaced with glazing. Retain existing primary structure

Remove indicated M&E units to make way for new

01 Existing Roof Plan
1:100@A1/1:200@A3

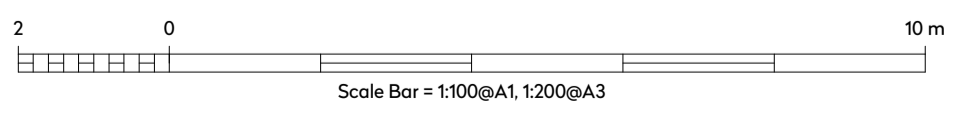

Rev.	Date	Details	By

Client

Warner Bros.

Project name

Project Phoenix

Drawing title

Existing Roof Plan

Status

Planning Application

Scale	Drawn by
1:100@A1, 1:200@A3	CF
Date	Checked by
Aug 2017	RL
Drawing number	Revision
1539-P-111-Exist. Roof Plan	-

This drawing is copyright. Do not scale off dimensions. All dimensions are to be checked on site by contractor. Contractor to report any dimensional discrepancies, errors or omissions prior to commencing in site.