

SCALE IN METRES

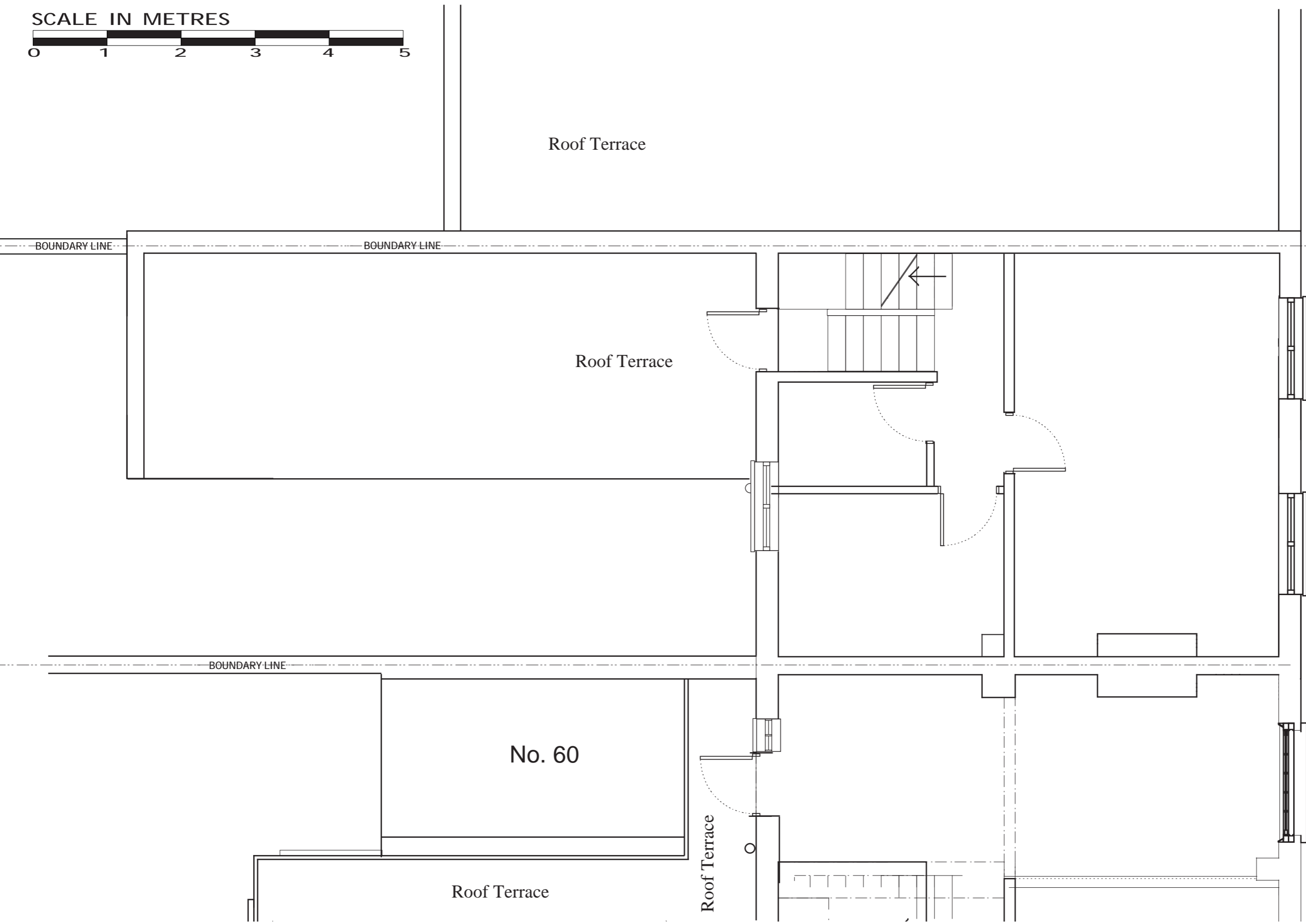

Existing First Floor Plan

	Allgreen Designs Ltd
	23C High Street, Helpringham, Sleaford, NG34 0RA
	Tel: 01529-421583 Fax: 01529-421584
Proposed Rear Extension at: 58 Grafton Road, Kentish Town, London	
Client: Ms Y. Liu	Drawn: J.P.
Date: 15 / 06 / 12	Scale: 1:50 on A3
Drawing No. 120202	1:100 on A4