

NOTE: Refer to Studio Engleback information for detail on landscape proposals and levels

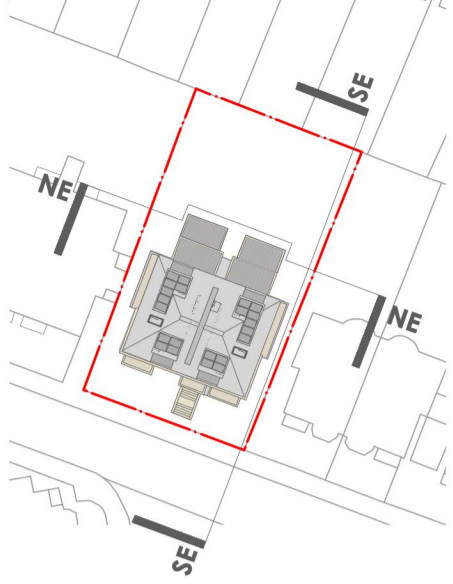

01 PROPOSED NORTH-EAST ELEVATION (NE)  
SCALE 1:100



02 PROPOSED SOUTH-EAST ELEVATION (SE)  
SCALE 1:100

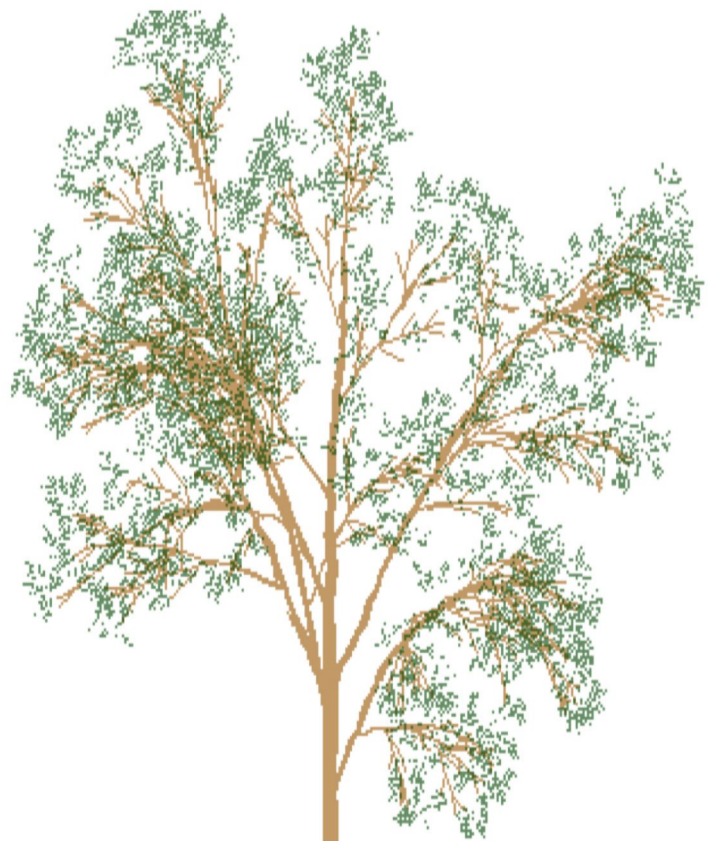

© john pardey architects			
• Do not Scale. Used figured dimensions only.			
• All dimensions to be checked on site.			
• All drawings to be read in conjunction with engineer's drawings. Any discrepancies between consultative drawings to be reported to the Architect before any work commences.			
• The Contractor's attention is drawn to the Health & Safety matters identified in the Health & Safety plan and on drawings as being potentially hazardous.			
• These items should not be considered as a full and final list.			
• The Work Package Contractor's normal Health & Safety obligations still apply when undertaking constructional operations both on and off site.			
<b>MATERIAL LEGEND</b>			
01) BRICK: rough surface, stretcher bond, flush pointed natural mortar - colour mixed white border stock (Petersen tegl D78 or similar alternative)			
02) CORNING: natural stone to match adjacent villa facades			
03) PRECAST BAYS: flush jointed reconstituted stone panels, acid etched - colour white stone			
04) PRECAST PANELS: flush jointed reconstituted stone panels, acid etched - colour white stone			
05) PRECAST CORNICE: flush jointed reconstituted stone coping, acid etched - colour white stone			
06) PRECAST CORNICE: flush jointed profiled reconstituted stone coping, acid etched - colour white stone			
07) PRECAST COLUMNS: flush jointed reconstituted stone columns, acid etched - colour white stone			
08) WINDOWS/DOORS 1: windows with precast lining, outer finish satin powder coated metal, with head and sill to match - colour light grey (RAL 7035), all lower floor level opening and accessible windows to be BS PAS 24-2012 with P1A rated laminated glass			
09) WINDOWS 2: outer finish powder coated metal, with head and sill to match - colour light grey (RAL 7035), all lower floor level opening and accessible windows to be BS PAS 24-2012 with P1A rated laminated glass			
10) WINDOWS 3: outer finish satin powder coated metal - colour brown/grey (RAL 7013)			
11) SPANDREL PANELS 1: flush frameless metallic panels, outer finish satin powder coated metal to match windows 3 - colour brown/grey (RAL 7013)			
12) WINDOWS 4: clerestory windows, outer finish satin powder coated metal, with sill to match - colour light grey (RAL 7035)			
13) DORMER WINDOWS: metal with heavy gauge edge profile - colour dark grey to match side, balcony door frame outer finish powder coated metal - colour colour light grey (RAL 7035)			
14) ROOF LIGHT: outer finish powder coated metal - colour grey/brown (RAL 7013)			
15) ENTRANCE DOORS: solid core with lacquered outer finish metal powder coated - colour colour light grey (RAL 7035), flush frameless metal side panels with outer finish powder coated metal - colour colour light grey (RAL 7035), to be BS PAS 24-2012 or acceptable enhanced security standard, integrated audio visual access control			
16) RESIDENTIAL DOORS: solid core with outer finish powder coated metal - colour light grey (RAL 7035), to be BS PAS 24-2012 or acceptable enhanced security standard			
17) BIN+BIKE DOORS: metal/louvered doors - colour light grey (RAL 7035), self-closing and locking			
18) CORNING: anodised aluminium profiles			
19) CANOPY: metal canopy with signage			
20) BALUSTRADE: metal balustrade and handrail - colour brown/grey (RAL 7013)			
21) GREEN WALLS: generally vine planting to stained wire or mesh supports, free box green wall system at rear of building or vertical rain garden filtering roof water runoff, to landscape architect's specification			
22) GATES: metal vertical flats - painted finish - self closing and locking, colour brown/grey (RAL 7013)			
23) EXTERNAL STEPS: precast concrete with natural stone tiling			
24) PV PANELS: photovoltaic panels mounted horizontally to dormers			
25) BALCONY DECK: high performance steel system with insulation and paving slabs			
26) RAINWATER GOODS: Lindab or similar alternative powder coated metal - colour brown/grey (RAL 7013 brown/grey)			
27) CHIMNEY: raised party wall parapet element - brick to match main body with metal cowl			
28) BAT BOXES: integrated box - Schwegler 1FR or similar alternative			
rev	date	initials	description

drawing:

PROPOSED ELEVATIONS (SHEET 02)

project:

5-7 LANCASTER GROVE

drawing no:

1409\_4001

status code/ revision:

-

status:

PLANNING

scale @ A1:

1:100

date:

FEB 2015



john pardey architects  
Beck Farm Studio St Leonards Road  
East End Lymington Hampshire SO41 5SR  
www.johnpardeyarchitects.com 01590 628465