

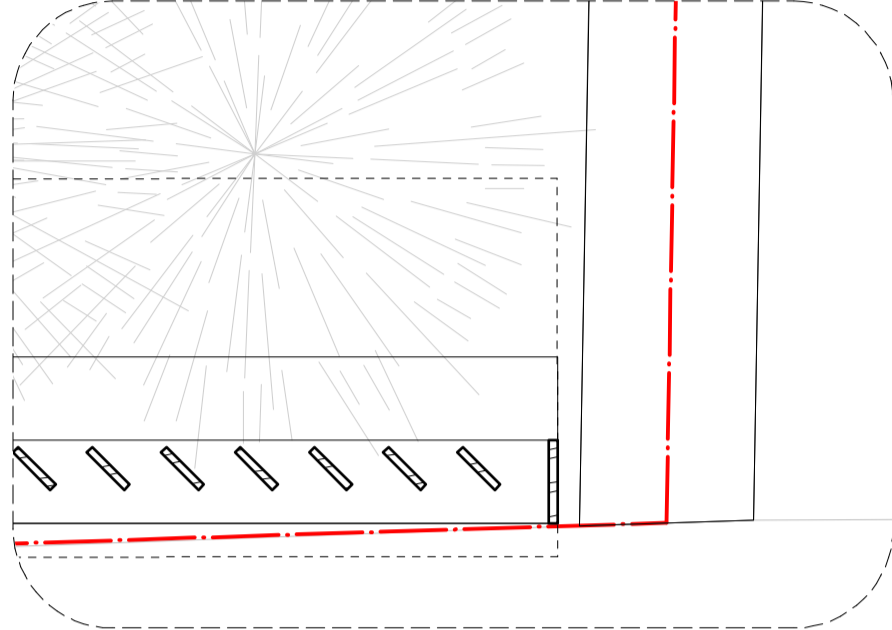

2 Plan Detail

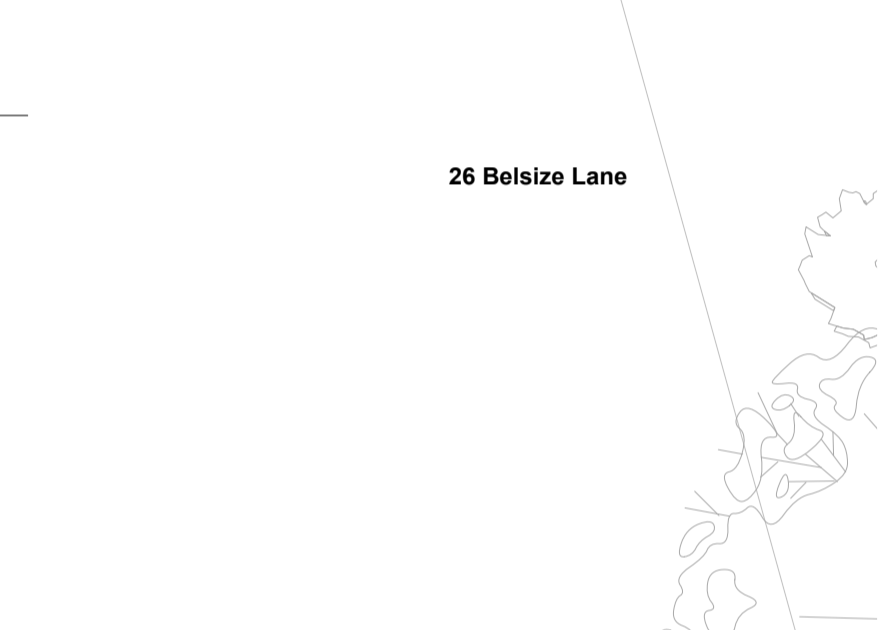

3 Plan Detail



Notes

Revision

Date

Notes

1

31.03.17

Issued For Planning

2

03.08.17

Line of fence altered due to root protection zones, identified by the Arboriculturalist. Low brick wall introduced following requests from Camden Planning Dept. Re-issued for planning

3

09.08.17

Camden Planning requirements altered. Details 2 & 3 Added. Re-issued for planning.

Key Plan

1. Do not scale drawings. All dimensions to be checked on site. Errors to be reported to architect. To be read in conjunction with all relevant architects services and engineers drawings

2. Contractors, sub-contractors and suppliers to verify any critical dimensions on site prior to fabrication of any building element. Any discrepancies to be reported to the architect.

3. This drawing to be read in conjunction with all relevant specifications, engineers and specialists consultants information and any discrepancies reported prior to installation.

ABA

Alison Brooks Architects Ltd
Studio 610, Highgate Studios, 53/79 Highgate Road, London NW5 1TL
T 0207 267 9777 F 0207 267 9772 E info@alisonbrooksarchitects.com

Project

:

28 Belsize Lane

Title

:

Front Land Plan

Client

:

Vivien & Edmund Bradley

Scale

:

1:50 (A1), 1:100 (A3)

Date

:

31.03.2017

Drawn By

:

RM

Drawing

:

2214_PL_356

Revision

:

3

1 Front Boundary Enclosure Plan

FOR PLANNING