

**Window Type 01: Retail shopfront**

Location: Ground Floor, SW Elevation  
 Window/Door Ref: G.W01 and G.D01  
 Spec-ref: H11/110A and L20/480A  
 Max U-value: 1.4W/m<sup>2</sup>K  
 Max G-value: 0.3  
 Frame type: Schuco FWS-50  
 Operation: Fixed pane, door  
 Frame finish: PPC Aluminium (Bronze, Tiger Drylac 068/60516)  
 Glazing outer pane: 8mm (Door 6mm) Pilkington Suncool 50/25 Pro T  
 Glazing inner pane: 6mm Pilkington Optifloat Clear  
 Acoustic Rating: 39dB

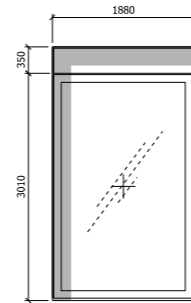

**Window Type 02: Retail shopfront**

Location: Ground Floor, SE Elevation  
 Window Ref: G.W02  
 Spec-ref: H11/110B  
 Max U-value: 1.4W/m<sup>2</sup>K  
 Max G-value: 0.3  
 Frame type: Schuco FWS-50  
 Operation: Fixed pane with overhead panel  
 Frame finish: PPC Aluminium (Bronze, Tiger Drylac 068/60516)  
 Glazing outer pane: 6mm Pilkington Suncool 50/25 Pro T  
 Glazing inner pane: 6mm Pilkington Optifloat Clear  
 Acoustic Rating: 39dB

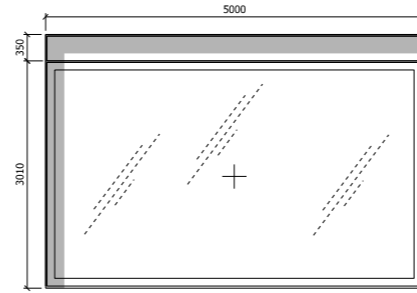

**Window Type 03: Retail shopfront**

Location: Ground Floor, SE Elevation  
 Window Ref: G.W03.A, G.W03.B  
 Spec-ref: H11/110C  
 Max U-value: 1.4W/m<sup>2</sup>K  
 Max G-value: 0.3  
 Frame type: Schuco FWS-50  
 Operation: Fixed pane with overhead panel  
 Frame finish: PPC Aluminium (Bronze, Tiger Drylac 068/60516)  
 Glazing outer pane: 10mm Pilkington Suncool 50/25 Pro T  
 Glazing inner pane: 10mm Pilkington Optifloat Clear  
 Acoustic Rating: 39dB

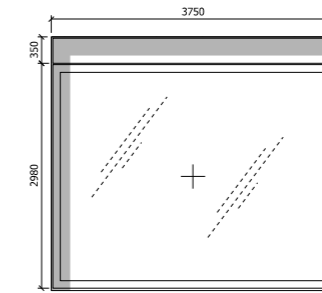

**Window Type 04: Retail shopfront**

Location: Ground Floor, SE Elevation  
 Window Ref: G.W04  
 Spec-ref: H11/110D  
 Max U-value: 1.4W/m<sup>2</sup>K  
 Max G-value: 0.3  
 Frame type: Schuco FWS-50  
 Operation: Fixed pane with overhead panel  
 Frame finish: PPC Aluminium (Bronze, Tiger Drylac 068/60516)  
 Glazing outer pane: 10mm Pilkington Suncool 50/25 Pro T  
 Glazing inner pane: 6mm Pilkington Optifloat Clear  
 Acoustic Rating: 39dB

NO. 01

NOTES:  
 DO NOT SCALE FROM THIS DRAWING.  
 ALL DIMENSIONS TO BE CHECKED ON SITE.  
 ALL OMISSIONS AND DISCREPANCIES TO BE REPORTED TO THE ARCHITECT IMMEDIATELY.  
 ALL RIGHTS RESERVED. THIS WORK IS COPYRIGHT AND CANNOT BE REPRODUCED OR COPIED OR MODIFIED IN ANY FORM OR BY ANY MEANS, GRAPHIC ELECTRONIC OR MECHANICAL, INCLUDING PHOTOCOPYING WITHOUT THE WRITTEN PERMISSION OF SQUIRE AND PARTNERS ARCHITECTS.

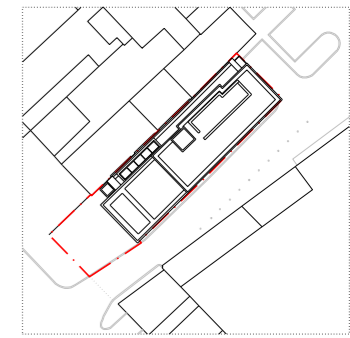

1:500@A3

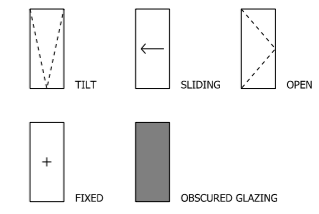

All dimensions are taken to structural opening.

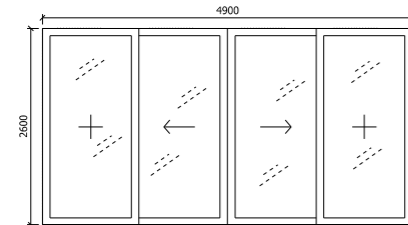

**Window Type 05: Residential Glazing**

Location: First Floor, SW Elevation  
 Window Ref: 1.W05  
 Spec-ref: L20/520A  
 Max U-value: 1.4W/m<sup>2</sup>K  
 Max G-value: 0.6  
 Frame type: Schuco ASS-70-HI-2D  
 Operation: Side fixed panes, central sliding doors  
 Frame finish: PPC Aluminium (Bronze, Tiger Drylac 068/60516)  
 Glazing outer pane: 6mm Pilkington Optifloat Clear  
 Glazing inner pane: 6mm Pilkington Optitherm S1 Plus  
 Acoustic Rating: 39dB

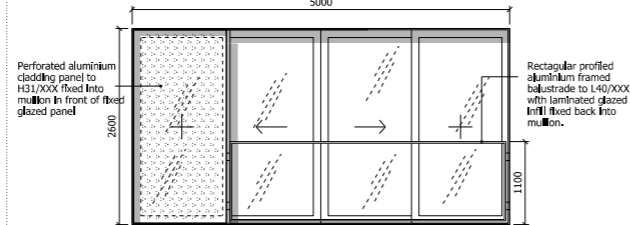

**Window Type 06: Residential Glazing**

Location: First Floor, SE Elevation  
 Window Ref: 1.W06  
 Spec-ref: L20/520B, H31/110A  
 Max U-value: 1.4W/m<sup>2</sup>K  
 Max G-value: 0.6  
 Frame type: Schuco ASS-70-HI-2D  
 Operation: Side fixed panes, central sliding doors  
 Frame finish: PPC Aluminium (Bronze, Tiger Drylac 068/60516)  
 Glazing outer pane: 6mm Pilkington Optifloat Clear  
 Glazing inner pane: 6mm Pilkington Optitherm S1 Plus  
 Acoustic Rating: 39dB

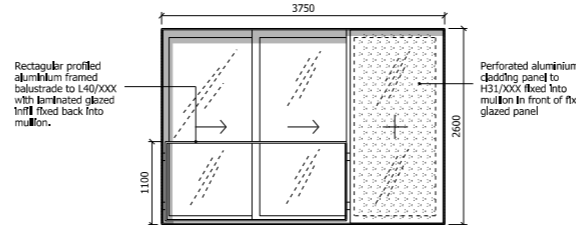

**Window Type 07: Residential Glazing**

Location: First Floor, SE Elevation  
 Window Ref: 1.W07  
 Spec-ref: L20/520C, H31/110A  
 Max U-value: 1.4W/m<sup>2</sup>K  
 Max G-value: 0.6  
 Frame type: Schuco ASS-70-HI-3E2  
 Operation: Side fixed pane, sliding doors  
 Frame finish: PPC Aluminium (Bronze, Tiger Drylac 068/60516)  
 Glazing outer pane: 6mm Pilkington Optifloat Clear  
 Glazing inner pane: 6mm Pilkington Optitherm S1 Plus  
 Acoustic Rating: 39dB

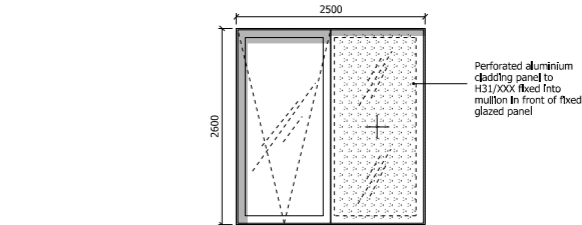

**Window Type 08: Residential Glazing**

Location: First, Second, Third and Fourth Floors, SE Elevation  
 Window Ref: 1.W08, 2.W08, 3.W08, 4.W08  
 Spec-ref: L10/330B, H31/110A  
 Max U-value: 1.4W/m<sup>2</sup>K  
 Max G-value: 0.6  
 Frame type: Schuco AWS-75-SI  
 Operation: Side fixed pane, tilt window (with restrictor)  
 Frame finish: PPC Aluminium (Bronze, Tiger Drylac 068/60516)  
 Glazing outer pane: 6mm Pilkington Optifloat Clear  
 Glazing inner pane: 6mm Pilkington Optitherm S1 Plus  
 Acoustic Rating: 39dB

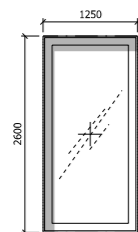

**Window Type 09: Residential Glazing**

Location: First, Second, Third and Fourth Floors, SE Elevation  
 Window Ref: 1.W09.A, 1.W09.B, 2.W09.A, 2.W09.B, 3.W09.A, 3.W09.B, 4.W09.A, 4.W09.B  
 Spec-ref: L10/330A  
 Max U-value: 1.4W/m<sup>2</sup>K  
 Max G-value: 0.6  
 Frame type: Schuco AWS-75-SI  
 Operation: Single fixed pane  
 Frame finish: PPC Aluminium (Bronze, Tiger Drylac 068/60516)  
 Glazing outer pane: 6mm Pilkington Optifloat Clear  
 Glazing inner pane: 6mm Pilkington Optitherm S1 Plus  
 Acoustic Rating: 39dB

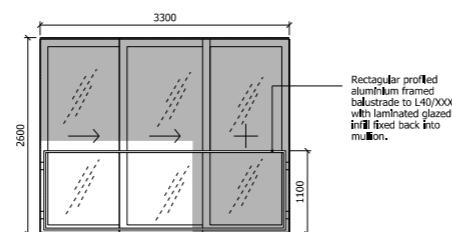

**Window Type 10: Residential Glazing**

Location: Second, Third and Fourth Floors, SW Elevation  
 Window Ref: 2.W10, 3.W10, 4.W10  
 Spec-ref: L20/520D  
 Max U-value: 1.4W/m<sup>2</sup>K  
 Max G-value: 0.6  
 Frame type: Schuco ASS-70-HI-3E2  
 Operation: Side fixed pane, sliding doors  
 Frame finish: PPC Aluminium (Bronze, Tiger Drylac 068/60516)  
 Glazing outer pane: 6mm Pilkington Optifloat Clear  
 Glazing inner pane: 6mm Pilkington Optitherm S1 Plus  
 Acoustic Rating: 39dB

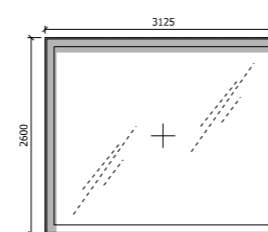

**Window Type 11: Residential Glazing**

Location: Second, Third and Fourth Floors, SE Elevation  
 Window/Door Ref: 2.W11, 3.W11, 4.W12  
 Spec-ref: L10/330C  
 Max U-value: 1.4W/m<sup>2</sup>K  
 Max G-value: 0.6  
 Frame type: Schuco AWS-75-SI  
 Operation: Single fixed pane  
 Frame finish: PPC Aluminium (Bronze, Tiger Drylac 068/60516)  
 Glazing outer pane: 8mm Pilkington Optifloat Clear  
 Glazing inner pane: 10mm Pilkington Optitherm S1 Plus  
 Acoustic Rating: 39dB

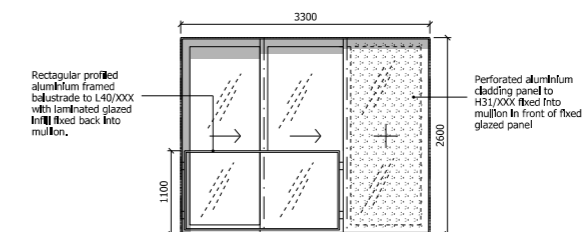

**Window Type 12: Residential Glazing**

Location: First, Second, Third and Fourth Floors, NE Elevation  
 Window Ref: 1.W12, 2.W12, 3.W12, 4.W12  
 Spec-ref: L20/520E  
 Max U-value: 1.4W/m<sup>2</sup>K  
 Max G-value: 0.6  
 Frame type: Schuco ASS-70-HI-3E2  
 Operation: Side fixed pane, sliding doors  
 Frame finish: PPC Aluminium (Bronze, Tiger Drylac 068/60516)  
 Glazing outer pane: 6mm Pilkington Optifloat Clear  
 Glazing inner pane: 6mm Pilkington Optitherm S1 Plus  
 Acoustic Rating: 36dB

Revision	Description	Date	Check	Rev

**SQUIRE & PARTNERS**

The Department Store  
 248 Ferndale Road, London SW9 8FR  
 T: 020 7278 5555

info@squireandpartners.com  
 www.squireandpartners.com

Project  
 192 Haverstock Hill  
 London, NW3

Drawing  
 Window & External Door  
 Schedule  
 1/2

Drawn	Date	Scale
SG	12/05/17	1:50@A1 1:100@A3
Job number	Drawing number	Revision
15047	G321_E_AL_001	-