

- General**
- 1.1 This drawing is to be read in conjunction with all Architect's, Engineer's and Services Engineer's drawings and specifications.
  - 1.2 Do not scale from any of the structural drawings. All dimensions to be verified on site and any discrepancies should be highlighted.
  - 1.3 The contractor is responsible for the stability of the building and adjoining structures during construction and shall design, install, adapt and maintain all necessary propping and temporary works. A method statement for the temporary works must be submitted to the contractor administrator for comment before work begins.
  - 1.4 Fire protection to all structural elements to Architect's details.
  - 1.5 All materials to comply with the relevant British Standard.

- Masonry**
- 2.1 All materials and workmanship to comply with BS 5628.

- Residual Hazards**
1. Scaffold ties on flank wall to be limited to avoid further damage
  2. Staircase to be propped full height whilst maintaining access to the upper floors for all residents
  3. Scaffolding to be designed to avoid loading on neighbouring properties.

**Note: Maintain safe access to all flats during repair work**

- Helibar bowties installed at 1200mm c/c and to be installed by a specialist contractor
- 6mm Helifix bed joint reinforcement installed at centers noted on drawing. Helibar to return down flank wall and to be installed by a specialist contractor
- Helifix - 6mm Helibar joint reinforcement every 6 courses

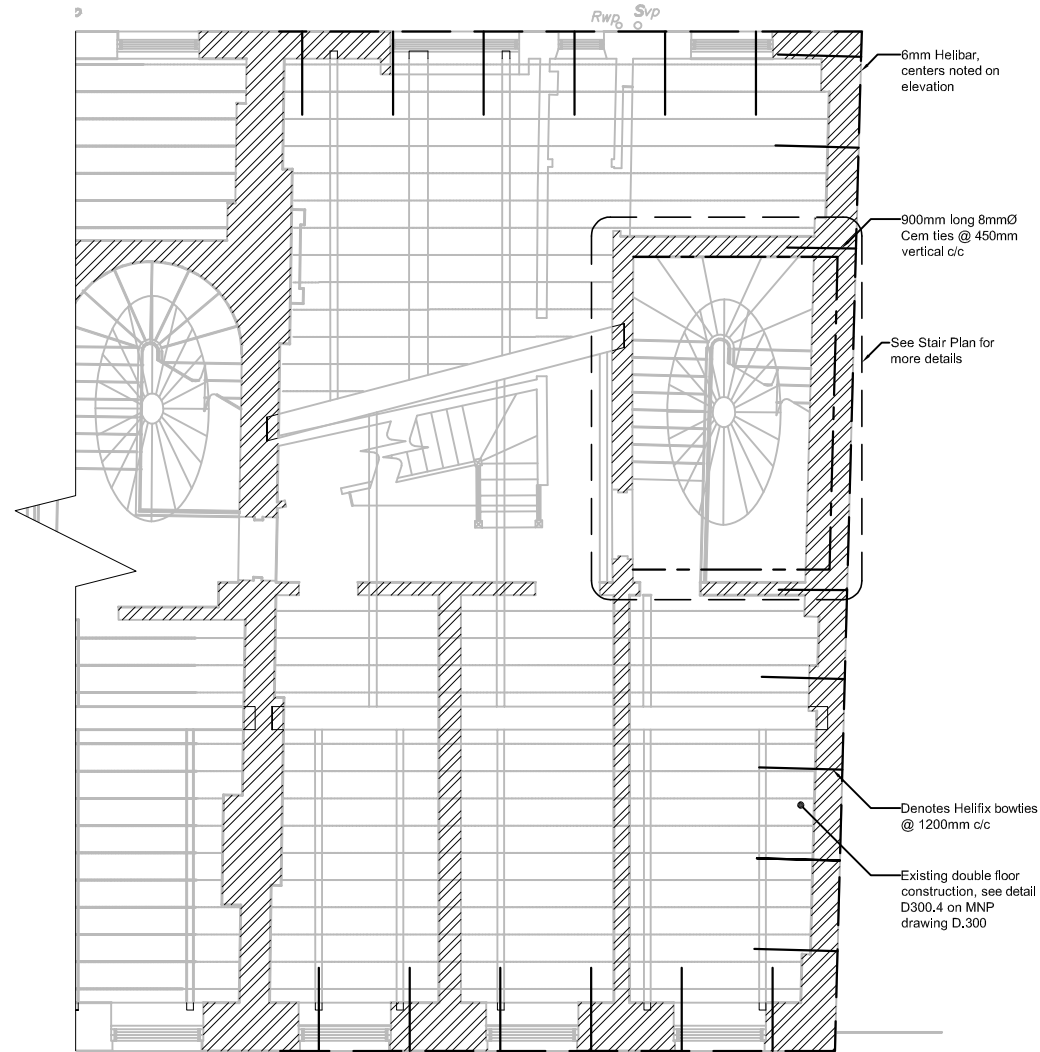

**Second Floor GA**  
Scale 1:100

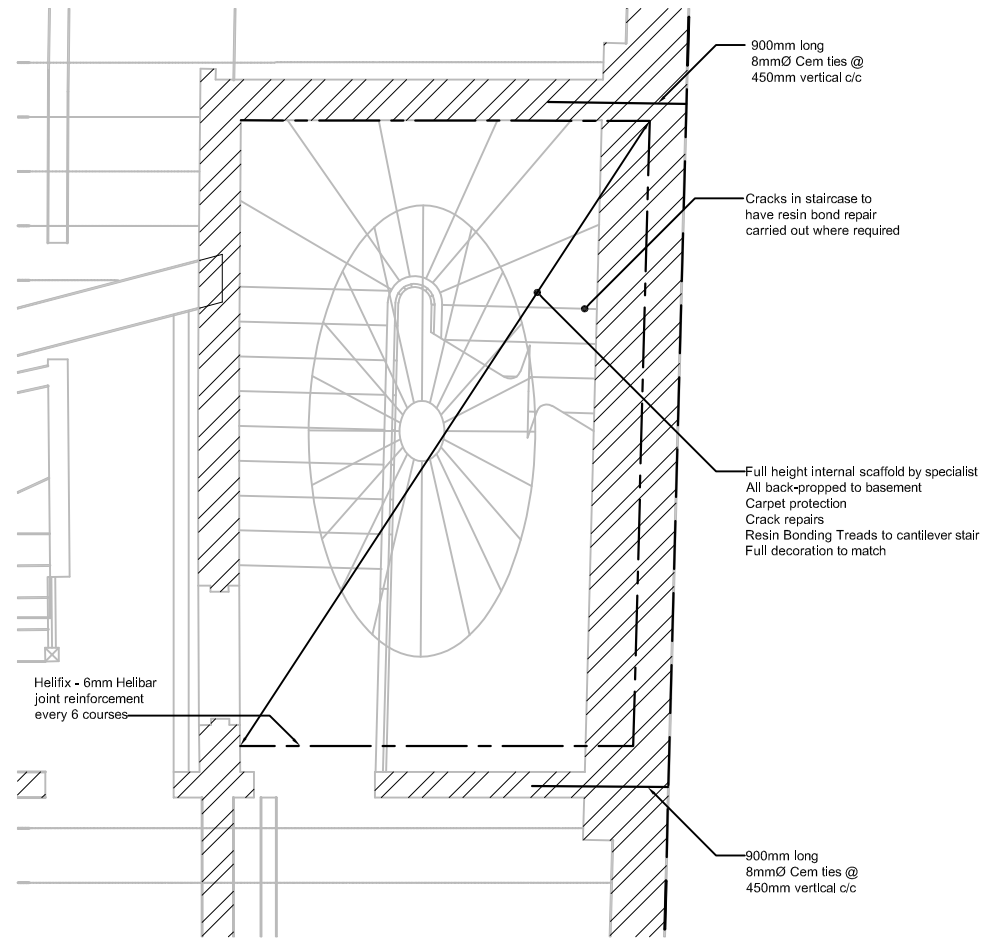

**Stair Plan**  
Scale 1:50

P1 Preliminary issue 28.09.16 RE

REV	COMMENTS	DATE	CHK
<b>PRELIMINARY</b>			
<b>mnp</b>			
<b>mason navarro pledge</b>			
Consulting Civil and Structural Engineers Bancroft Court, Hitchin, Hertfordshire SG5 1LH Telephone: 01462 632012 Fax: 01462 632233 Email: office@mnp.co.uk www.mnp.co.uk			
<b>CLIENT</b> <b>THE BEDFORD ESTATES</b> 29a Montague Street London WC1B 5BL Tel: 020 634 2888 Fax: 020 220 1729			
<b>PROJECT</b> <b>1-3 BEDFORD PLACE FACADE REPAIRS</b>			
<b>DRAWING TITLE</b> <b>SECOND FLOOR GA</b>			
SCALE <b>1:50 @ A3</b>		DATE <b>09.08.16</b>	
DRAWN BY <b>JE</b>		CHECKED BY <b>RE</b>	
JOB No. <b>214281</b>	DRAWING No. <b>GA-13</b>	REV <b>P1</b>	