

PRELIMINARY

NOTES

- THIS DRAWING IS TO BE READ IN CONJUNCTION WITH ALL ENGINEERS & ARCHITECT'S DRAWINGS FIGURED DIMENSIONS ONLY (NOT SCALING) TO BE USED. WHERE A CONFLICT OF INFORMATION EXISTS OR IF IN ANY DOUBT - **ASK**.
- CONSULTANTS TO BE INFORMED IMMEDIATELY OF ANY DISCREPANCIES BEFORE WORK PROCEEDS.

LEGEND

	NEW REINFORCED CONCRETE WALL
	NEW LOADBEARING BLOCKWORK WALL
	NEW LOADBEARING STRUCTURAL STUD PARTITION
	NEW NON-LOADBEARING WALL
	NEW NON-LOADBEARING BRICK WALL
	EXISTING LOADBEARING WALLS BELOW
	EXISTING INTERNAL NON-LOAD BEARING WALL
	EXISTING MASONRY WALL
	EXISTING WALL TO BE DEMOLISHED
	STEEL/TIMBER BEAM
	STEEL COLUMN
	JOISTS SPAN DIRECTION

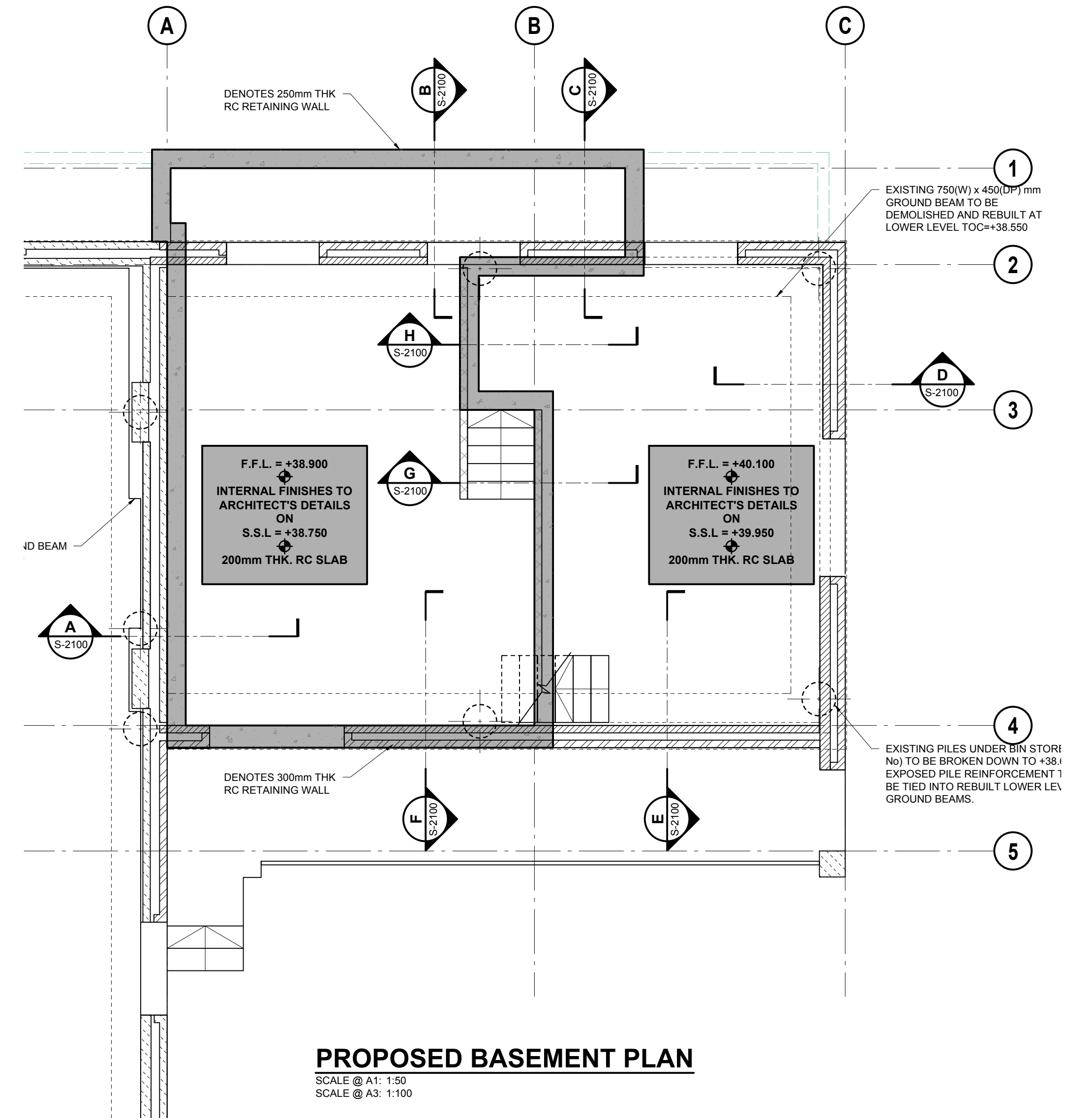

NOTE:
 EXISTING STRUCTURE WHERE SHOWN ARE BASED ON MLM DRAWING 662761/B/S001-C7, FINAL ISSUE DRAWING. THE CONTRACTOR SHALL CARRY OUT SUITABLE INVESTIGATIVE WORKS OUT TO VERIFY ALL EXISTING STRUCTURE ARRANGEMENTS.

P1	07.08.17	ISSUED FOR COMMENT	BB	OC
ISSUE	DATE	DESCRIPTION	DRN	P.E.
			ORIG	P.D.
ISSUE STATUS		<input checked="" type="checkbox"/> PRELIMINARY (P1, P2, P3 etc.)	<input type="checkbox"/> PLANNING (PL1, PL2, PL3 etc.)	
		<input type="checkbox"/> TENDER (T1, T2, T3 etc.)	<input type="checkbox"/> CONSTRUCTION (C1, C2 etc.)	

Barrett Mahony Consulting Engineers, Civil, Structural, Project Management.
 E-mail: info@bmceuk.com Web: www.bmceuk.com
 London Office: 12 Mill Street, London SE1 2AY, United Kingdom
 Tel.: +44 (0) 20 3750 3530
 Dublin Office: Sandwith House, 52-54 Lower Sandwith Street, Dublin 2, Ireland.
 Tel.: (01) 677 3200 Fax: (01) 677 3164



CLIENT	JAA STUDIO		
PROJECT TITLE	GUINNESS COURT ST. EDMUND'S TERRACE		
DRAWING TITLE	PROPOSED BASEMENT PLAN		
SCALE @ A1 AS SHOWN	JOB NO. 17708	DRAWING NO. S-2000	ISSUE P1