

**Halo LED Wordmark Lettering - 1:20**

2 sets of individual White painted aluminium Wordmark lettering 150mm high.  
 Lettering to be Halo illuminated by White LED's modules mounted within inset 25mm deep 050 opal acrylic letter backs.



Similar wordmark schemes



**Exploded Face View  
Scale N.T.S**

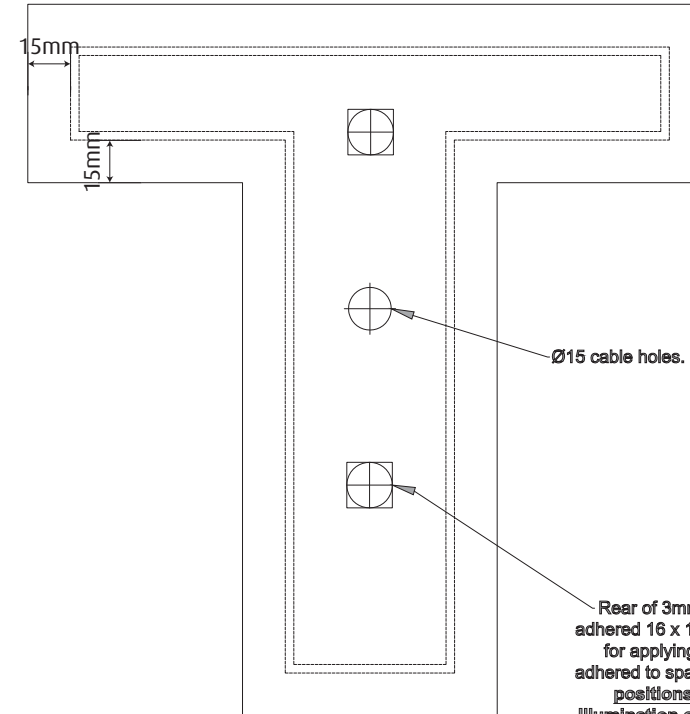

**Typical Side Section Thru  
Scale 1:1**

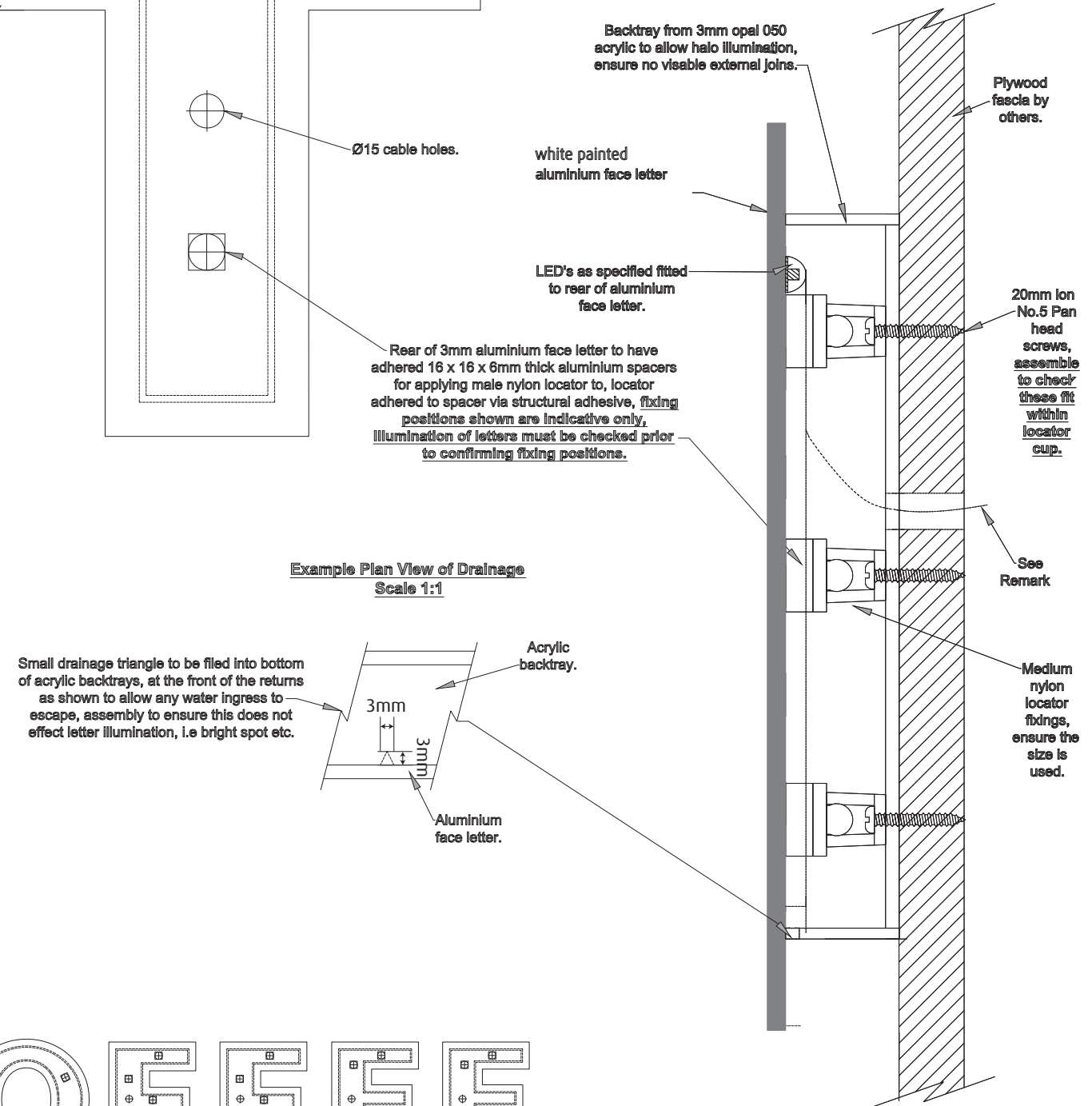

**FACE VIEW: N.T.S**

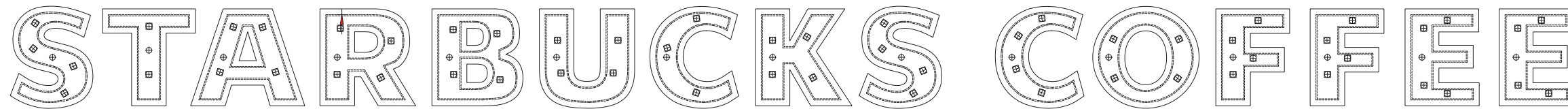

Starbucks, Newcastle, Jesmond

<p><b>NIS SIGNS (LEICESTER) LTD</b>                  65 OAKLAND ROAD, LEICESTER, LE2 6AN.                  Tel: 0116 270 6228. Fax: 0116 270 3347                  Email: info@signs-nis.co.uk                  Web: www.signs-nis.co.uk</p>	Client: STARBUCKS	Drawing No: 16-082 - Starbucks -	Rev No: Rev A	Revision Notes: 1) Initial issue	All site dimensions to be verified prior to manufacture. Do not scale from this drawing Copyright 2010. This document is the property of Nis Signs (Leicester) Ltd and must not be used, reproduced or disclosed to any persons without the written consent of Nis Signs (Leicester) Ltd.
	Address:	Job Location: universal/jobs/Starbucks/	Scale: As Stated @ A3		
	Drawn By: DW	Checked By:	Date: 01/03/2016		