

This drawing forms part of a set of Planning Application drawings.

It is not intended for Building Control or Construction purposes.

Do not scale off this drawing. If in doubt, please ask.

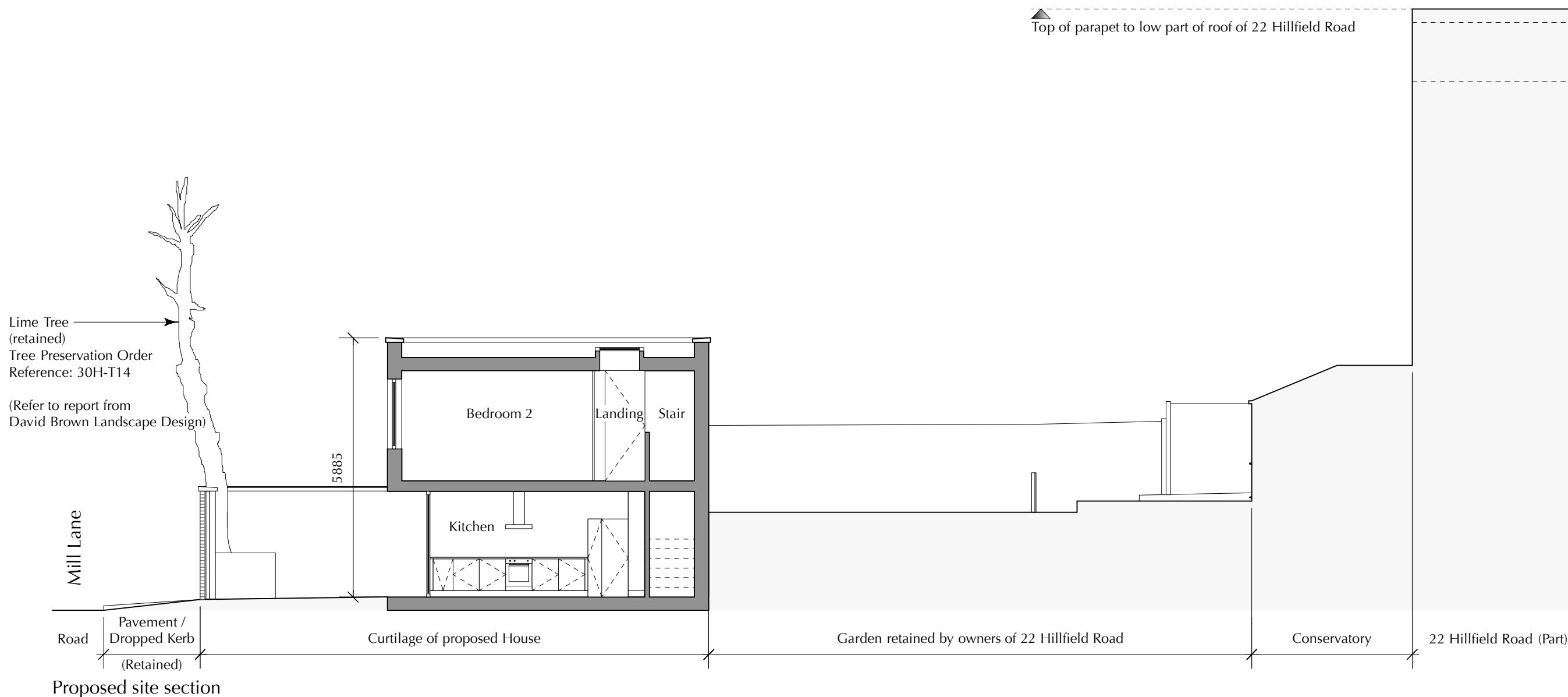

Project / Location: 22 Hillfield Road, West Hampstead, London, NW6 1PZ
Client: Mrs. H. M. Boorer & Ms. R. Halpin
Drawing Title: Proposed Site Section
Scale: 1:100 @ A3

0 5 10 M
Drawing No: PL 004
Date: 07.05.14
Drawn by: KL
Purpose: Planning Application

KENNETH LYNCH
ARCHITECTURAL DESIGN

1 Sydenham Court, 18 Kingsborough Gardens, Glasgow G12 9QD
T: 0141 334 7173 M: 07989 302 456 E: ken@klad.co.uk W: klad.co.uk ©