

This drawing forms part of a set of Planning Application drawings.

It is not intended for Building Control or Construction purposes.

Do not scale off this drawing. If in doubt, please ask.

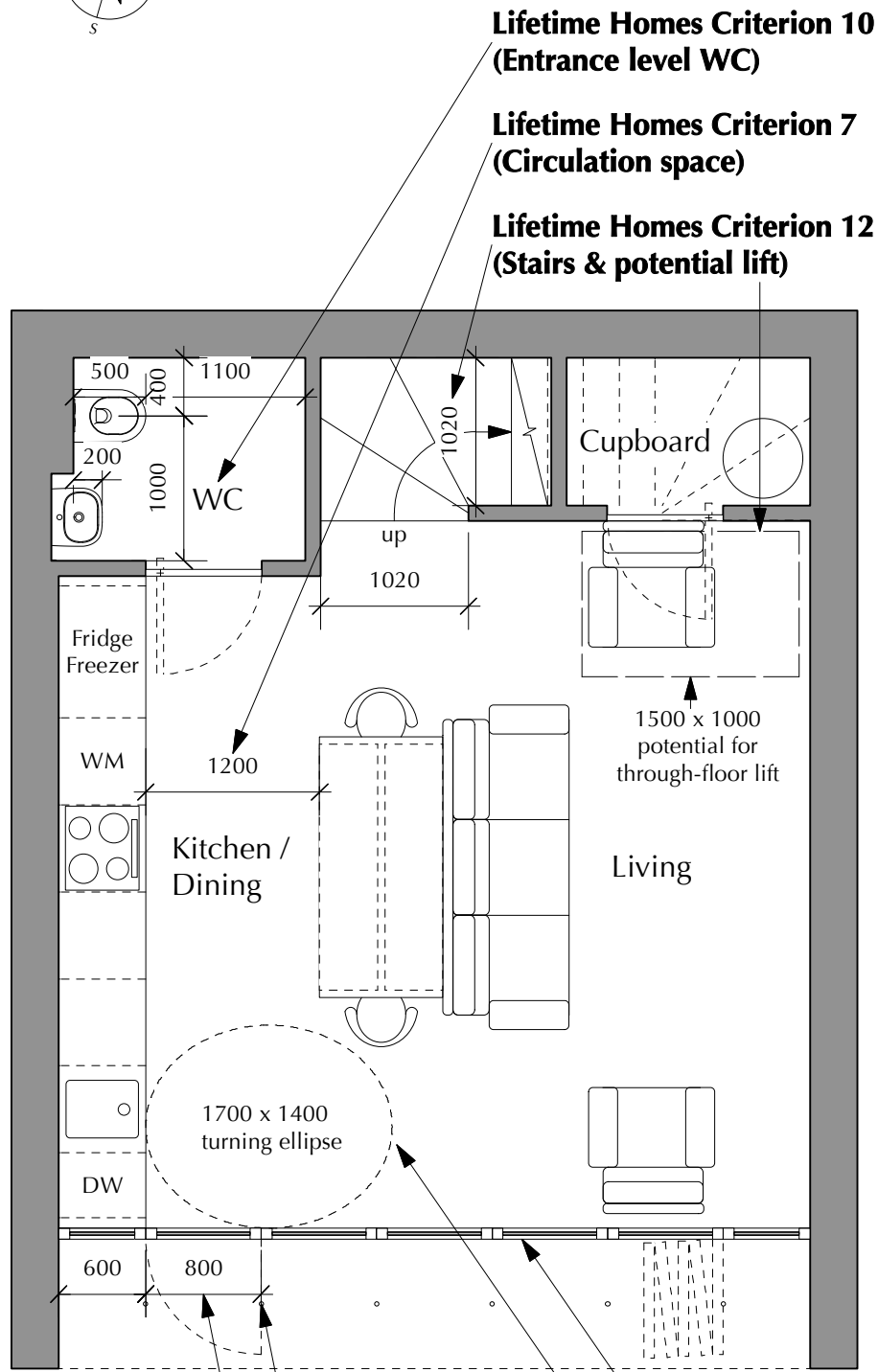

Ground Floor

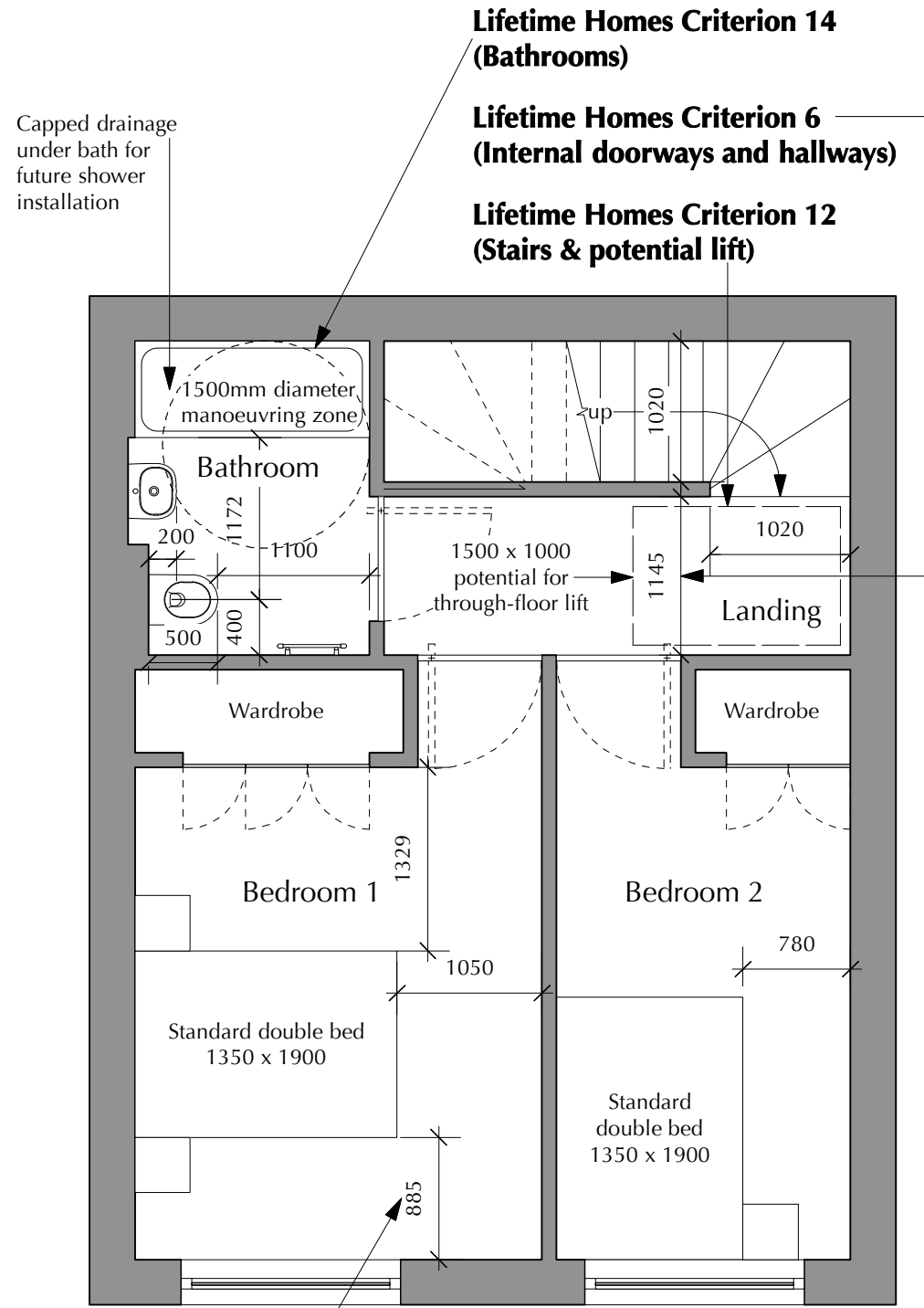

First Floor

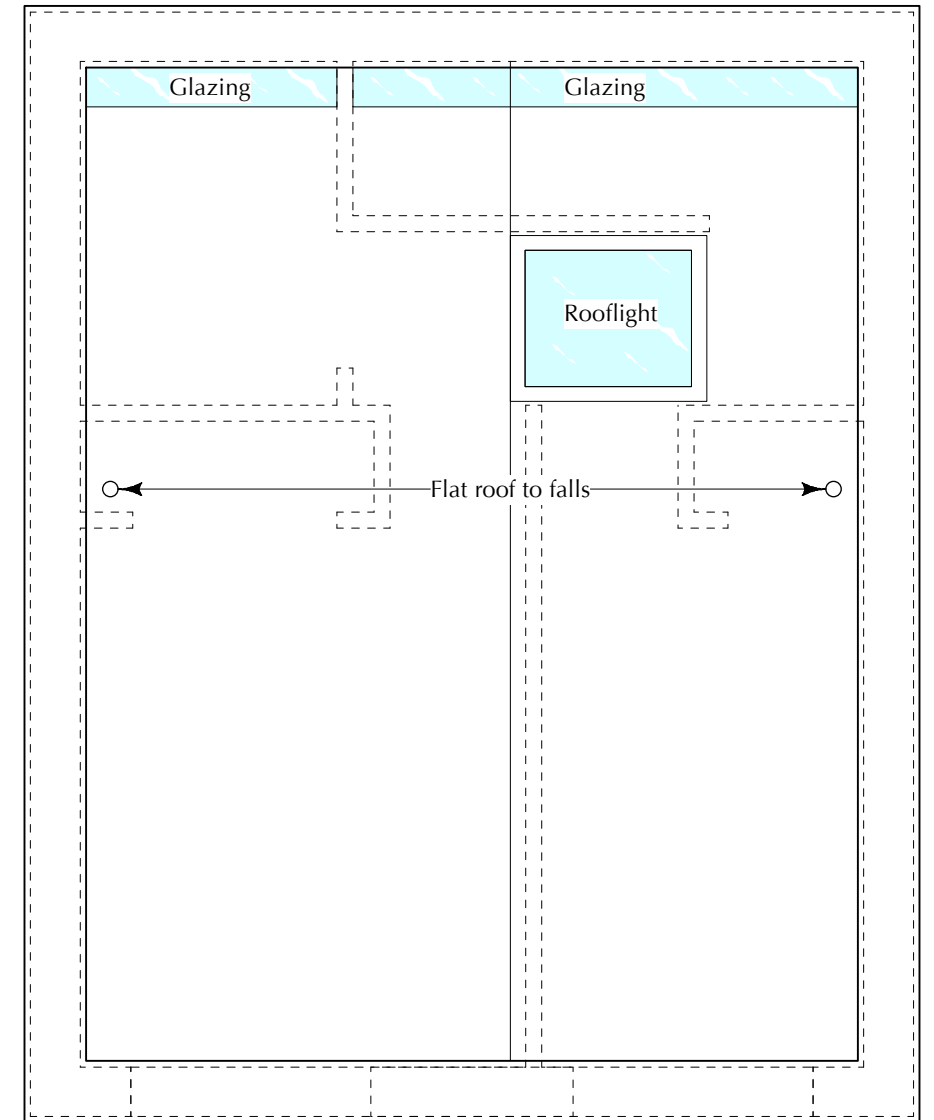

Roof Plan

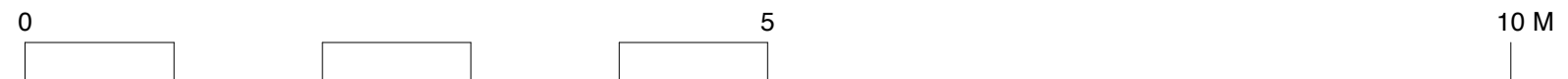

Lifetime Homes Criterion 5 (Lighting)

Lifetime Homes Criterion 4 (Entrances)

Lifetime Homes Criterion 15 (Glazing)

Lifetime Homes Criterion 7 (Circulation space)

Project / Location: 22 Hillfield Road, West Hampstead, London, NW6 1PZ
 Client: Mrs. H. M. Boorer & Ms. R. Halpin

Drawing Title: Proposed Plans
 Scale: 1:50 @ A3

Drawing No: PL 005
 Drawn by: KL

Date: 07.05.14
 Purpose: Planning Application

KENNETH LYNCH
ARCHITECTURAL DESIGN

1 Sydenham Court, 18 Kingsborough Gardens, Glasgow G12 9QD
 T: 0141 334 7173 M: 07989 302 456 E: ken@klad.co.uk W: klad.co.uk ©