

GENERAL NOTES

DO NOT SCALE FROM THE DRAWING.

ALL DIMENSIONS ARE GIVEN TO STRUCTURE UNLESS INDICATED OTHERWISE.

ALL DIMENSIONS TO BE CHECKED ON SITE PRIOR TO COMMENCEMENT OF WORK.

DRAWINGS TO BE READ IN CONJUNCTION WITH ALL DRAWING ARCHITECT'S DRAWINGS, CONSULTANTS AND SPECIALIST DRAWINGS, CONSTRUCTION NOTES, SPECIFICATIONS AND EMPLOYER'S REQUIREMENTS WHERE APPLICABLE.

ANY DISCREPANCY MUST BE BROUGHT TO THE ATTENTION OF PKCO, IF IN DOUBT, ASK.

ANY MODIFICATION TO THE DRAWING MUST BE CARRIED OUT BY PKCO.

THE DRAWING REMAINS UNDER THE COPYRIGHT OF PKCO ARCHITECTS LIMITED. PLEASE OBTAIN PERMISSION BEFORE COPYING.

THESE METHODS OF CONSTRUCTION REQUIRE THE FABRICATOR TO CHECK THE FRAME ALL ELEMENTS OF FRAME INCLUDING DOWELS, LOCATIONS, NOTCHES, FINISHING, LABELS, RUBBER AND WIND BRACING TO BE TO FRAME MANUFACTURER'S DESIGN, DETAIL AND SPECIFICATION.

ALL STRUCTURAL ELEMENTS ARE SHOWN INDICATED. FOR ALL ELEMENTS OF STRUCTURE REFER TO STRUCTURAL ENGINEER AND SPECIALIST CONSULTANTS FOR DESIGN, DETAIL AND SPECIFICATION.

ALL MECHANICAL AND ELECTRICAL ELEMENTS ARE SHOWN INDICATED. FOR ALL MECHANICAL AND ELECTRICAL ELEMENTS REFER TO MECHANICAL AND ELECTRICAL ENGINEERS FOR DESIGN, DETAIL AND SPECIFICATION.

FOR BUILDING SERVICES ENGINEER AND SPECIALIST SUB CONTRACTOR DESIGN, DETAIL AND SPECIFICATION.

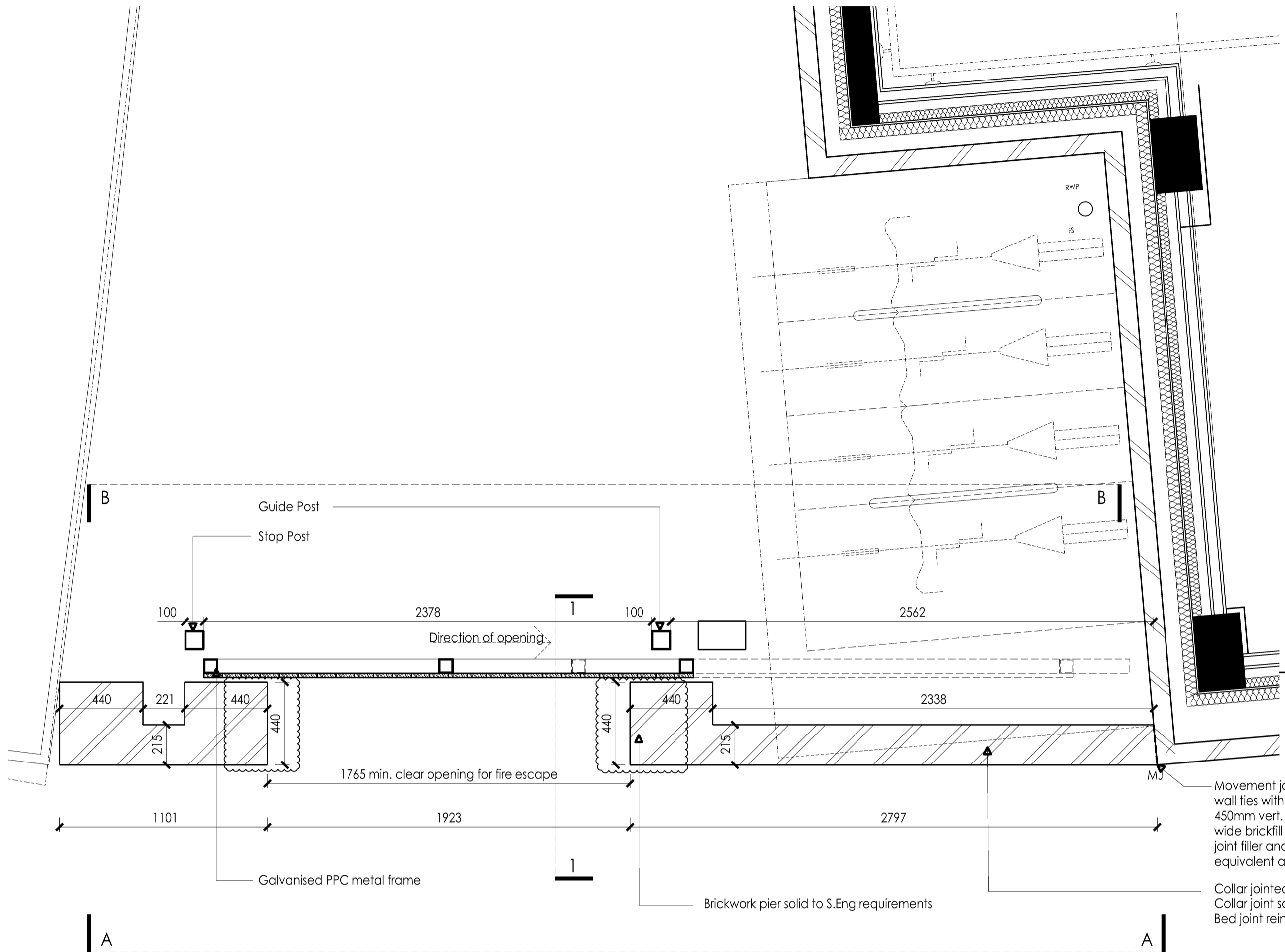

Plan

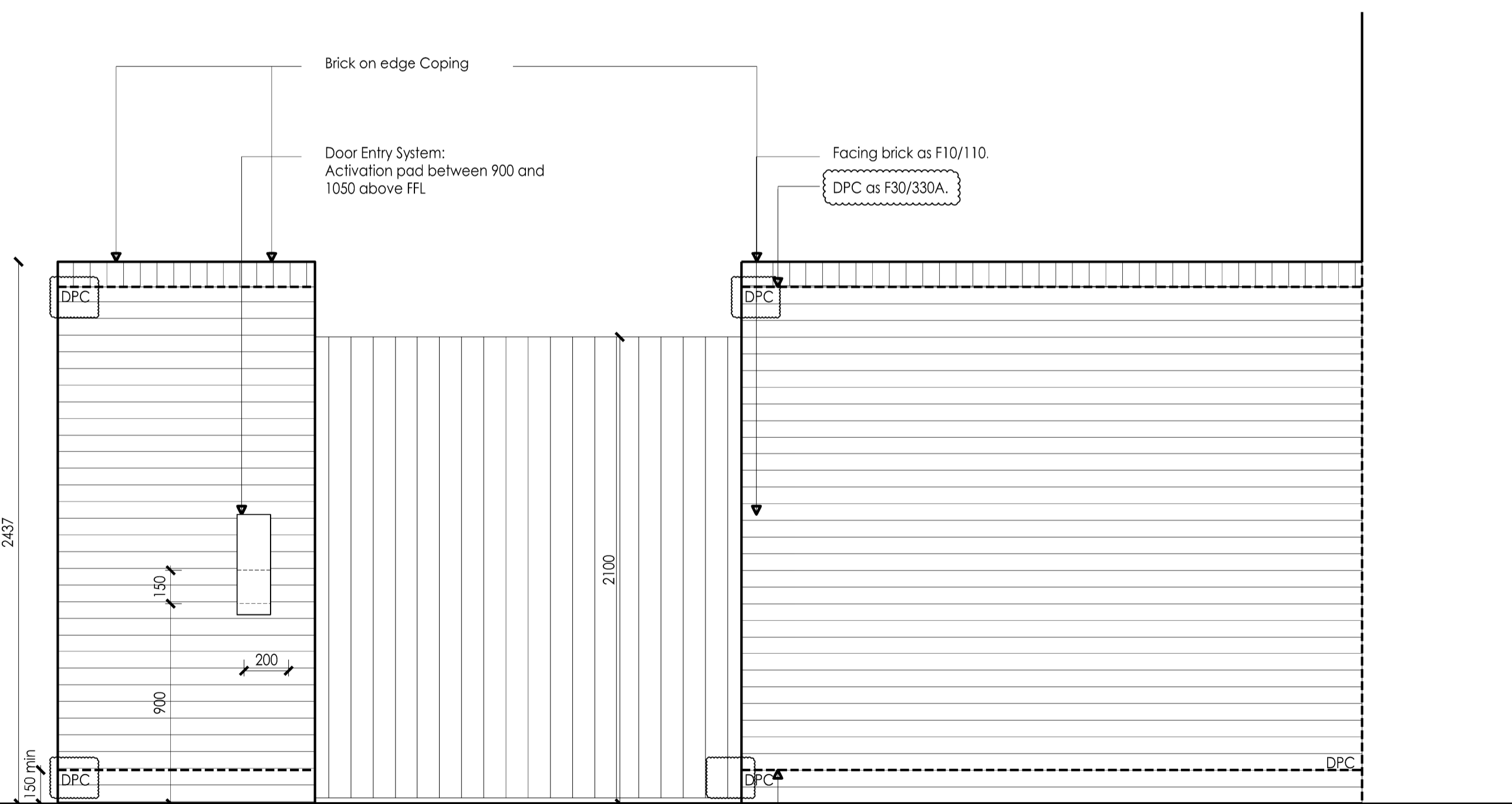

Elevation A: Front

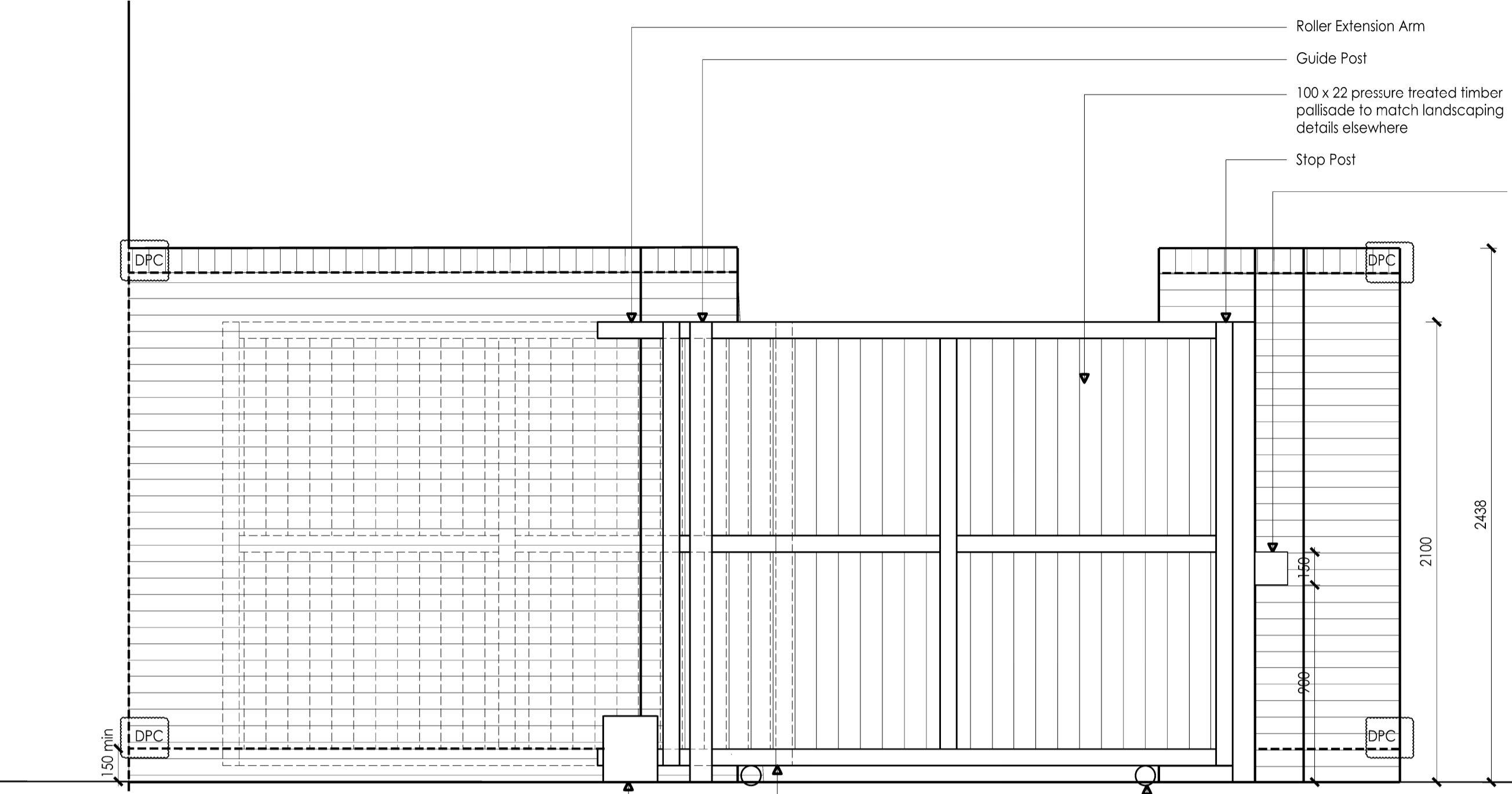

Elevation B: Rear

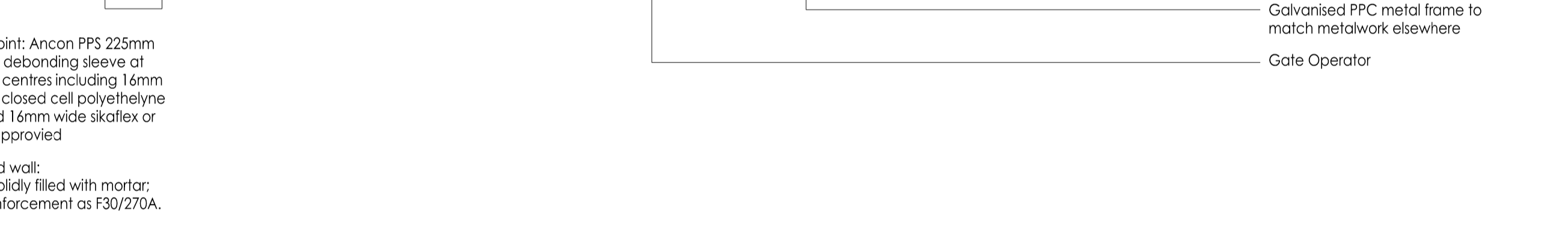

Section 1

Push button conforming to BS EN 179:2008: Activation pad between 900 and 1050 above FFL, operating force no greater than 150N, shrouded to prevent unauthorised use from exterior. Door to be fail safe to open on loss of power.

Note:
Layout Indicative only, subject to specialist manufacturer proposals

Note:
Safety systems to be installed in accordance with:
BS EN 13241-1 the Product Standard for powered doors and gates (and most relevant to the CPR)
BS EN 12604 & BS EN 12605 on mechanical requirements and tests
BS EN 12453 & BS EN 12445 on requirements and test for powered gates
BS EN 12635 on installation and use
BS EN 12978 on safety devices for power operated doors and gates

These standards no longer give full 'presumption of conformity' with the Machinery Directive (2006/42/EC)

Therefore manufacturers will have to show in detail in the technical file for each powered gate how they have designed and constructed the gate to meet the EHSRs excluded from 'presumption of conformity' and be safe for the gate's foreseeable lifetime, taking account of foreseeable misuse, as well as intended use.

DATE	REV.	DESCRIPTION	BY	CHECKED
25.04.17	B	Coping updated: Coping updated; DPC note added; Dims added	PH	PH
04.04.17	A	Notes added in response to B11 I001 from ECL. Rev added to suit S.Eng requirements	AL	PH

PKCO
an HR company

5 - 8 HARDWICK STREET
LONDON EC1R 4RG
TEL: 020 - 7372 - 8918
www.pkco.co.uk

ARCHITECTS INTERIOR DESIGNERS
MASTER PLANNERS URBAN DESIGNERS

CLIENT	Kier Group
PROJECT	Greenwood Centre
DRAWING TITLE	Front Gate Detail
STATUS	TENDER
SCALE	1:20@A1
DATE	2017.03
DRAWING NO.	1213_WD705
REVISION	B