

SECOND FLOOR GA OVERVIEW

Scale 1 : 500

Room 212

DO NOT SCALE. Use figured dimensions only. Contractor is to check all dimensions before commencement of work. This drawing is copyright. This data to be used as a guide only - not as live data. This drawing must only be used for the purpose for which it is supplied.

FLOOR FINISHES KEY

PROPOSED FLOOR FINISH TYPE 1
Milkken Carpet Tiles
Design Name: Admit One
Colour: ADM4 Soundcheck

WALL TYPES KEY

PROPOSED WALL TYPE 1
Full Height Gyproc stud wall up to underside of existing ceiling. Two Gyframe 48 S 50 °C Stud frameworks braced at max 1200mm centres. Studs at 600mm centres. 50mm lever acoustic partition roll insulation. 1 layer of 12mm plywood to each side. 2 layers of 12.5mm Gyproc Soundbloc plasterboard to each side. Taped and sealed with skim coat plaster. To painted to RAL: TBC

PROPOSED WALL TYPE 2
60mins Fire rated aluminium framed double glazed partition.

OTHER

Existing Floor Power and Data Box- RETAINED

Existing Floor Power and Data Box- RELOCATED

Proposed double power, double data (CAT 6) sockets recessed within new wall

Proposed 65 inch wall mounted TV

60mins Fire rated aluminium frame with solid timber veneer door with vision panel to match adjacent glazed partition door.

NOTE:
Proposed Rooms 212a, 212b & 212c to have 18mm structural plywood sheeting installed over existing floorboards prior to installing new stud partitions. Plywood edges to be located onto below floor joists and screw fixed at perimeter and 600 mm centres to suit floor joists. Suitable feather zone to be provided in lobby to ensure no trip hazard.

Proposed double-glazed, 60mins fire-rated, acoustic partition up to 3000mm from FFL. To have integral blinds and solid timber door within aluminium frame to have individually suited lock. Refer to dwg No. 2525-514 for details

Outline of acoustic partition stud wall above

450mm wide plywood feather zone to be provided outside meeting rooms to ensure no trip hazard.

Proposed double-glazed, 60mins fire-rated, acoustic partition up to 3000mm from FFL with solid timber door within aluminium frame. Doors to have individually suited locks. Refer to dwg No.: 2525-515 for details

Proposed full-height acoustic partition stud wall. Refer to dwg No. 2525-513 for details

Existing step void to be filled with timber frame structure with 18mm structural plywood over.

Existing Plasterboard partition wall to be removed to allow for access from existing single door. Allow for making good to junctions with existing walls.

Existing door to be re-instated following removal of existing partition wall.

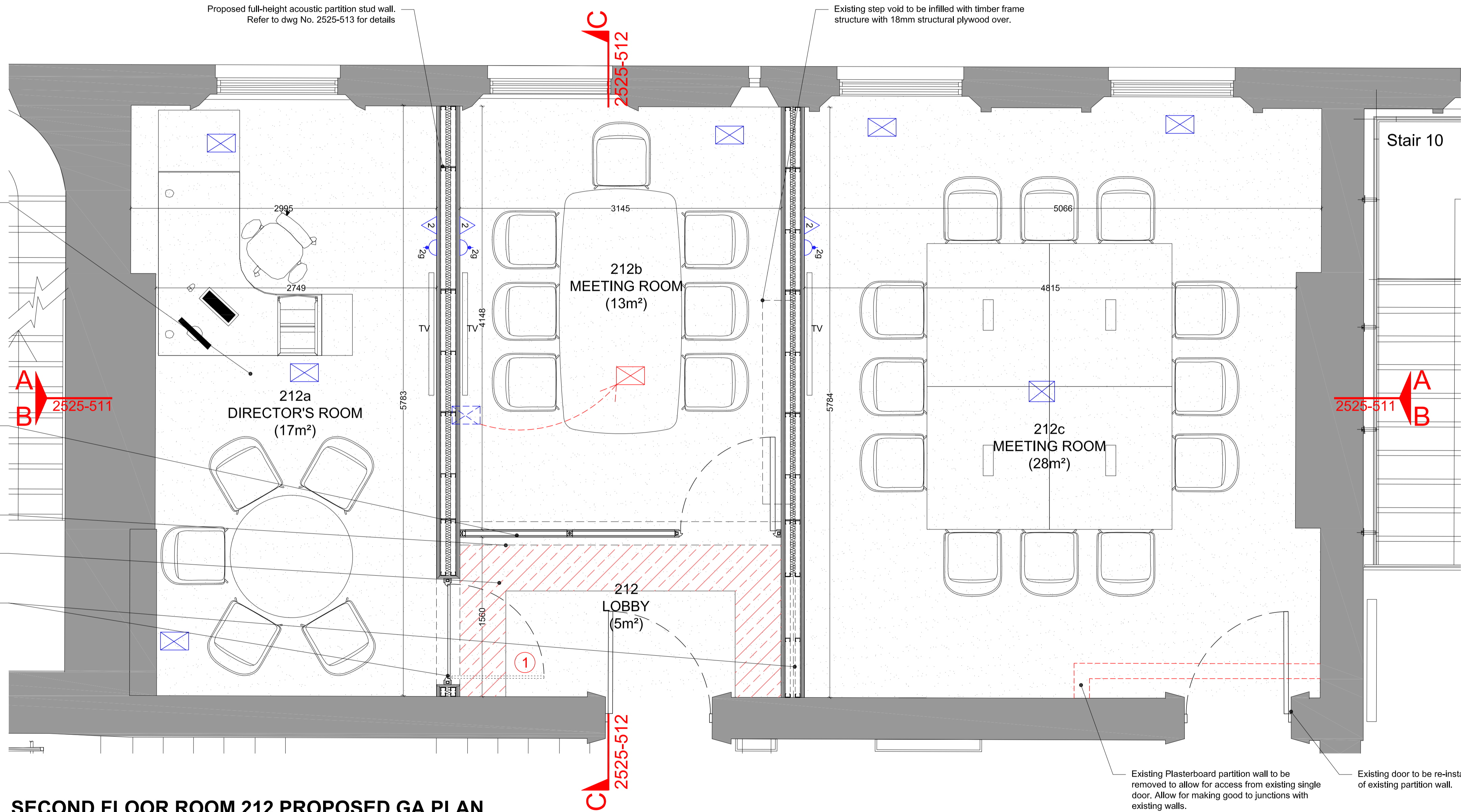

NOTES:
Western range existing plans based on PDF drawings provided by VTEC. All stated areas are taken from Accommodation schedule provided by VTEC.

A	13/07/17	CD	FOR LISTED BUILDING CONSENT	AF	RS
/	22/02/17	MP	FOR LISTED BUILDING CONSENT	AF	RS
no.	date	by	revision details	Ckd	App

STRALA architects

Studio 103
The Courtyard Royal Mills
Ancoats Manchester M4 5BA

Tel: 0161 236 5986
Fax: 0161 236 5884
E: office@strzarch.co.uk



NETWORK RAIL TECHNICAL APPROVAL AUTHORISED FOR ISSUE:

DESIGNER.....

CHECKER.....

AUTHORISER (CRE).....

DATE.....

APPROVED FOR FORM (NOT APPLICABLE)

CEM.....

DATE.....

project
LONDON KING'S CROSS TRAIN STATION ACCOMMODATION PLANS

drawing status
FOR LISTED BUILDING CONSENT

drawing title
WESTERN RANGE SECOND FLOOR ROOM 212 PROPOSED GA PLAN

drawn by	date	checked by	date
CD	12/07/17	AF	13/07/17

CRE Approved by	date	CEM Reviewed by	date
RS	13/07/17		

Network Rail dwg no.	revision no.	sht no.
	A	1 of 1

consultant dwg no.	scale	sht size
2525-509	1:25	A1

SECOND FLOOR ROOM 212 PROPOSED GA PLAN

Scale 1 : 25