

existing aluminium flue/vents
 extended from 228mm above
 existing parapet line to 415mm
 above additional raised party wall
 parapet line

Apex of new mansard roof 900mm
 above existing extended party wall -
 reclaimed london stock brick party
 walls selected to match colour,
 dimensions, porosity and surface
 texture with 'on edge' brick coping
 as per existing butterfly rear wall
 and projecting tile drip. Bricks to be
 sound, clean, free from bitumen/paint.

Lime based mortar (not stronger
 than 1 part NHL 3.5 : 3 parts well
 graded sharp sand colour matched
 to existing mortar) and pointing
 with flush 'bagged' finish NOT
 weather struck on party wall.

Finish to party wall on adjoining terrace
 to be rendered as existing

unpainted cement render with concrete coping

red line indicates new mansard roof section line

reinstated original cornice
 in traditional materials

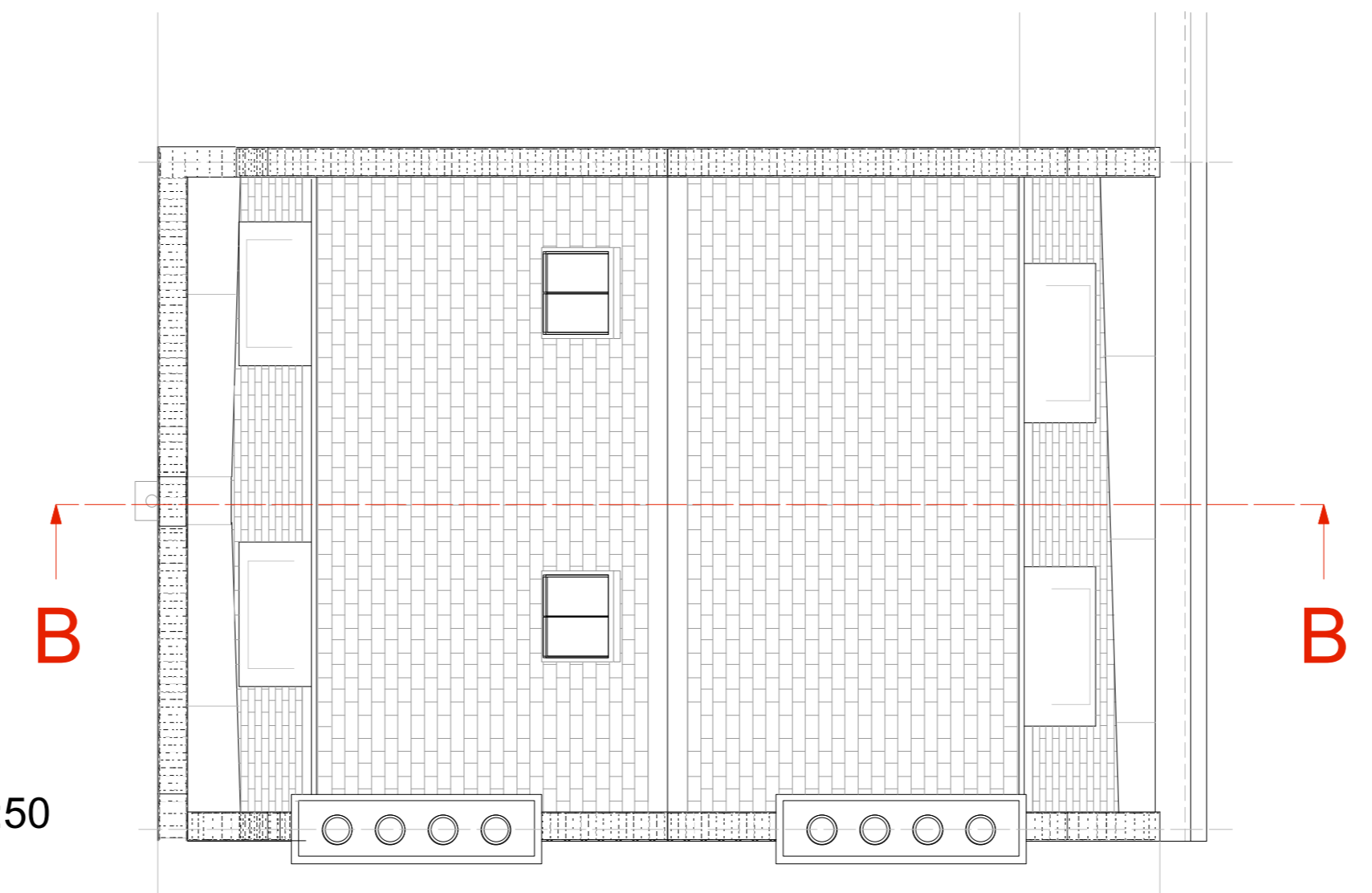

KEYPLAN 1:50

