

08 Hard Landscape Strategy: Amendment Response

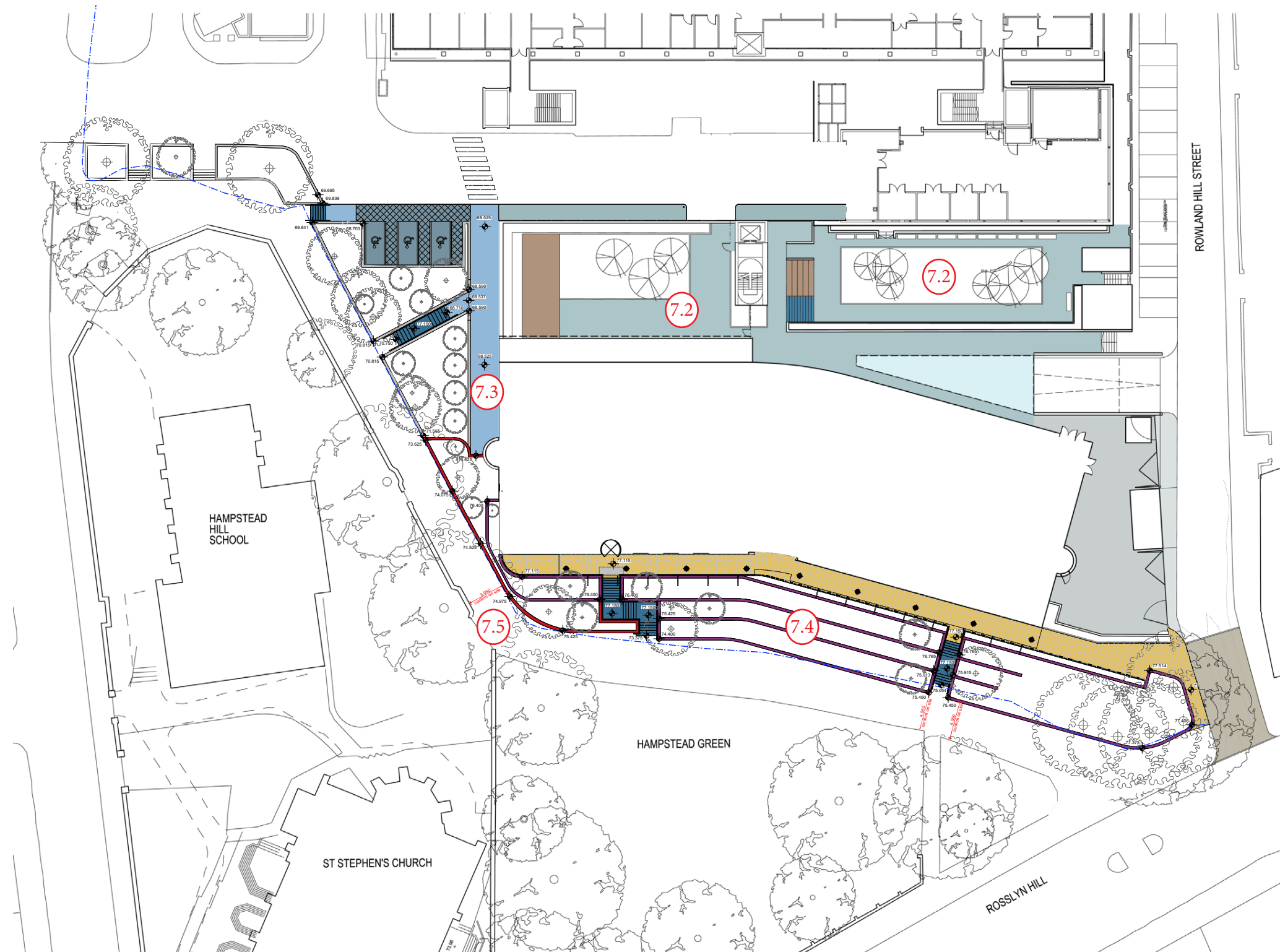

7.1

Material palette for hard landscaping retained - refer to material's key on the next page.

7.2

The UCL Garden and the Heath Strange Garden spaces to the east of the building are not part of this amendment.

7.3

North courtyard removed, but the proposed path adjacent to the North side of the building retained. The material palette for the path remains unchanged.

The two proposed car park spaces retained. The second car park space upgraded to become an accessible bay. A third accessible car park space added to the scheme in this location. The materials proposed for this area remain unchanged.

7.4

The materiality of the terraces and the aim to keep only a 150mm of the concrete visible remain unchanged. The low level terrace offering seating opportunities has been reduced to 450mm height.

7.5

The proposal to use brick on the retaining wall to the North- West corner remains unchanged in this amendment. The only changes constitutes in adding a few "steps" to the already staggered arrangement of this wall.

The proposed landscape redesign aims to return the public footpath to its existing footprint as closely as possible, maintaining the minimum existing width in all locations.

Fig 15: Extract of Section 5.8 of the originally submitted Design and Access Statement - Hard Landscape Strategy - Proposed Amendment