

02 Landscape Redesign: Proposal Overview

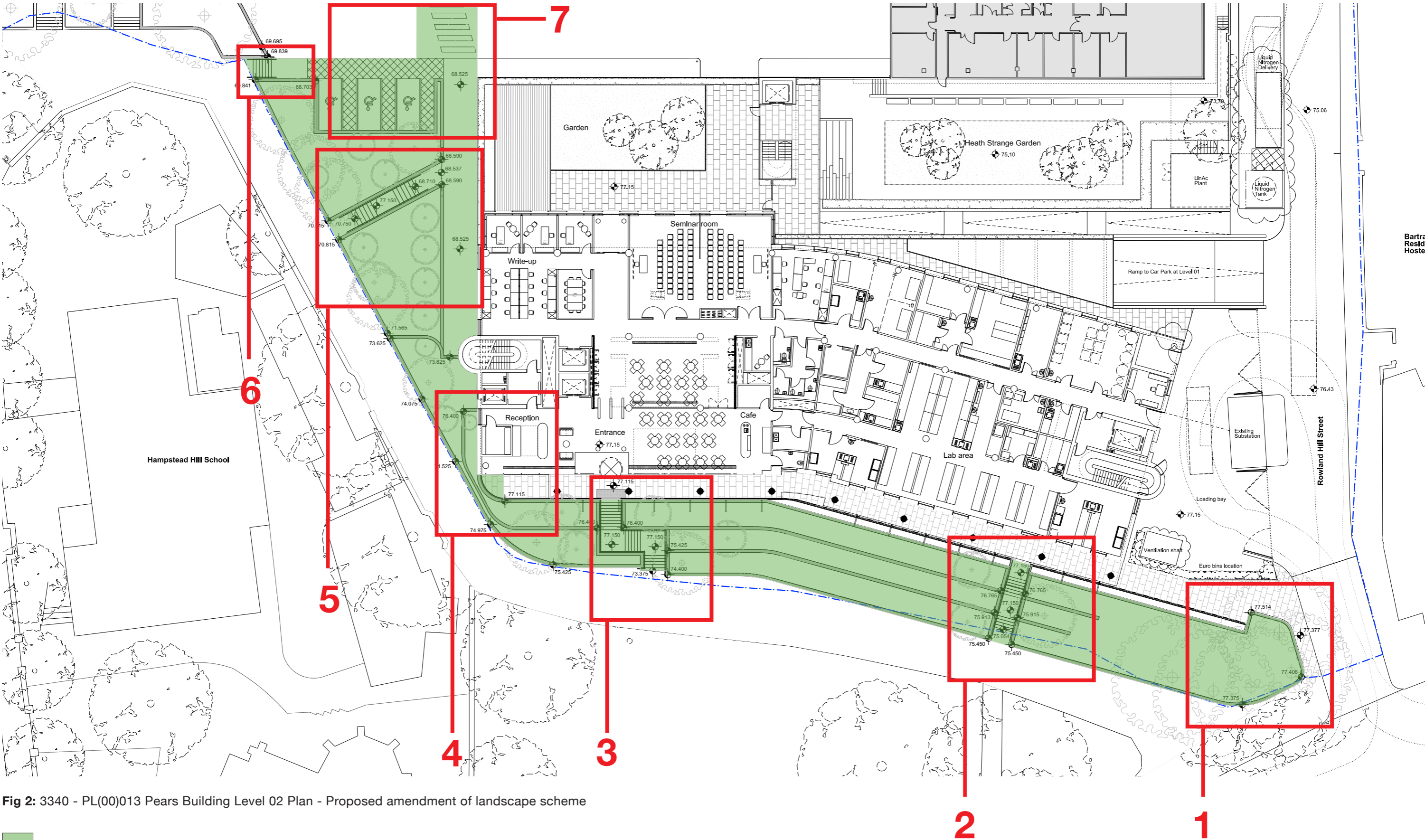

Fig 2: 3340 - PL(00)013 Pears Building Level 02 Plan - Proposed amendment of landscape scheme

Scope of proposed landscape redesign

02 Landscape Redesign: Proposal Overview

Proposed landscape redesign: Overview

(1) Section of low kerb to minimise disturbance to existing trees.

Note: low level brick wall has been discussed, but existing tree roots appear too close to the edge to allow for the construction of a wall.

(2) Stair pushed back to accommodate the reduced width of the proposed landscape / side walls removed.

(3) Shape of main entrance stair revised to accommodate the level change with the reduced width of the proposed landscape/ side walls removed.

Note: the new stair arrangement improves visibility of pedestrians coming around the corner and of people using the stair.

(4) North-West corner revised:

4.1 Retaining walls pushed back.

4.2 External hard-paved terrace stopped at the edge of the building (wrapped around the building before).

Note: changes required, in order to accommodate the reduced width of the proposed landscape.

4.3 Access to exterior from lift removed. Lift to open to the interior of the building instead.

4.4 Canopy removed, since there is no need for it, following the removal of the north section of the external terrace.

Note: changes dictated by the removal of the north section of the external hard-paved terrace.

4.5 Lowest retaining brick wall lowered by staggering at equal intervals.

(5) Staircase / Landscape and courtyard reconfigured

5.1 Staircase reconfigured to accommodate reduced width of the proposed landscape. Staircase relocated to align with the entrance of the Charity Offices.

5.2 Landscape pushed back to accommodate the reduced width of the proposed landscape.

5.3 North Courtyard removed and replaced with soft landscaping.

5.4 Path along the building retained.

(6) Staircase moved and made wider to align retaining wall with the car park spaces.

(7) Car park space and pedestrian crossing

7.1 One additional car park space added.

7.2 New pedestrian crossing proposed for the ambulance access route. Existing hard standing to be removed.

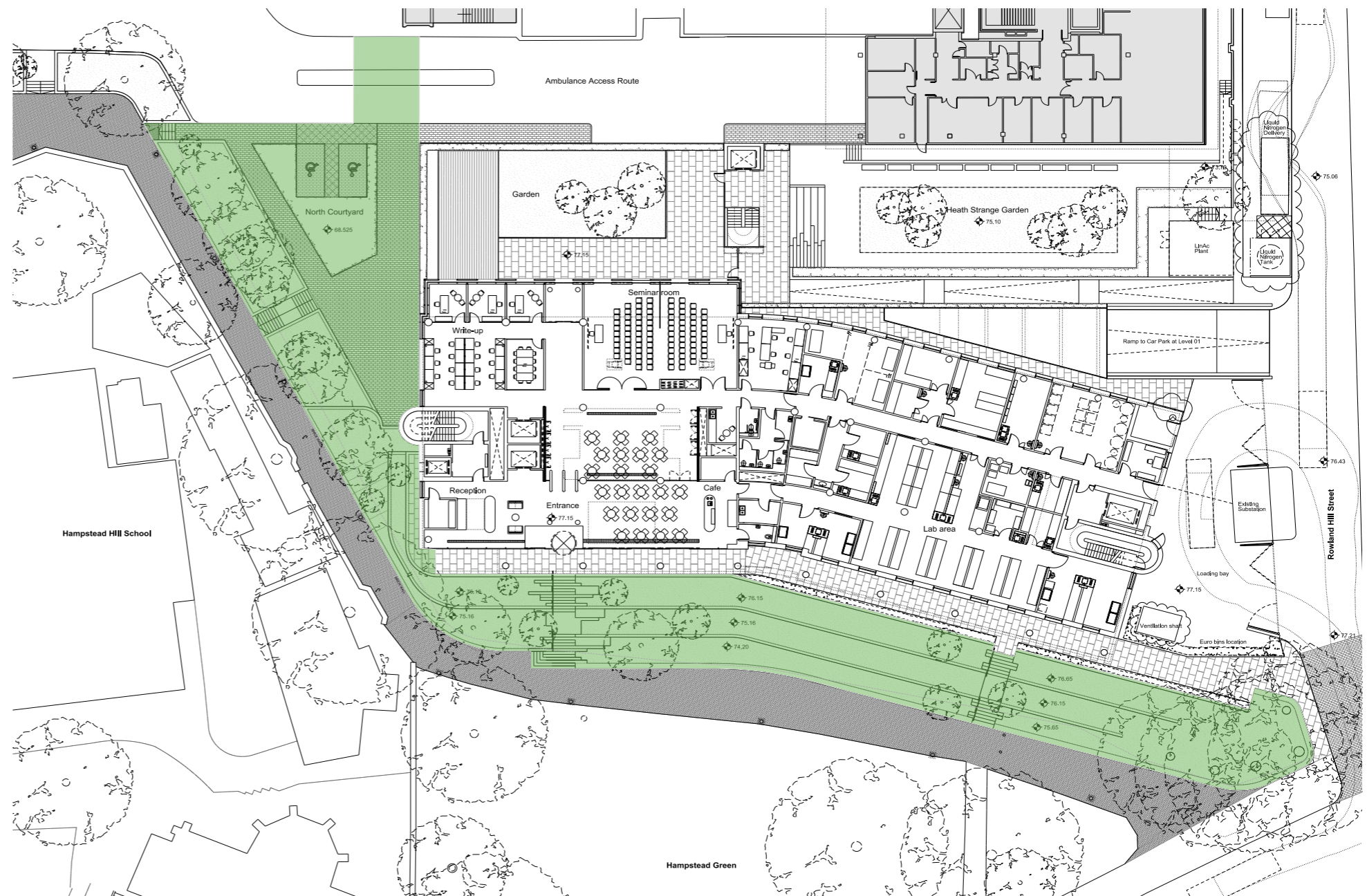

Fig 2.1 3340 - A-RFMR-2002-E-Pears Building Level 02 Plan - Consented landscape scheme (For Reference)

Scope of proposed landscape redesign

02 Landscape Redesign: Proposal Overview



Fig 2.2 Aerial View from the North-West

02 Landscape Redesign: Proposal Overview



Fig 2.3 Aerial View from the South-West