

Section Through Proposed Stepped Access To 100 Avenue Road
Scale: 1:20 at A1

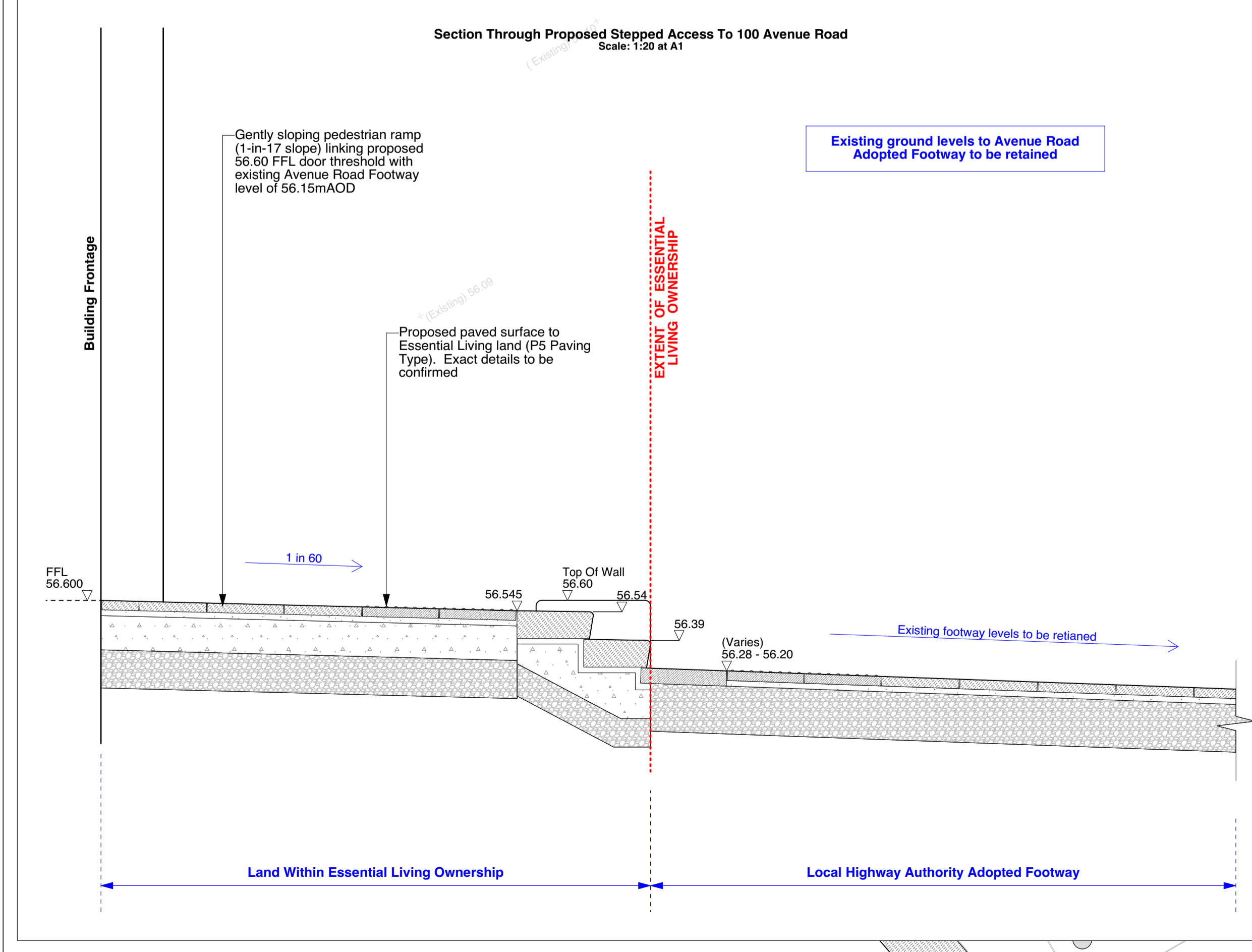

Step arrangement at interface with Avenue Road Footway to link 56.60m FFL proposed door threshold and existing Avenue Road Footway levels of 56.28 - 56.20m AOD

Gently sloping pedestrian ramp (1-in-17 slope) linking proposed 56.60 FFL door threshold with existing Avenue Road Footway level of 56.15m AOD

- NOTES**
1. All dimensions in millimetres unless otherwise shown.
 2. All levels in metres above Ordnance Datum (m AOD) unless reported to Employer
 3. All dimensions to be checked on site and any discrepancies reported to Employer before pricing / work starts.
 4. Any ambiguities or discrepancies within this drawing and any other information given elsewhere must be reported to Camlins and the Employer for clarification before pricing work proceeds.
 5. All drawings to be read in conjunction with other Camlins drawings and specification information as appropriate.
 6. Refer to relevant Engineer's and Architect's information as appropriate for confirmation of all engineering and architectural details.
 7. All works to be carried out in accordance with the latest British Standards and appropriate codes of practice as a minimum.

LOCAL HIGHWAY AUTHORITY APPROVAL
Exact details of reinstatement to Avenue Road Adopted Highway Footway where affected by the works to be agreed with Local Highway Authority and Transport For London.

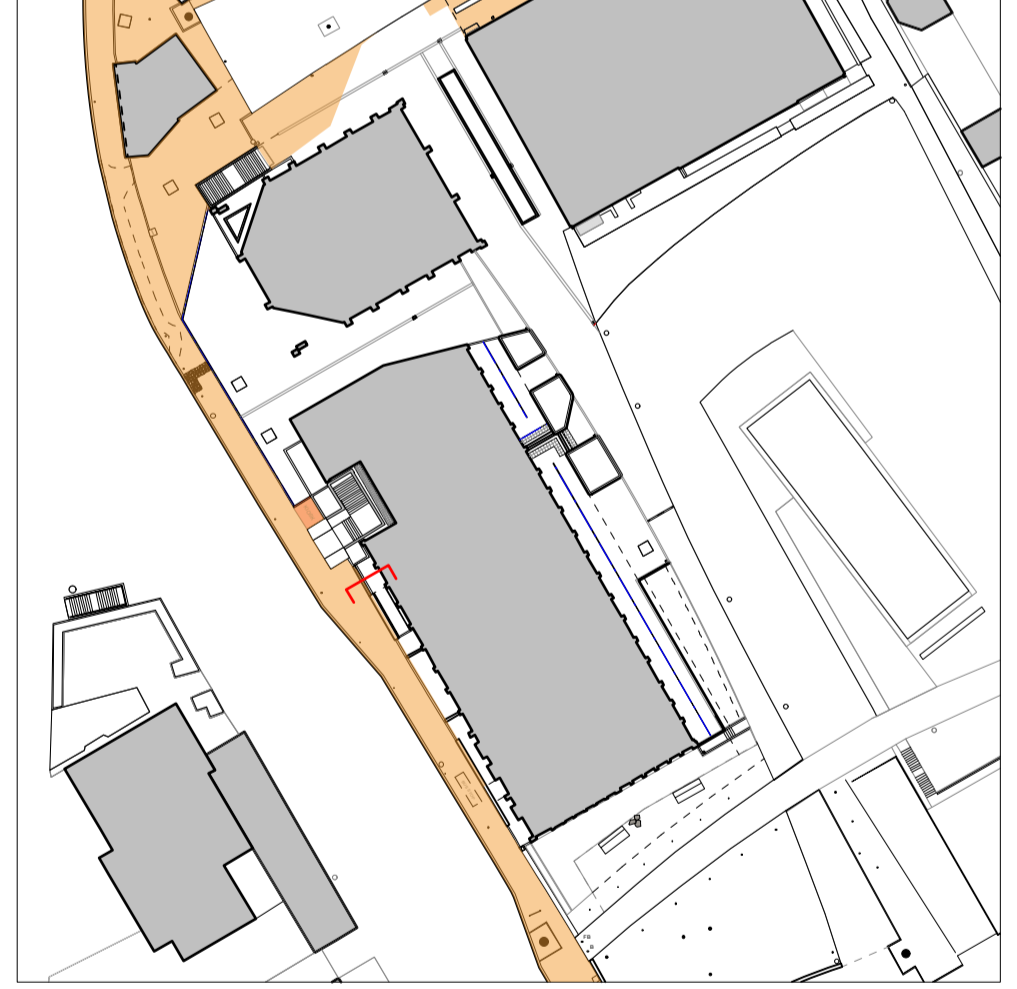

Rev.	Date	Description	Revised by	Checked by

Camlins
New Dolanog House, Severn Road, Welshpool, Powys, SY21 7AR
01928 554896
www.camlins.com

100 Avenue Road, London
Essential Living
Section C - Condition 4 Levels At Highway Boundary

Status Planning	Drawn by JS	Checked by DWJ
Drawing Number LL443-150-0025	Revision -	Scale 1:20@A1
	Date 21.07.2017	

Camlins Ref: LONDON GENERAL LL43 SWISS COTTAGE Camlins WorkDrawings LL43-150 PLANNING CONDITION DISCHARGE