

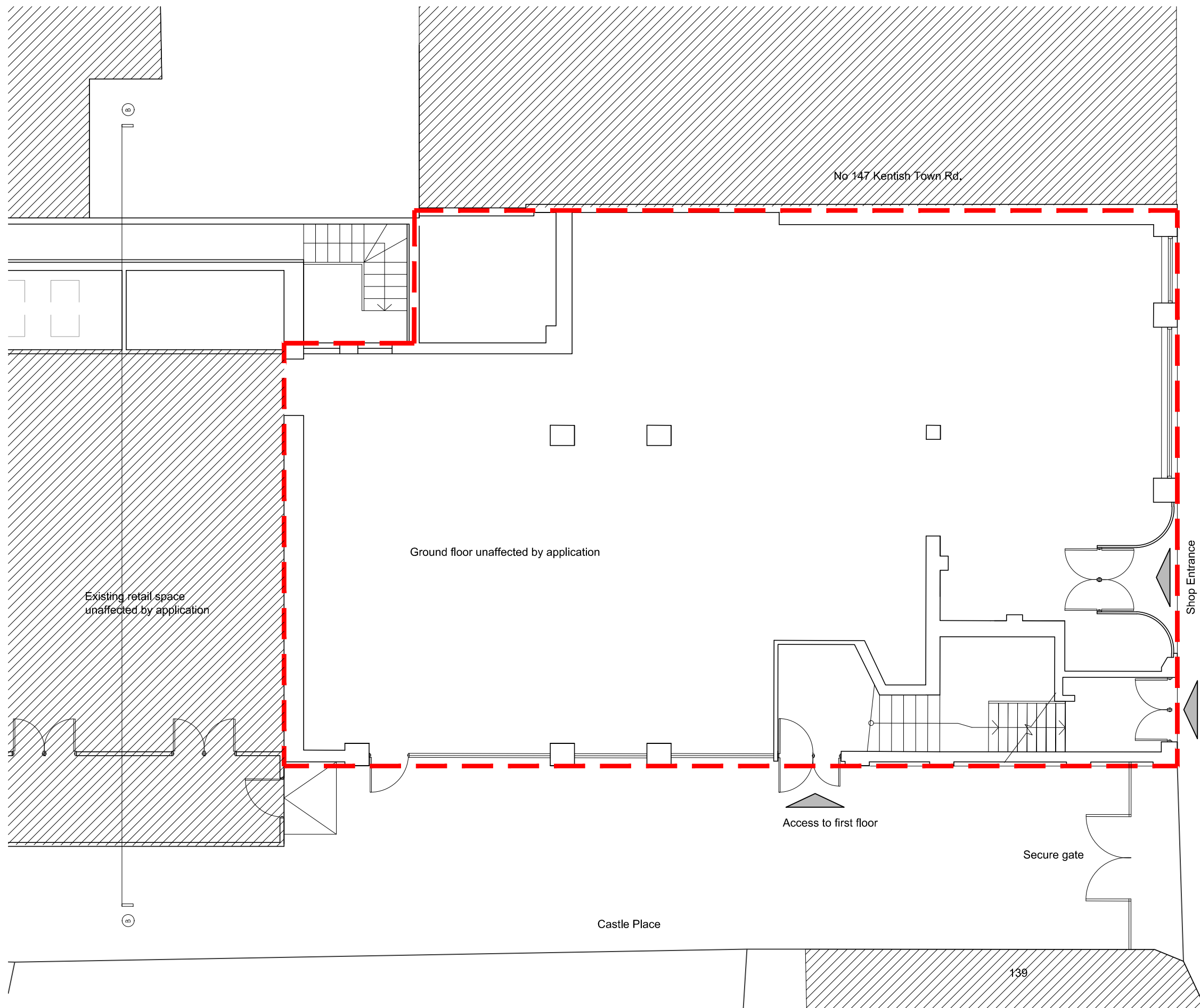

- General Notes:
1. Copyright of this drawing remains the sole property of Cooley Architects unless otherwise assigned in writing.
 2. Figured dimensions are to be worked in all cases with any discrepancies reported to the Architect prior to commencement of any work.
 3. Setting-out is based on outline survey only. All dimensions to be checked on site prior to construction/ordering.
 4. All dimensions are to edge/centre of structural element of wall or to grid-line, unless noted. If unclear consult Cooley Architects.



**NOT FOR
CONSTRUCTION**

REV	BY	DESCRIPTION	CKD	DATE

Cooley | Architects

123 Aldersgate Street London EC1A 4JQ
t: 020 3176 4481 www.cooleyarchitects.com

CLIENT

Montdore Investments Ltd.
PROJECT
141-145 Kentish Town Road
London NW1 8PB

DRAWING TITLE

Existing Ground Floor Plan

DRAWN BY	DATE	CHECKED
HQ	May 17	GH
SCALE	SIZE	STATUS
1:100	A3	Planning

DRAWING No	REV
892 - EX - 00 01	-