

SCALE BAR 1:1250

Site address

3 Hollycroft Avenue
London NW3 7QG

Client

Mr Neill Brennan

Title

Location Plan

Drawn

ADA_ALC

Scale

1:1250 (on A3)

Drawing No.

LP - 01 - REV

Date

20.06.16

Atelier ADA

36 Gloucester Avenue
NW1 7BB
London

Atelier ADA
M: +44 (0) 789 4229383
E: anna.adadesign@gmail.com

© This drawing is the property of Atelier ADA Ltd.
No disclosure or copy of it may be made without the written permission of Atelier ADA Ltd.

- Do not scale this drawing.
- All dimensions and levels to be checked on site.

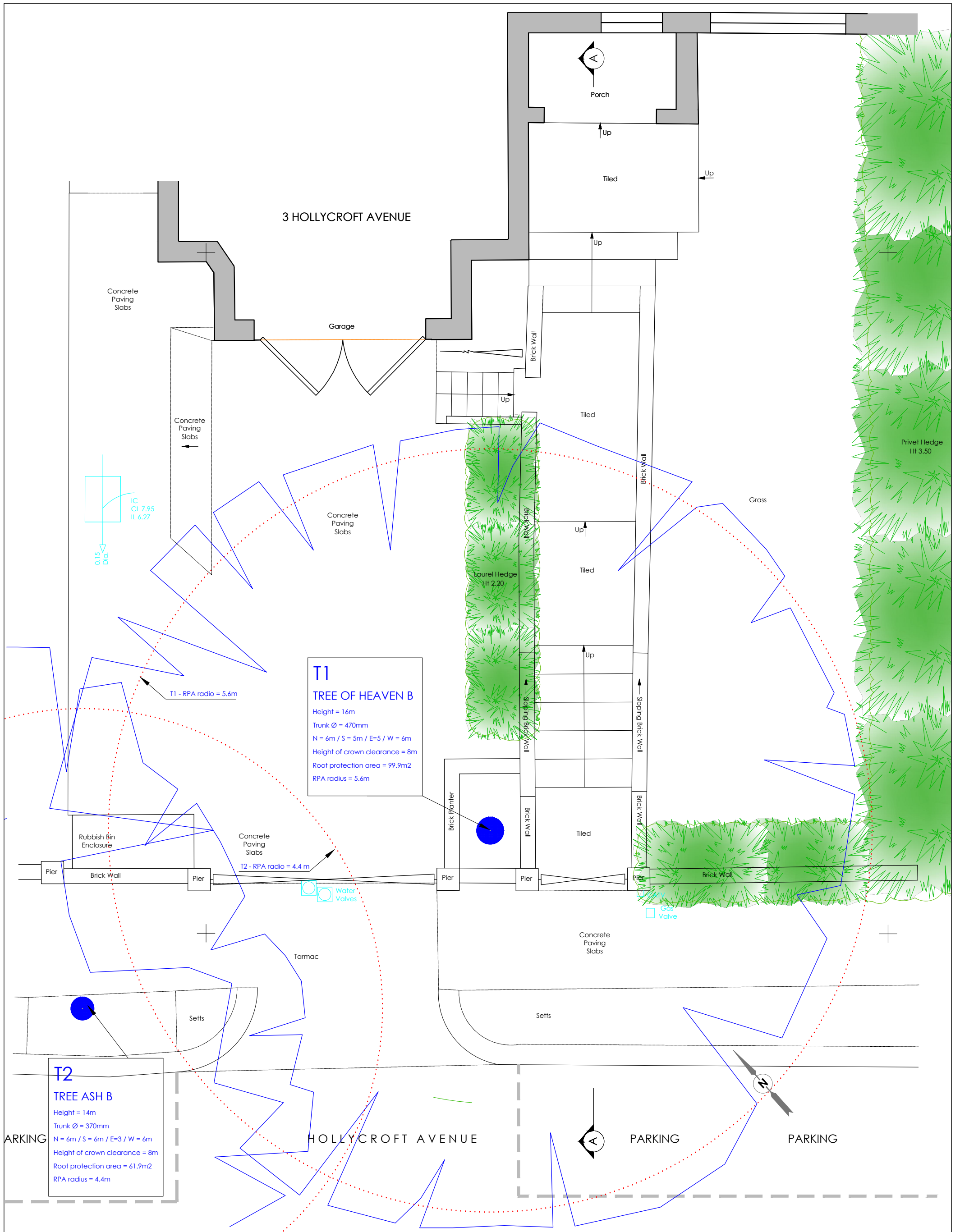

3 HOLLYCROFT AVENUE

T1
TREE OF HEAVEN B
Height = 16m
Trunk Ø = 470mm
N = 6m / S = 5m / E=5 / W = 6m
Height of crown clearance = 8m
Root protection area = 99.9m²
RPA radius = 5.6m

T2
TREE ASH B
Height = 14m
Trunk Ø = 370mm
N = 6m / S = 6m / E=3 / W = 6m
Height of crown clearance = 8m
Root protection area = 61.9m²
RPA radius = 4.4m



Site address	3 Hollycroft Avenue London NW3 7QG
Client	Mr Neill Brennan
Title	Existing Plan
Drawn	ADA_ALC
Scale	1:50 (on A3)
Drawing No.	EX 01 - REV B
Date	20.01.17

Atelier ADA
36 Gloucester Avenue
NW1 7BB
London
Atelier ADA
M: +44 (0) 789 4229383
E: anna.adadesign@gmail.com

© This drawing is the property of Atelier ADA Ltd.
No disclosure or copy of it may be made without the written permission of Atelier ADA Ltd.
- Do not scale this drawing.
- All dimensions and levels to be checked on site.

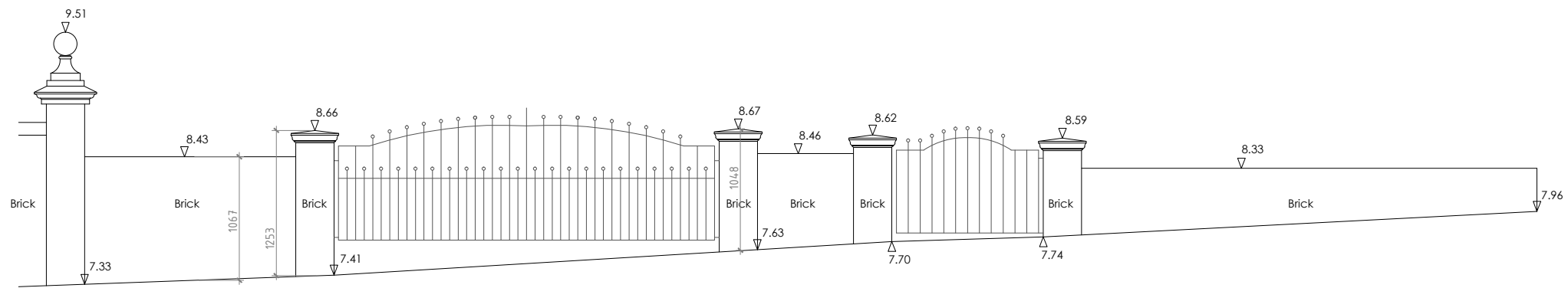

Front Elevation

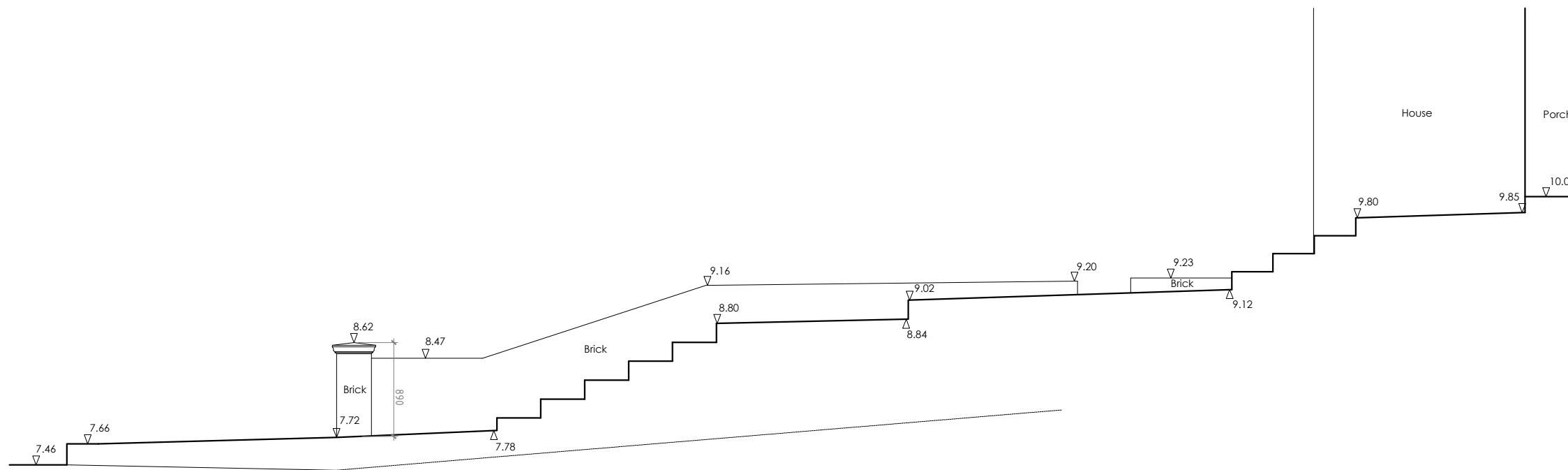

Section AA

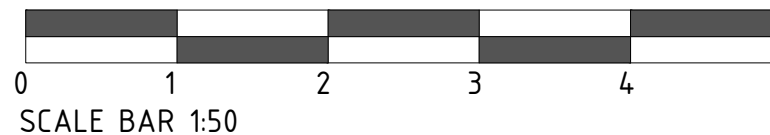

Site address	3 Hollycroft Avenue London NW3 7QG	Atelier ADA 36 Gloucester Avenue NW1 7BB London
Client	Mr Neill Brennan	
Title	Existing Front Elevation & Section AA	Atelier ADA M: +44 (0) 789 4229383 E: anna.adadesign@gmail.com
Drawn	ADA _ ALC	© This drawing is the property of Atelier ADA Ltd. No disclosure or copy of it may be made without the written permission of Atelier ADA Ltd.
Scale	1:50 (on A3)	- Do not scale this drawing. - All dimensions and levels to be checked on site.
Drawing No.	EX- 02 - REV	
Date	20.06.16	