

TREE SURVEY 'KEY' - BRITISH STANDARD 5837:2012 'TREES IN RELATION TO DESIGN, DEMOLITION & CONSTRUCTION - RECOMMENDATIONS'

FIELD KEY:

TPO/CA	-	On client request: presence of Tree Preservation Orders (TPO) / site location within a Conservation Area (CA) & date checked;
TREE REF. #	-	Tree reference number: tag or plan number (T - individual tree, G - group of trees/shrubs, H - hedge);
SPECIES	-	Genus, species and/or common name;
AGE	-	Age classification (NP - new planting, Y - young, EM - Early-Mature, SM - semi mature, M - mature, LM - late mature, OM - over mature);
HEIGHT (in m)	-	Approximate height of tree in metres;
CANOPY (in m) N - S - E - W	-	Approximate branch spread in metres of the four principal compass points;
STEM (in mm)	-	Stem diameter in millimetres: measured in accordance with s.4.6 of BS5837;
RPA (in m)	-	Circle radius of the Root Protection Area: calculated using the stem diameter (single/multiple stem variant, as outlined within BS5837);
CLEARANCE (in m)	-	Crown clearance in metres above the adjacent ground level;
IST BRANCH (in m)	-	Clearance in metres to first significant branch and direction of growth (where relevant);
VITALITY	-	Physiological condition typically gauged from canopy cover and annual extension growth (good, fair, poor, dead);
ESTIMATED REMAINING CONTRIBUTION	-	Approximate number of years the tree will continue to make a contribution without the need for oppressive arboricultural intervention, categorised in years as <10, 10-20, 20-40 and >40;
NOTES	-	Structural and physiological condition observations;
BS CAT.	-	BS5837 tree quality assessment category: resulting from structural/physiological condition and remaining contribution (approximate Standard retention category U : in such a condition that any existing value would be lost within 10 years; Standard retention category A : high quality and value, in such a condition as to be able to make substantial contribution of 40+ years; Standard retention category B : moderate quality and value, in such a condition as to make a significant contribution of 20+ years; Standard retention category C : low quality and value, currently in adequate condition to remain until new planting could be established Standard retention sub-category, mainly due to: 1 - Arboricultural values, 2 - Landscape values, 3 - Cultural values, including conservation;
MANAGEMENT	-	Preliminary management recommendations (as appropriate);
' * '	-	Within the survey schedule denotes an estimate

TREE SURVEY IN ACCORDANCE WITH BRITISH STANDARD 5837:2012 'TREES IN RELATION TO DESIGN, DEMOLITION & CONSTRUCTION - RECOMMENDATIONS'

CLIENT: Mr Dan Wagner

PROJECT REF: 13891/A3

SITE: 15 Wedderburn Road, London, NW3 5QS

CONTACT: Clive Sall Architects

SURVEY DATE: 24-July-2013 & 01-Dec-2016

ARB CONSULTANT: Andrew Turnbull FDSc MArborA

TREE REF. #	SPECIES	AGE	HEIGHT (in m)	CANOPY (in m) N - S - E - W				STEM (in mm)	RPA (in m)	CLEARANCE (in m)	1st BRANCH (in m)	VITALITY	LIFE EXPEC.	NOTES	BS CAT.	MANAGEMENT
T1	Apple; <i>Malus</i> , <i>Rosaceae</i>	M / LM	9	4.5	4.5	3	5	360	4.3	2	1.5m - union	Normal	10 - 20	Established free, good crop cover, maintained by pollard. Multiple stem at 1.5m+ with good regrowth but starting to encroach building. Only visible in garden.	C 3	
G1	Mixed Border (Laurel, Choisya, Ivy, Apple Blossom, Pyracantha)	SM - M	5 - 7	/	/	/	/	/	/	0	/	Fair	10 - 20	Mixed shrub border pruned laterally to encourage height and screening. Located in retaining wall border and around raised patio.	C 3	
T2	Laurel; <i>Laurus</i> , <i>Lauraceae</i>	SM	5.5	3	1	2	1	130	1.6	1	/	Fair	10 - 20	Lapsed planting, likely for formal cover but height encouraged for screen, collective growth.	C 2	Consider removal in conjunction with a scheme for the site's development.
T3	Cherry; <i>Prunus</i> , <i>Rosaceae</i>	M	5	0.5	1	2	0	260	3.1	1.5	/	Very Poor	< 10	Almost dead.	U	Removal recommended for H&S tree risk management.
T4	Laurel; <i>Laurus</i> , <i>Lauraceae</i>	M	6	2	2	2	1.5	190	2.3	1	/	Fair	10 - 20	Lapsed planting, likely for formal cover but height encouraged for screen, collective growth. Dieback in crown.	C 2	Consider removal in conjunction with a scheme for the site's development.
T5	<i>Cotoneaster</i> , <i>Rosaceae</i>	SM / M	8	2.5	3	2.5	3	120	1.4	0	/	Fair	10 - 20	Lapsed planting, likely for formal cover but height encouraged for screen, collective growth. Multiple stem base.	C 2	Consider removal in conjunction with a scheme for the site's development.
G2	Mixed Shrub Border (Laurel, Cotoneaster, Ivy, Virginia Creeper)	SM / M	5 - 8	/	/	/	/	/	/	0	/	Fair	10 - 20	Contains T2 - T5, collective canopy, informal provides screening and blends with Ivy covered wall.	C 3	Consider removal in conjunction with a scheme for the site's development.
T6	Crab Apple; <i>Malus</i> , <i>Rosaceae</i>	LM	9.5	4	6	5	7	450	5.4	2.5	2m - union	Normal	10 - 20	Multiple stem at 2m, growing with paved RPA close to wall and house. Slight balcony overhang, multiple stem crown with some branch conflicts. Decay at old pruning points just above multiple stem union, previously reduced.	B 3	20% crown reduction to manage canopy sail.
G3	Cypress x3	Y / SM	4 - 5	/	/	/	/	/	/	1	/	Fair	10 - 20	3x small stems grow as collective and provide buffer to wall and screening. Limited future contribution.	C 2	
T7	<i>Cotoneaster</i> , <i>Rosaceae</i>	M	10	4.5	3	5	2.5	184	2.2	1.5	/	Fair	10 - 20	Co-dominant at 0.5-1.0m, congested crown from reaction growth, growth lean and low quality form. (Multiple stems measured 140mm and 180mm).	C 2	Prune to balance and shape crown (20% reduction).
T8	Cherry; <i>Prunus</i> , <i>Rosaceae</i>	M / LM	14	4.5	4.5	4	3.5	334	4.0	4	6m - North	Fair	20 - 40	Co-dominant base, located in shrub border. Previous branch reduction noted in parts, sparse crown and stem scarring on largest stem. (Multiple stem 210mm and 260mm).	B 2	Monitor tree's condition.
T9	Cherry; <i>Prunus</i> , <i>Rosaceae</i>	M / LM	6.5	0.5	4.5	1	4	250	3.0	2.5	2m - S.West	Fair	10 - 20	Multiple stem at 2m, maintained by pollard with average form and regrowth. Suppressed by T8.	C 2	
T10	Cockspur Thorn; <i>Crataegus</i> , <i>Rosaceae</i>	M	8	2.5	2.5	3.5	3	170	2.0	1.5	1.5	Normal	10 - 20	Multiple stem crown, fairly congested from regrowth after crown reduction.	C 3	
T11	Ornamental Cherry; <i>Prunus</i> , <i>Rosaceae</i>	SM	6.5	2.5	2	2	1.5	80	1.0	1.5	1.5	Normal	10 - 20	Multiple stem crown, established, fair form and small scale.	C 3	
T12	Mespil; <i>Amelanchier</i> , <i>Rosaceae</i>	SM	9	2	2.5	2	1.5	80	1.0	1	1	Normal	10 - 20	Multiple stem stock at base, located in planter with good form and canopy cover, small scale.	C 3	
T13	Crab Apple; <i>Malus</i> , <i>Rosaceae</i>	M	9	3.5	4	3.5	3.5	200	2.4	3.5	3.5	Normal	10 - 20	Central to block paved driveway, co-dominant at 3-5m with good form and canopy cover from growth at base.	C 3	
T14	Golden Chain; <i>Laburnum</i> , <i>Fabaceae</i>	SM / M	4.5	1	3	1.5	2	160	1.9	1.5	2.5m - N.East	Fair	< 10	Growing in confined conditions, suppressed by T13.	U	
T15	Street Tree: Lime; <i>Tilia</i> , <i>Tiliaceae</i>	Y	8	2	2.5	2	2	150	1.8	2.5	2.5	Normal	40 +	Established young street planting with stem damage and stub at 2.0-2.5m.	C / 3	Local Authority managed.
T16	Street Tree: Lime; <i>Tilia</i> , <i>Tiliaceae</i>	M	18	5	4	4.5	4	630	7.6	2.5	6m - South	Normal	40 +	Multiple stem at 3.5m, maintained by pollard, good canopy form and leaf cover.	A 2	Local Authority managed.
T17	Street Tree: Lime; <i>Tilia</i> , <i>Tiliaceae</i>	M	20	6	5	6	4.5	590	7.1	2.5	6m - union	Normal	40 +	Multiple stem at 5-6m, maintained by pollard, good canopy form and leaf cover.	A 2	Local Authority managed.
T18	Sycamore; <i>Acer</i> , <i>Aceraceae</i>	SM / M	16	5.5	5	5	5.5	520	6.2	4	5m - union	Normal	40 +	Multiple stem at 6-7m, maintained by pollard, recently pollarded with no current regrowth, tears and rubs of cambial layer from pruning points.	A 2	Local Authority managed.

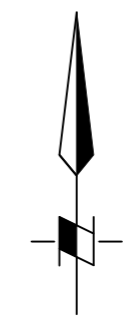

KEY

- Tree Crown Spread
- Root Protection Area (RPA)
- Tree Stem
- T1 Tree No.

Tree Condition Category

- A
- B
- C
- U

The surveyed trees are illustrated on this Constraints Plan which is prepared in accordance with British Standard BS5837: 2012 'Trees in Relation to Design, Demolition and Construction - Recommendations'

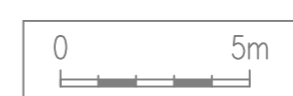
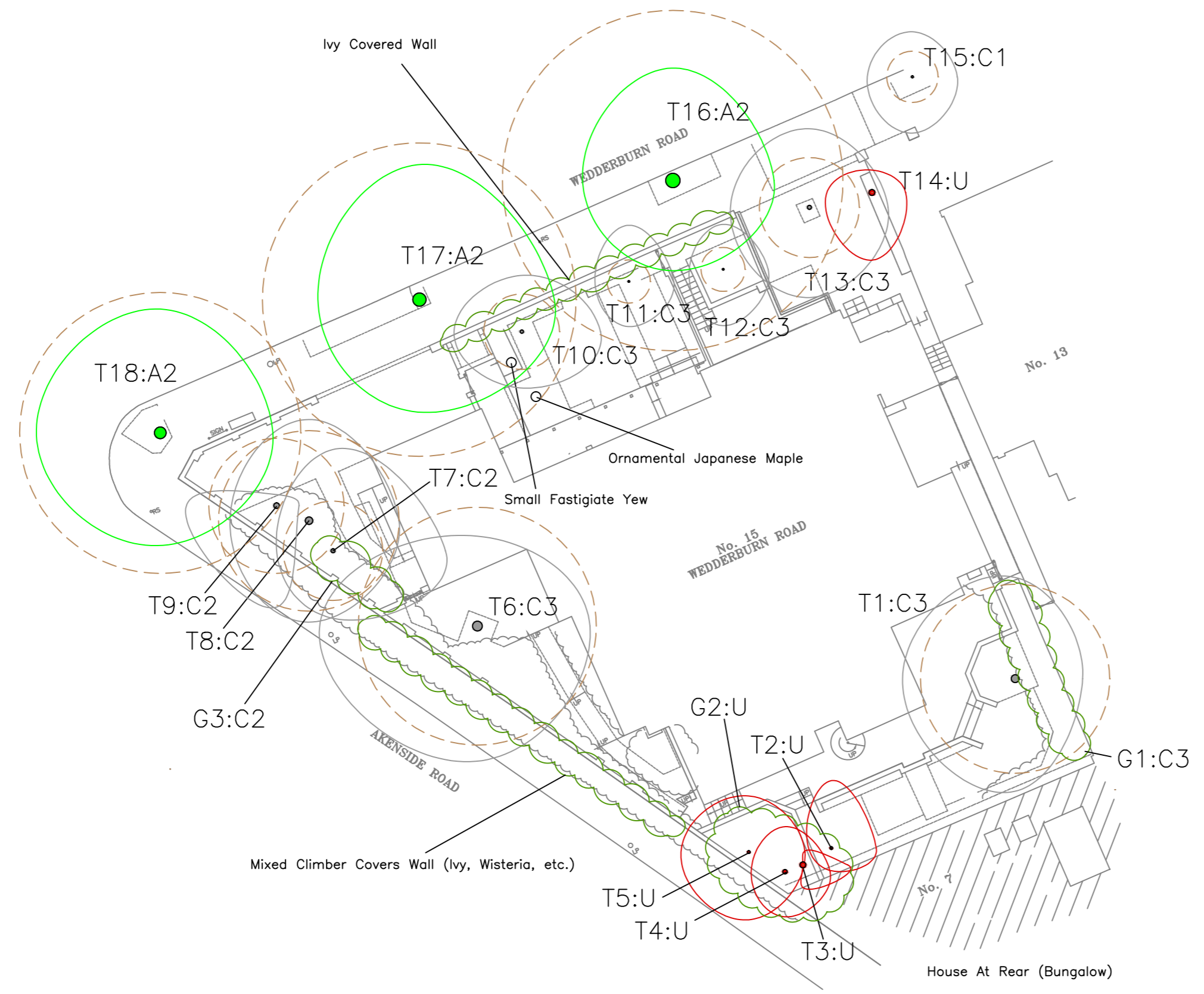

DO NOT SCALE FROM DRAWING
 The original of this drawing was produced in colour – a monochrome copy should not be relied upon.

REV.	DESCRIPTION	DWN	CHK'D	DATE
------	-------------	-----	-------	------

CLIENT
 Mr Dan Wagner

PROJECT
 13891
 15 Weddersburn Road,
 London, NW3 5QS

TITLE
 Tree Constraints Plan

DWN	DATE	CHK'D	DATE	APP'D	DATE	SCALE
RCK	26/07/2013	AE	28/07/2013			1:200



(Mail) 7 Greenbank, Hoole, Chester, CH2 3RW
 Telephone: 0333 123 7080 www.indigosurveys.co.uk

Drawing Number
 13891/TCP/01

THIS DRAWING IS CONFIDENTIAL AND MUST NOT BE REPRODUCED WITHOUT THE CONSENT OF INDIGO SURVEYS LTD.

A2
 REV.