

USE KEY

- A3 (restaurant)**
AREA: 0m²
- A1 (retail)**
AREA: 311m²
- B1c (light industrial)**
AREA: 0m²
- B1c (jewellery)**
AREA: 311m²
- B1 (business)**
AREA: 210m²

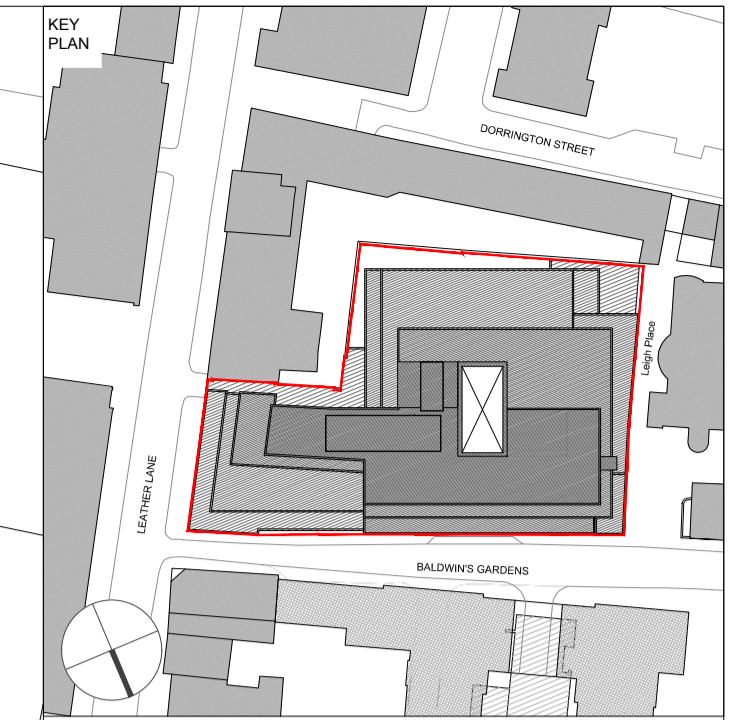

WORKSPACE
 Chester House
 Kennington Park
 Business Centre
 1-3 Brixton Road
 London SW9 6DE
 Phone: 0845 564 1216
 Fax: 020 7247 0157

DO NOT SCALE FROM THIS DRAWING.
 THIS DRAWING IS BASED ON DIMENSIONAL SURVEY INFORMATION PROVIDED BY OTHERS. THE ARCHITECT CANNOT ACCEPT RESPONSIBILITY FOR THE ACCURACY OF THIS SURVEY INFORMATION.
 ALL DIMENSIONS ARE SHOWN IN METRIC.
 THIS DRAWING REMAINS THE COPYRIGHT OF KARAKUSEVIC CARSON ARCHITECTS.

NOTES

Rev	Reason for issue	Date
02	Hatching & use key amended	02.02.2017
01	Hatching amended, use key amended, scale bar added	03.05.2016

karakusevic carson architects
 The Gymnasium
 56 Kingsway Place, Sans Walk
 London EC1R 0LU
 Tel: +44 207 566 6300
 Fax: +44 207 566 7381
 Email: mail@karakusevic-carson.com

PROJECT
Hatton Square
 London Borough of Camden
 London

TITLE
Existing
Ground Floor Plan

DRAWING NUMBER
203_A_P_110_01

STATUS
PLANNING

DATE	DRAWN BY	SCALE
14/03/2016	TB	1/100 @ A1
PLOT DATE	CHECKED BY	PROJECT NUMBER
02/02/2017	TB/KS	203

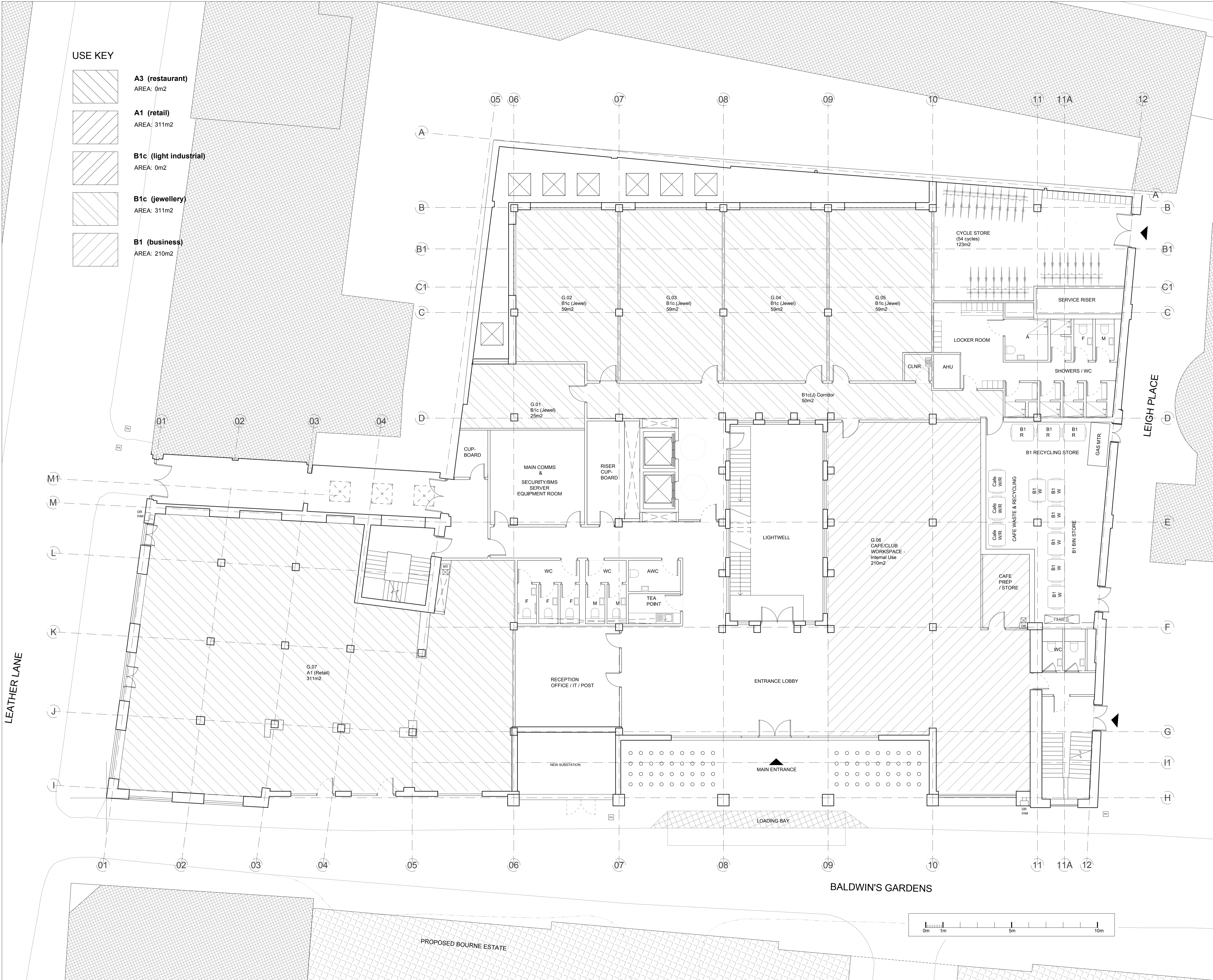

LEATHER LANE

LEIGH PLACE

BALDWIN'S GARDENS

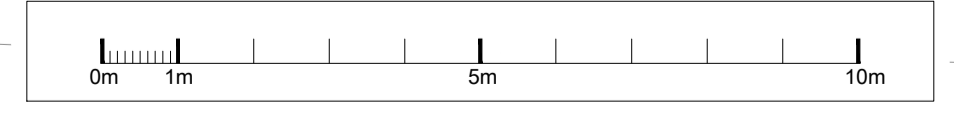

PROPOSED BOURNE ESTATE